



Elms Crescent, SW4

£550,000

A superb ground-floor apartment located within a sought-after mansion block in the heart of the Abbeville Village. The accommodation has been thoughtfully arranged to balance living with entertaining space flawlessly. Comprising a spacious reception room with a large bay window and recessed alcoves, a well-equipped kitchen/breakfast room, two double bedrooms and a bathroom. Being on the ground floor, the property benefits from direct access to the large communal garden.

Elms Crescent is a tree lined street moments from the many local shops, restaurants and cafés of Abbeville Village, with Clapham South & Common stations, along with the common itself just a short stroll away.

Features

- Mansion Apartment
- Large Reception Room
- Separate Kitchen
- Two Bedrooms
- Communal Garden
- Permit Parking

Elms Crescent, London, SW4

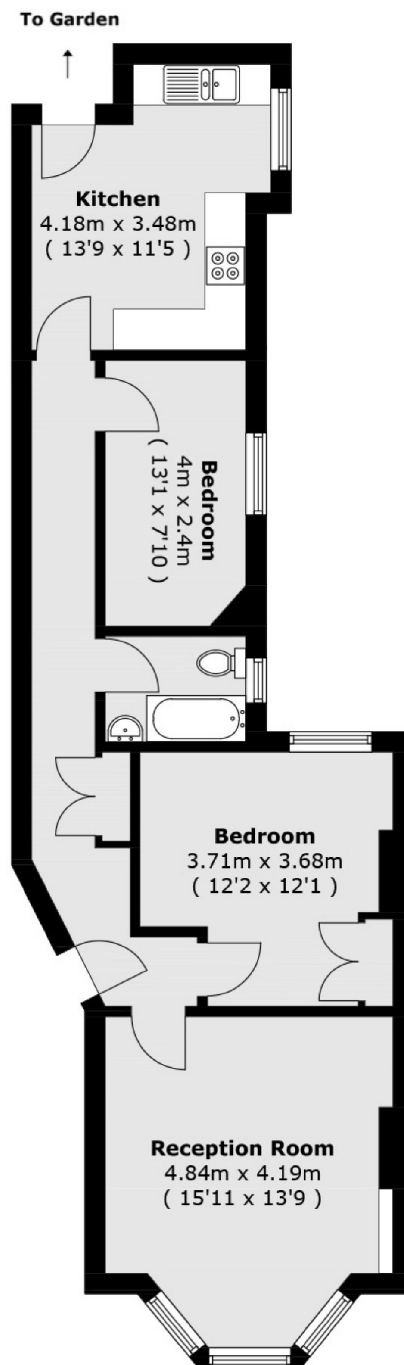

Total area (approx.): 67.6 sq. m (727.6 sq. ft)

Dexters

Clapham Sales
28 Abbeville Road
London
SW4 9NG
Sales
020 8742 4140

Energy Rating: C. We aim to make our particulars both accurate and reliable. However they are not guaranteed; nor do they form part of an offer or contract. If you require clarification on any points then please contact us, especially if you're traveling some distance to view. Please note that appliances and heating systems have not been tested and therefore no warranties can be given as to their good working order.

 **RICS** | Regulated
Estate Agent
and Letting Agent

[dexters.co.uk](https://www.dexters.co.uk)