



## Bedford Road, SW4

### £449,950

This contemporary apartment is situated within a highly desirable development in the centre of Clapham. The flawless accommodation comprises a large open-plan reception room with a modern kitchen and ample room to entertain, a double bedroom with fitted storage, a modern bathroom and a utility area off the hallway.

Greenaway Apartments is ideally located for the many shops, restaurants and bars of Clapham High Street & Clapham Old Town, along with Clapham North Underground (Northern Line) and Clapham Common.

### Features

- Modern Apartment
- Open Plan Reception
- Integrated Kitchen
- Double Bedroom
- Long Lease
- Superb Location

# Bedford Road, London, SW4

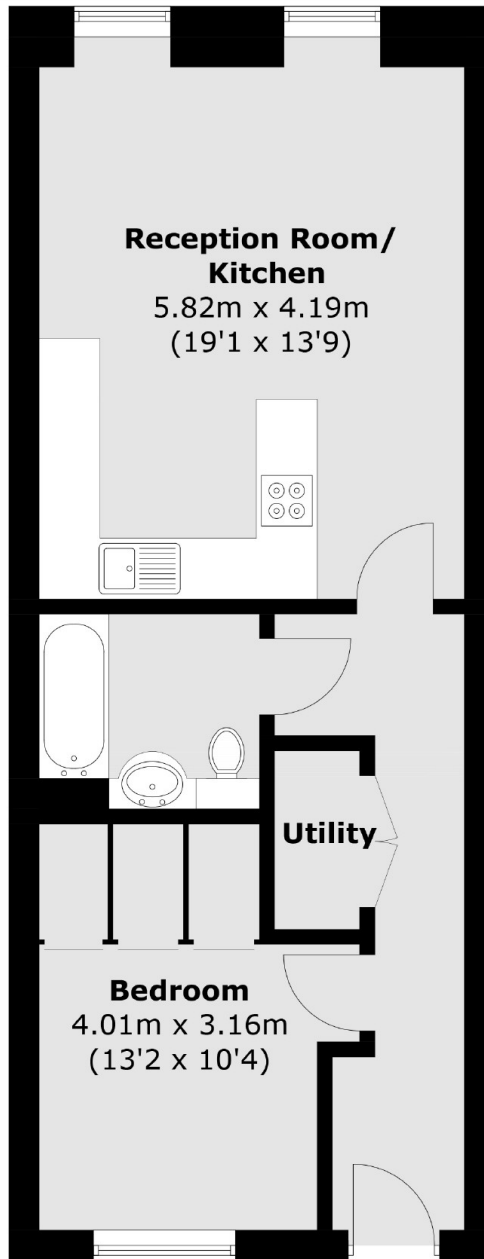

Total area (approx.): 49.3 sq. m (530.7 sq. ft)