



Elms Crescent, SW4

£1,899,000

Dexters



Elms Crescent, SW4

An exceptional, fully extended five-bedroom, two-bathroom freehold home providing over 2,000 sq.ft of elegantly arranged living and entertaining space over three floors with a south-east facing garden.

The double reception room is positioned to the right of the entrance hall, including a bay window with a window seat, bespoke alcove cabinetry and shelving, and original ceiling plasterwork. The kitchen is located at the back of the house and can be accessed from both the reception room and hallway, comprising a wide range of attractive wall and base units, a central island and ample room to dine. Bi-folding doors open onto a low-maintenance garden with mature perennial borders. The cellar has been converted into a useful utility room. Over the first and second floors, there are five double bedrooms and two bathrooms. This includes a large principal bedroom naturally positioned at the front of the house with fitted wardrobes.

Elms Crescent is situated within the Abbeville Village, a highly desirable area renowned for its array of shops, restaurants and bars. The property falls within the catchment of Bonneville State Primary School, rated Ofsted outstanding, and is within a short walk of Clapham Common and its respective Underground Station (Northern Line).

Features

- Freehold
- Double Reception Room
- Extended Kitchen
- Five Bedrooms
- Utility Room
- Chain Free







Elms Crescent, London, SW4

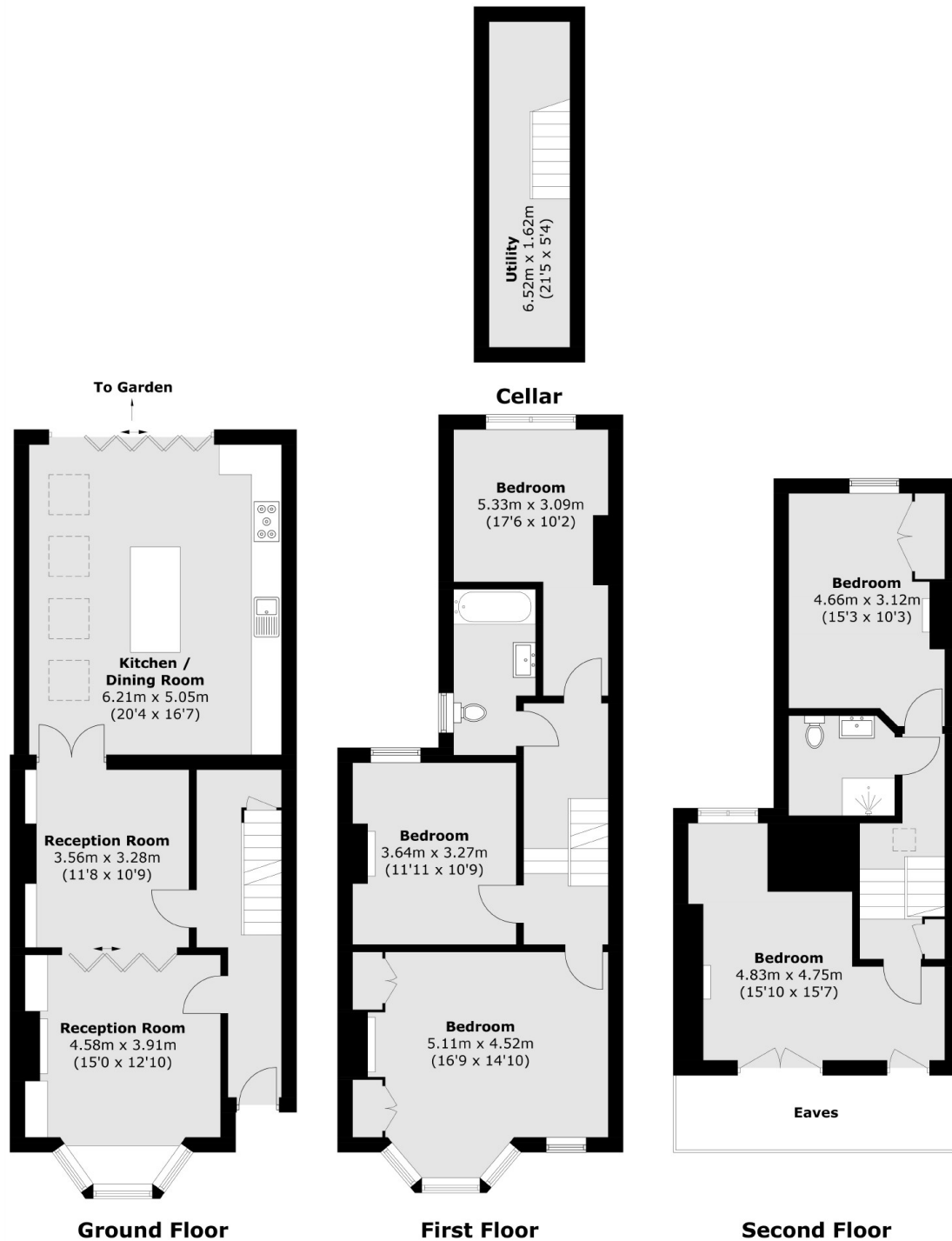

Total area (approx.): 187.4 sq. m (2,017.1 sq. ft)
(Including Cellar / Excluding Eaves)