



## Kings Avenue, SW4

£480,000

A bright and airy, first-floor lateral apartment situated within a private development which extends to an impressive 896 sq. Ft. Comprising a large reception room, a separate well-equipped kitchen, three double bedrooms and bathroom with independent toilet. The master bedroom overlooks the large, private communal garden with lawn, accessible only to residents. Offered to the market chain free and with a long lease.

Kings Avenue is located close to the popular Abbeville Village, and Clapham Common & Brixton shopping centres. Transport links are excellent with regular bus services (routes 137, 355, 417, N137) one minute's walk in both directions from the apartment. Thorncliffe Court is near to and equidistant from Clapham South and Clapham Common Tube Stations (Northern Line).

### Features

Lateral Apartment  
Reception Room  
Separate Kitchen  
Three Bedrooms  
Communal Garden  
Chain Free

# Kings Avenue, London, SW4

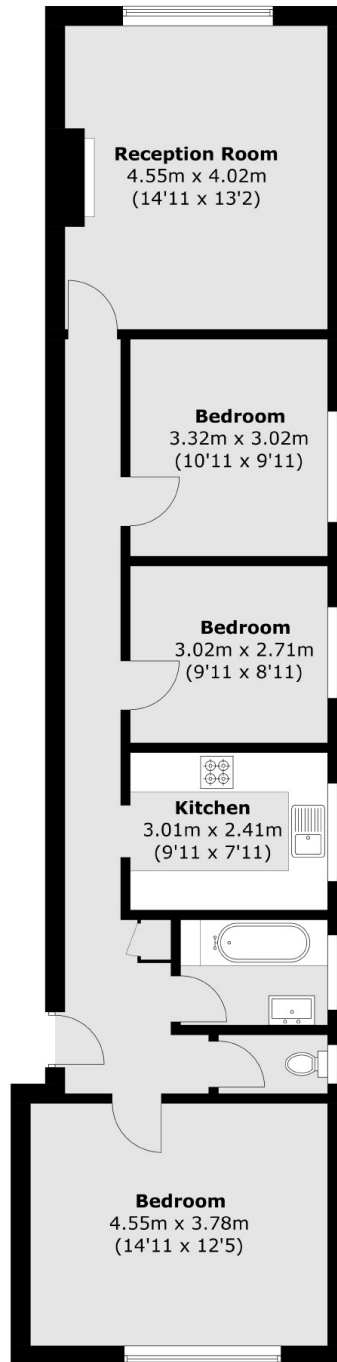

## First Floor

Total area (approx.): 83.3 sq. m (896.6 sq. ft)