



## Millbrook Road, SW9

£625,000

A charming split-level maisonette providing an abundance of balanced living and entertaining space over its impressive 967 sq.ft. The thoughtfully arranged accommodation includes a bright, forward-facing reception room with a bay window, an adjoining, well-equipped kitchen, three bedrooms, a bathroom and a further cloakroom.

Millbrook Road is a quiet street with a pleasant, open outlook over a park, located within walking distance of the sought-after bars and restaurants of central Brixton. The Victoria Line and Loughborough Junction are a short walk, providing swift access to Central London and The City.

### Features

- Split Level Maisonette
- Reception Room
- Well Equipped Kitchen
- Three Bedrooms
- Long Lease
- Superb Location

# Millbrook Road, London, SW9

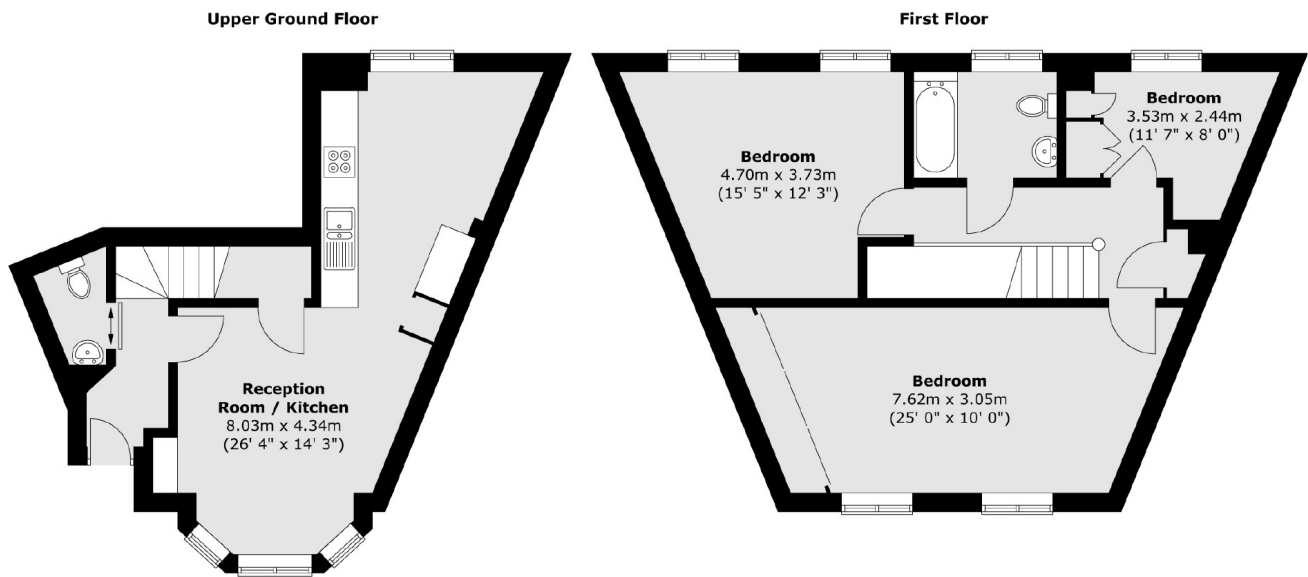

Total area (approx.) : 89.8 sq. m (967 sq. ft)