



Singer Mews, SW4

£400,000

A contemporary, fourth floor apartment located within a desirable, gated development. Comprising a large open plan reception room with a modern kitchen and adjoining balcony, a double bedroom with storage and a bathroom.

Singer Mews is located moments from the many shops, restaurants and cafés of Clapham Old Town & Clapham High Street. Clapham North & Stockwell Underground stations are a very short walk away.

Features

- Modern Apartment
- Open Plan Reception
- Integrated Kitchen
- Double Bedroom
- Balcony
- Chain Free

Singer Mews, London, SW4

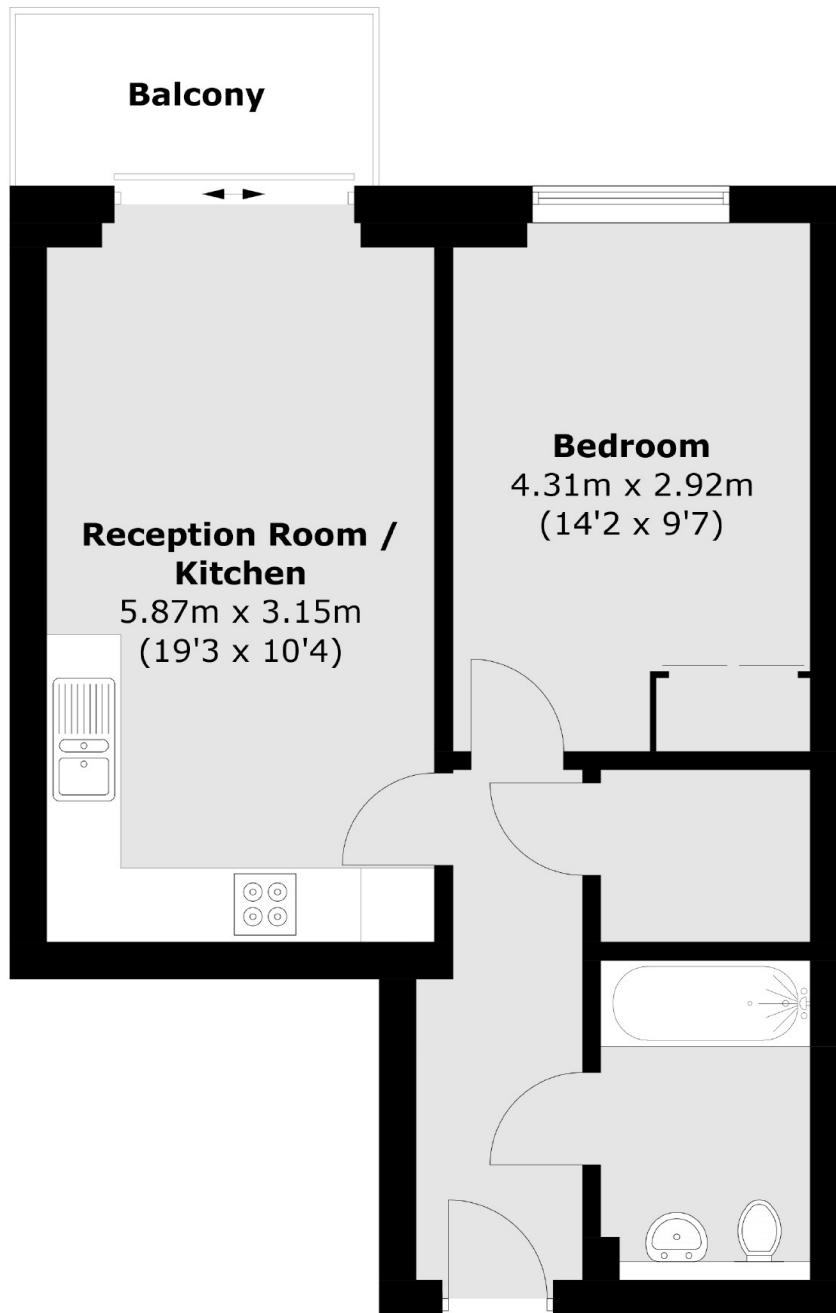

Total area (approx.): 45.4 sq. m (488.7 sq. ft)
Balcony: 4.1 sq. m (44.1 sq. ft)

Dexters

Clapham Sales
28 Abbeville Road
London
SW4 9NG
Sales
020 8742 4140

Energy Rating: B. We aim to make our particulars both accurate and reliable. However they are not guaranteed; nor do they form part of an offer or contract. If you require clarification on any points then please contact us, especially if you're traveling some distance to view. Please note that appliances and heating systems have not been tested and therefore no warranties can be given as to their good working order.

 **RICS** | Regulated
Estate Agent
and Letting Agent

dexters.co.uk