



Ballater Road, SW2

£500,000

A charming ground floor period conversion extending to 812 sq.ft with a private, west-facing garden. Having been thoughtfully arranged, the property comprises a bright and airy reception room with a bay window, an adjoining well-equipped kitchen with ample room to dine, a double bedroom, a bathroom and to the rear, a mature low-maintenance garden.

Ballater Road is located in a residential area nestled between Clapham and Brixton and is within easy reach of many local amenities. Several transport options are available nearby including Northern Line, Victoria Line & Overground Services.

Features

- Period Conversion
- Large Reception Room
- Kitchen/Breakfast Room
- Double Bedroom
- Private Garden
- Long Lease

Ballater Road, London, SW2

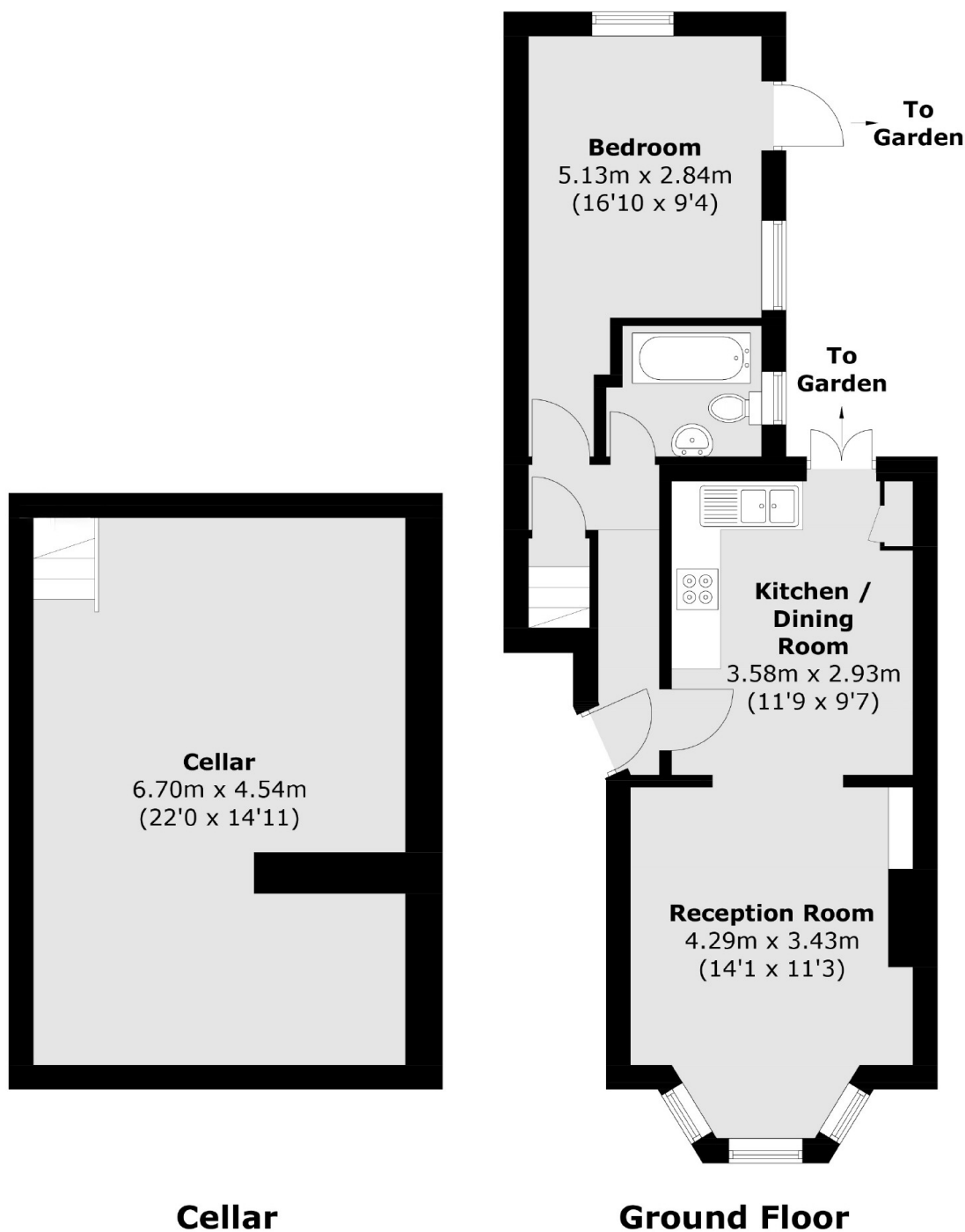

Total area (approx.): 75.5 sq. m (812.7 sq. ft)
(Including Cellar)