



Crescent Lane, SW4  
£1,850,000

**Dexters**



## Crescent Lane, SW4

A superb doubled fronted, semi detached, six -bedroom, three bathroom, end of terrace, freehold home currently extending to an impressive 2,617 sq.ft over three floors with a south west garden and garage.

The double reception room is positioned to the right of the entrance hall and includes a bay window, two comfortable seating areas, period features including two original fireplaces and cornicing.

To the rear of the property is the kitchen, dining area and a conservatory. Whilst already well-proportioned, the property retains the potential for a ground floor extension.

Over the first and second floors, there are five double bedrooms, three bathrooms including an en-suite. Each room is fitted with bespoke carpentry, original flooring and period features. The principal bedroom is traditionally positioned at the front of the first floor.

Crescent Lane is a quiet tree-lined residential street moments from the many local shops, restaurants and cafés of Abbeville Road, with Clapham South & Clapham Common stations a short stroll away.

### Features

- Double Reception
- Semi Detached
- Chain Free
- Garage
- South West Facing Garden
- Cellar







# Crescent Lane, London, SW4

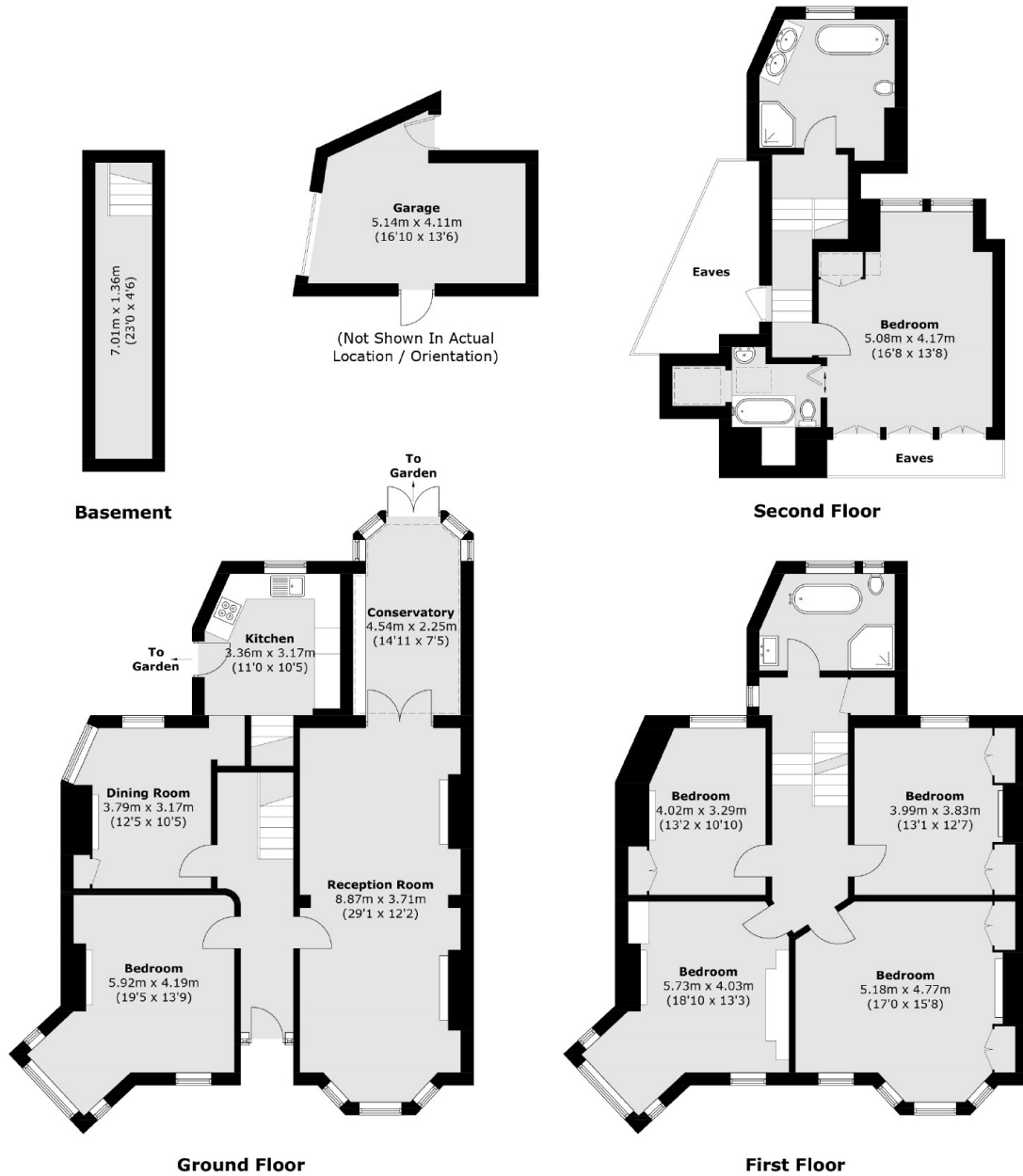

Total area (approx.): 243.2 sq. m (2,617.8 sq. ft)  
(Excluding Eaves)  
Garage: 15.9 sq. m (171.1 sq. ft)