



Lessar Avenue, SW4

£1,350,000

A rare and exciting development/investment opportunity to purchase an unextended, terraced freehold, reaching to an impressive 1,955 sq.ft naturally, with the potential to extend (STPP).

Lessar Avenue situated within the Abbeville Village, a highly desirable area renowned for its array of shops, restaurants and bars. The property falls within the catchment of Bonneville State Primary School and is within a short walk of Clapham Common and its respective Underground Station (Northern Line).

Features

- Freehold
- Three Floors
- Chain free
- Superb Location
- Potential To Extend

Lessar Avenue, London, SW4

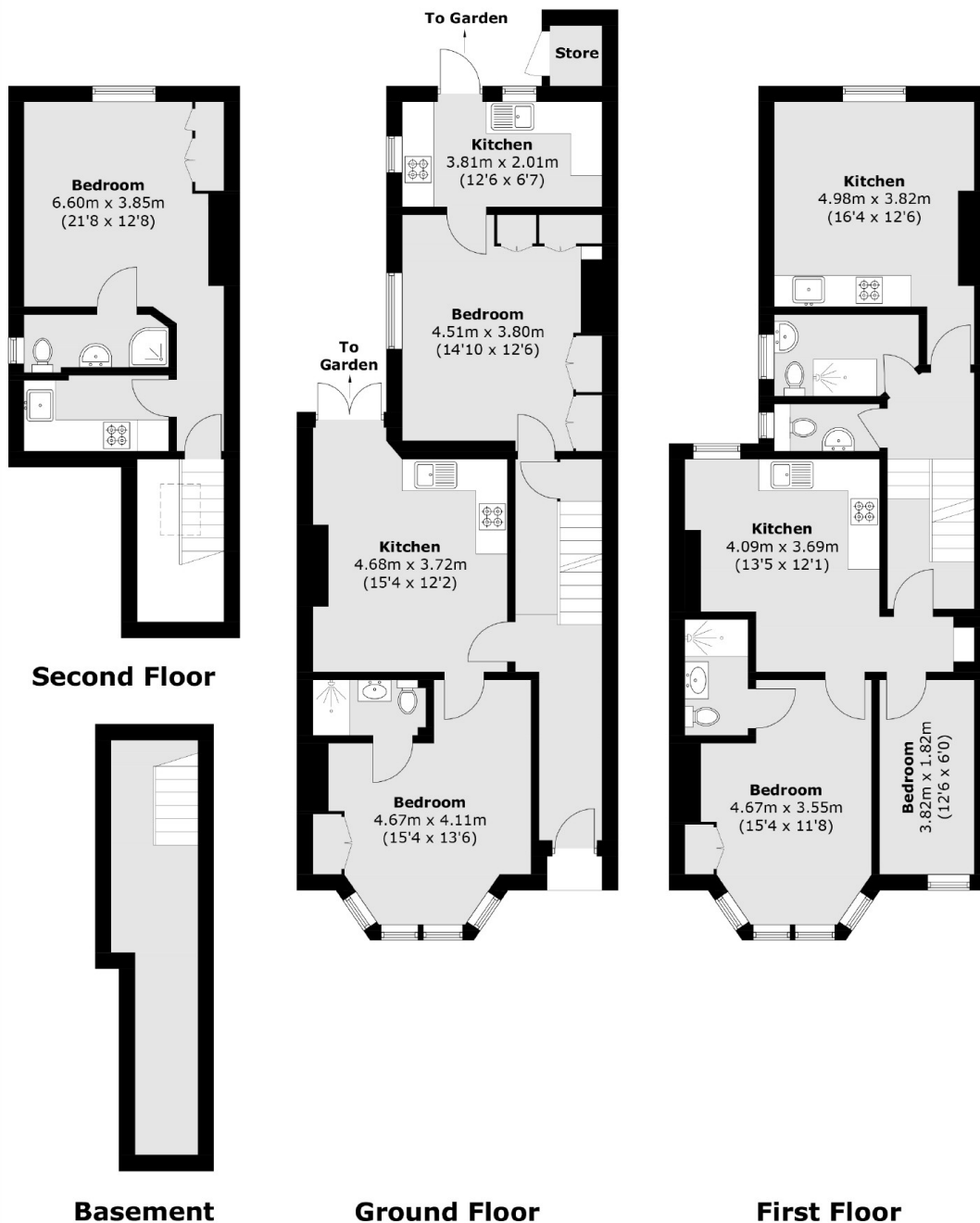

Total area (approx.): 181.7 sq. m (1955.8 sq. ft)
 (Including Basement / Excluding Store)
 External Store (approx.): 1.1 sq. m (11.8 sq. ft)