



## Abbeville Road, SW4

£370,000

A contemporary second floor apartment situated within private, gated development, comprising an open plan reception room with an integrated kitchen, a double bedroom and a bathroom.

Abbeville Road is located moments from the local shops, restaurants and cafés of the Abbeville Village. Clapham Common & Clapham South stations, along with a convenient bus stop linking to Clapham Junction are just a short stroll away.

### Features

- Private Development
- Open Plan Reception Room
- Double Bedroom
- Communal Grounds
- Underfloor Heating
- Chain Free

# Abbeville Road, London, SW4

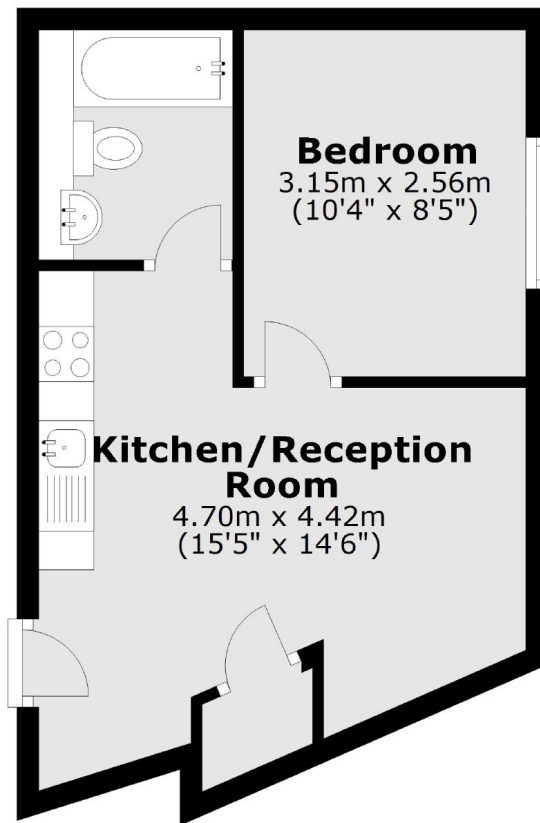

Total area: approx. 28.4 sq. metres (305.3 sq. feet)