



## Eltringham Street, SW18

£2,500 Per calendar month

A contemporary two bedroom apartment, located within this prestigious development. With a large living space, private balcony and communal roof terrace, this is perfect for a professional couple or single person. Underground parking space included.

Located near Wandsworth Town station and its delightful high street, you have lots of shops and restaurant options on your doorstep, and you are less than a mile away from Fulham.

### Features

- Two Bedrooms
- Two Bathrooms
- Wandsworth Town Station
- Balcony
- Communal Roof Terrace
- Parking Space

# Eltringham Street, London, SW18

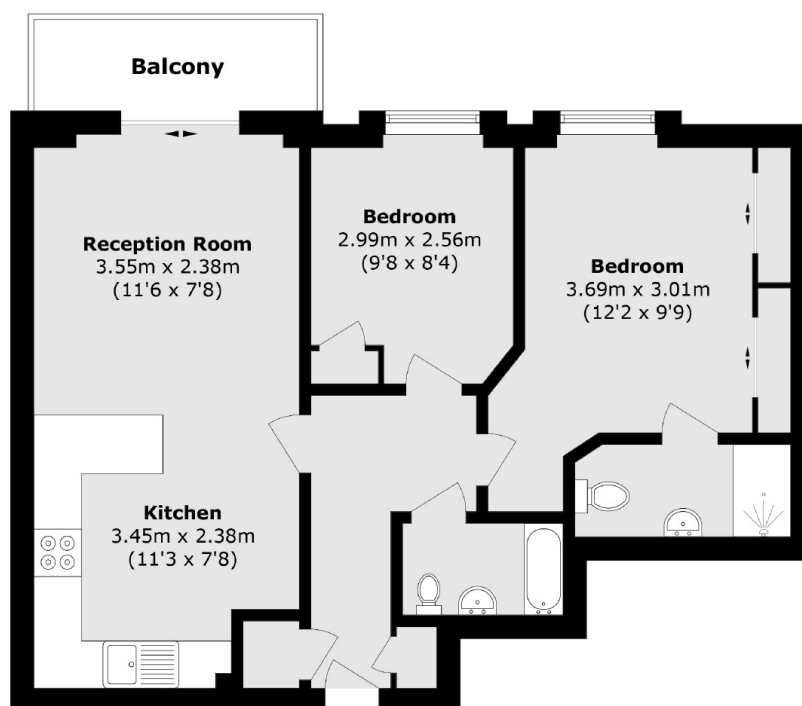

Total area (approx.): 59.6 sq. m (641.5 sq. ft)

Balcony area (approx.): 4.2 sq. m (45.2 sq. ft)