

## Mansell Street, E1

£2,000 Per calendar month

A well presented one double bedroom apartment on the first floor of Londinium Tower. This well presented property comes with separate kitchen, private balcony and a 24 hour concierge.

Located just a few streets away from Tower Gateway and Aldgate, perfect location for an east commute into the city and Canary Wharf.

### Features

- One Double Bedroom
- Concierge
- Balcony
- Wood Floors
- Separate Kitchen
- Amazing Location

# Mansell Street, London, E1

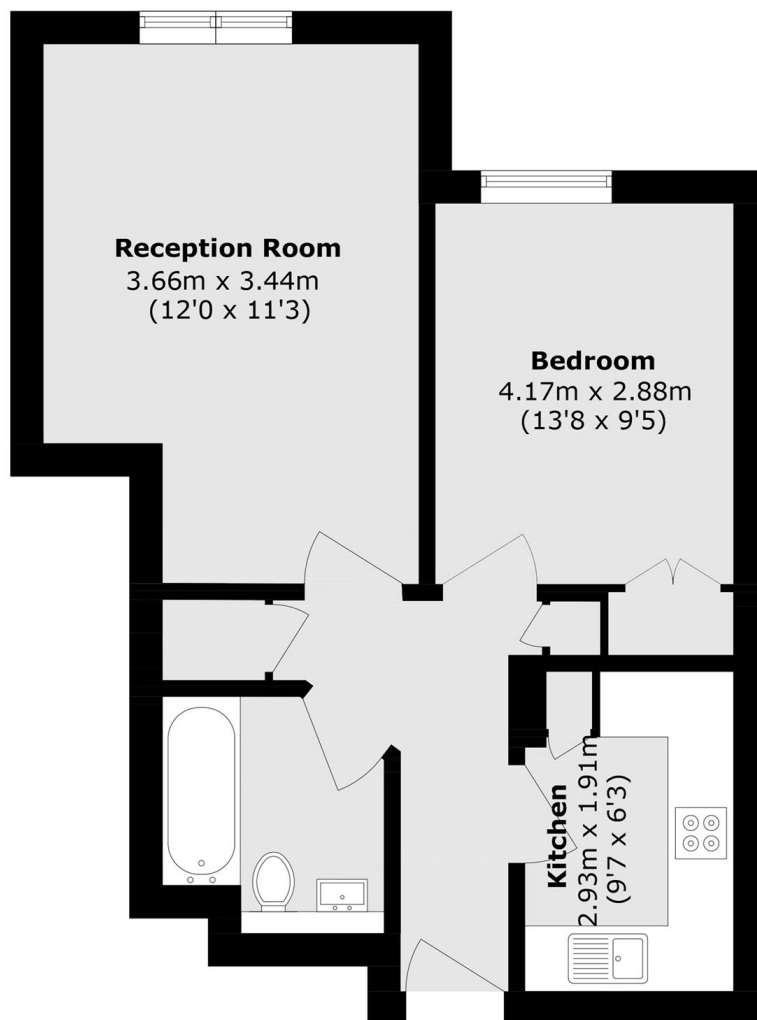

## First Floor

Total area (approx.): 43.7 sq. m (470.3 sq. ft)