



Woodseer Street, E1

£2,250 Per calendar month

This two double bedroom house is based in a cul-de-sac, just off Brick Lane. The property has a bright and airy reception room that leads directly on your own private garden, which is perfect for entertaining. An ideal property for a professional couple or sharers needing to be close to the City.

Woodseer Street has Brick Lane on its doorstep, where you can find many interesting and exciting activities, bars, shops and restaurants for whatever your heart desires.

Features

- Two Double Bedroom
- Private Garden
- Separate Kitchen
- Semi-detached House
- Quiet cu- de-sac Street
- Close to Shops/Transport

Woodseer Street,
London, E1

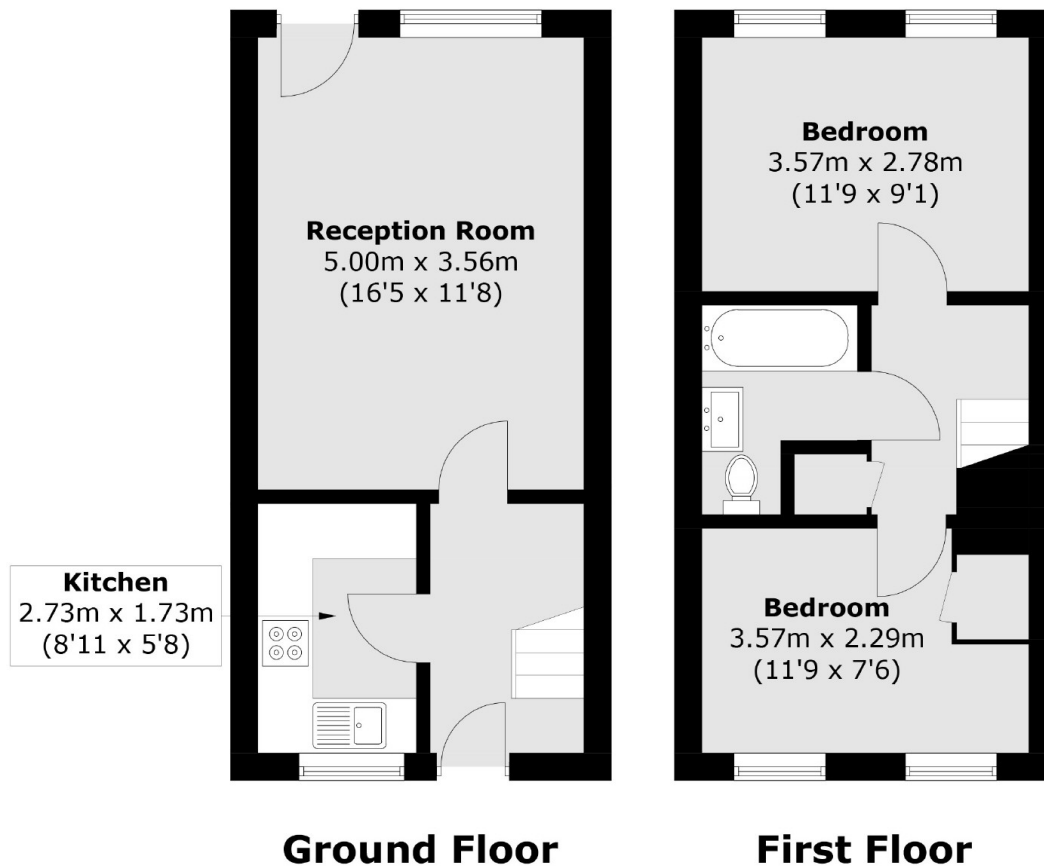

Total area (approx.): 56.0 sq. m (602.8 sq. ft)

Dexters

City
5 Sandys Row
London
E1 7HW
Lettings
020 7392 9111

Energy Rating: . We aim to make our particulars both accurate and reliable. However they are not guaranteed; nor do they form part of an offer or contract. If you require clarification on any points then please contact us, especially if you're traveling some distance to view. Please note that appliances and heating systems have not been tested and therefore no warranties can be given as to their good working order.

 **RICS** | Regulated
Estate Agent
and Letting Agent

dexters.co.uk