



## Back Church Lane, E1

£1,950 Per calendar month

An amazing one double bedroom apartment in the heart of Aldgate. This property has a large private terrace leading from the living room, a modern kitchen and private communal garden with a resident Tennis Court.

Back Church Lane is perfectly located for access to Tower Hill, Aldgate East and Liverpool Street Station, just moments away from Spitalfields and Brick Lane.

### Features

- One Bedroom Apartment
- Large Private Terrace
- Modern Interior
- Residents Communal Gardens
- Furnished
- Central Location

Back Church Lane,  
London, E1

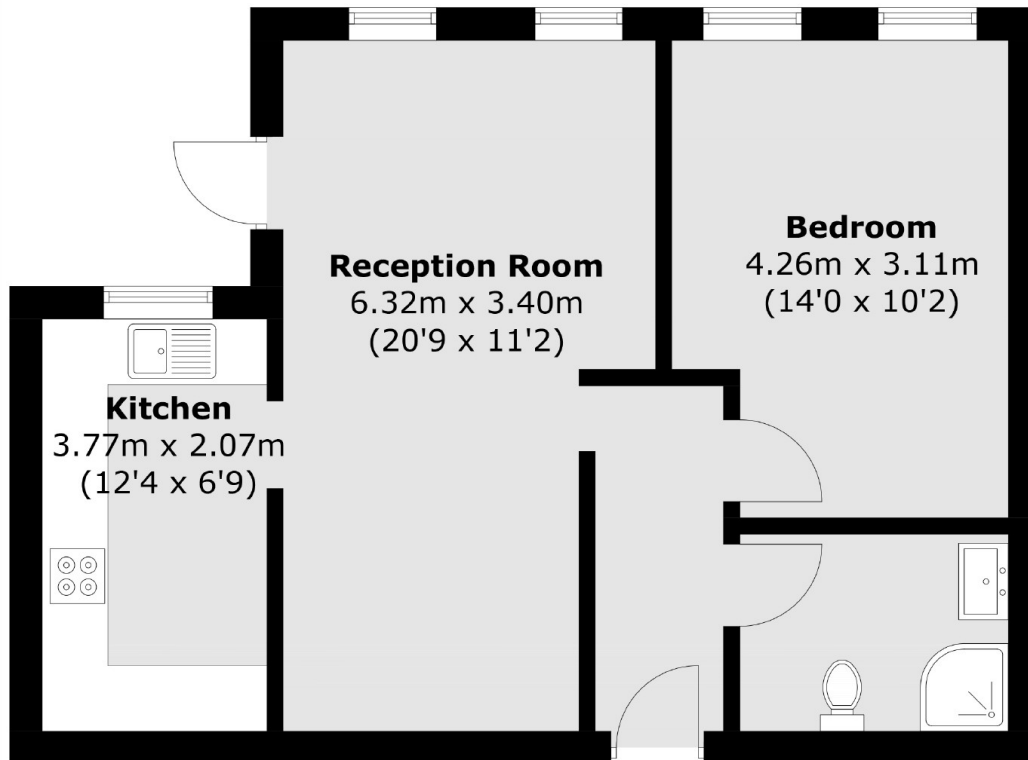

Total area (approx.): 50.4 sq. m (542.5 sq. ft)