



Buttercup Walk, Desborough **Freehold** £270,000 O.I.E.O.

**Pattison
Lane**

Key Features

 3  2  C  C

- Three Bedroom Semi Detached
- Garage & Driveway
- Utility
- En Suite to Master Bedroom
- Stylish Decor Throughout

We award top marks for the condition and presentation of this spacious three-bedroom home which occupies a wonderful private position within the ever-popular Grange development. Highlights include stylish interior décor, a low maintenance landscaped rear garden, a garage and parking.



ENTRANCE HALL

Reached via main front door. Stairs rising to first floor landing.

LOUNGE 12'1 max x 16' plus bay (3.68 x 4.87m)
Bay window to front aspect.

KITCHEN AREA 7'1 x 9'8 (2.15m x 2.94m)
Fitted with units to base and wall with contrasting work surfaces over and rising upstands. Sink unit with mixer tap over. Integrated oven. Inset hob with cooker hood over. Space for appliances. Window to rear aspect.

UTILITY

Work surfaces area and plumbing and space for washing machine.

DINING AREA 8'1 x 9'9 (2.46m x 2.97m)
French style doors opening to the rear garden.

FIRST FLOOR LANDING

Stairs rising to second floor. Window to side aspect. Storage cupboard. Doors to second bedroom, third bedroom and bathroom.

BEDROOM TWO 15'6 x 8'6 (4.72m x 2.59m)
Windows to rear aspect. Built in wardrobe.

BEDROOM THREE 10'1 x 8'7 (3.07m x 2.61m)
Window to front aspect.



GROUND FLOOR

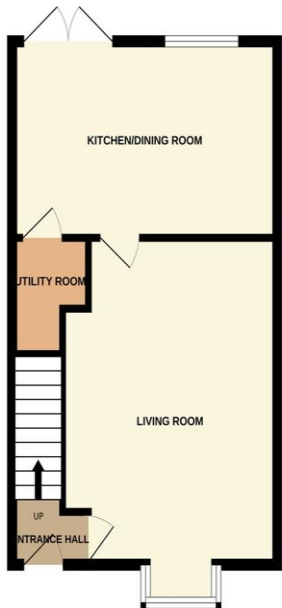

1ST FLOOR

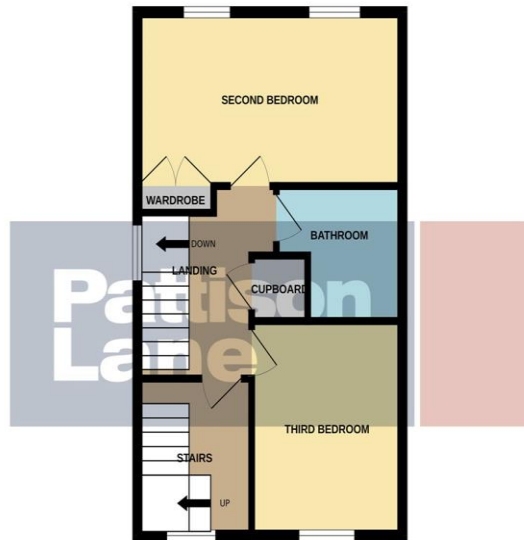

2ND FLOOR



Whilst every attempt has been made to ensure the accuracy of the floorplan contained here, measurements of doors, windows, rooms and any other items are approximate and no responsibility is taken for any error, omission or mis-statement. This plan is for illustrative purposes only and should be used as such by any prospective purchaser. The services, systems and appliances shown have not been tested and no guarantee as to their operability or efficiency can be given.
Made with Metropix ©2025

BATHROOM

Suite comprising a panelled bath with shower screen and shower over, wash hand basin and WC.

SECOND FLOOR

BEDROOM ONE 15'6 max x 12'3 max plus wardrobe
Window to side aspect. Dormer style window to front aspect. Built in wardrobes. Door to en suite.

EN SUITE

Suite comprising a shower enclosure, wash hand basin and WC. Skylight window.

OUTSIDE

FRONT GARDEN

Open plan frontage with side gate access to the rear garden.

GARAGE & DRIVEWAY

To the rear of the property.

REAR GARDEN

Maintained low maintenance garden with laid to artificial lawn raised planted bedded areas and a raised decked seating area.

To view this property call Pattison Lane on:
01536 430527

Selling your property?

Contact us to arrange a **FREE** home valuation.

 01536 430527

 42 Station Road, Desborough, KETTERING, Northamptonshire, NN14 2RL

 desborough@pattisonlane.co.uk

 www.pattisonlane.co.uk



 SCAN ME



 SCAN ME



Sharman Quinney Holdings Limited is registered in England and Wales under company number 4174227, Registered Office is Cumbria House, 16-20 Hockliffe Street, Leighton Buzzard, Bedfordshire, LU7 1GN. VAT Registration Number is 500 2481 05.

1: These particulars do not constitute part or all of an offer or contract. 2: The measurements indicated are supplied for guidance only and as such must be considered incorrect. 3: Potential buyers are advised to recheck the measurements before committing to any expense. 4: Sharman Quinney has not tested any apparatus, equipment, fixtures, fittings or services and it is the buyers interests to check the working condition of any appliances. 5: Sharman Quinney has not sought to verify the legal title of the property and buyers must obtain verification from their legal representative. 6: Intending purchasers will be asked to produce identification documentation at a later stage and we would ask your co-operation in order that there will be no delay in agreeing the sale. Ref: DPL101287 - 0001

