



Harborough Road, Desborough **Freehold** £175,000 O.I.E.O.

**Pattison
Lane**

Key Features

2 1 D A

- Two Bedroom Home
- Bay Fronted
- Two Reception Rooms
- Cellar
- Front & Rear Gardens

This charming two-bedroom Victorian bay fronted home represents a fantastic first time buy with highlights to include: a private rear garden, a cellar currently used as a gym, two large double bedrooms and separate reception rooms. Viewing advised.



ENTRANCE

Reached via main front door into:

LOUNGE 12'1 max x 11'1 plus bay (3.68m x 3.37m)

Bay window to front aspect. Log burning stove.

INNER HALL

Stairs rising to first floor landing. Door to dining room.

DINING ROOM 11'11 max x 12' (3.63m x 3.65m)

Door and window to rear aspect. Door to stairs lowering to the cellar.

CELLAR 11'11 x 11'10 (3.63m x 3.60m)

KITCHEN 5'10 x 10'8 (1.77m x 3.25m)

Fitted with units to base and wall with contrasting work surfaces over and tiled splashback surrounds. Breakfast bar. Under unit down lighting. Sink and drainer unit with mixer tap over. Integrated oven. Inset hob with cooker hood over. Plumbing and space for washing machine. Window to rear aspect.

FIRST FLOOR

BEDROOM ONE 13'7 max x 11'11 (4.14m x 3.63m)

Window to front aspect. Fitted wardrobe.



BASEMENT

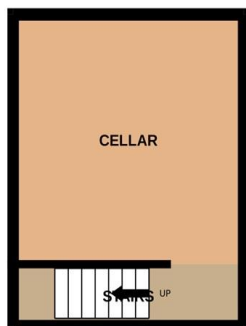

GROUND FLOOR

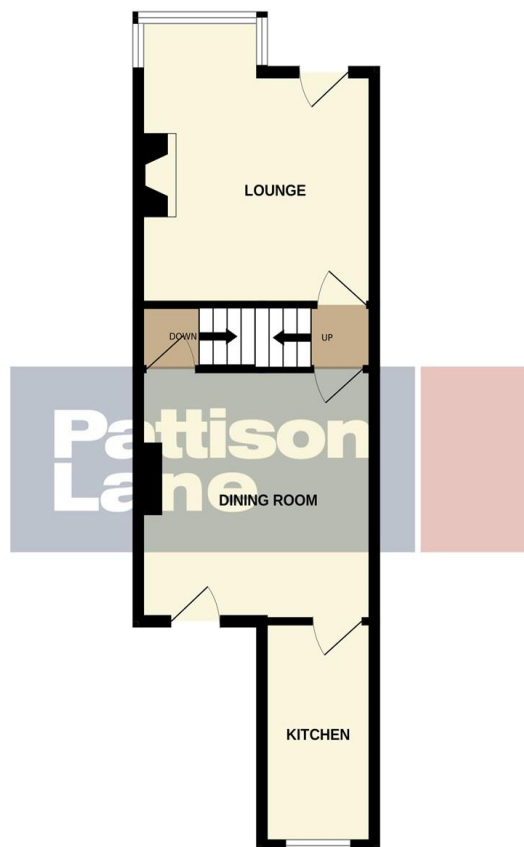

1ST FLOOR

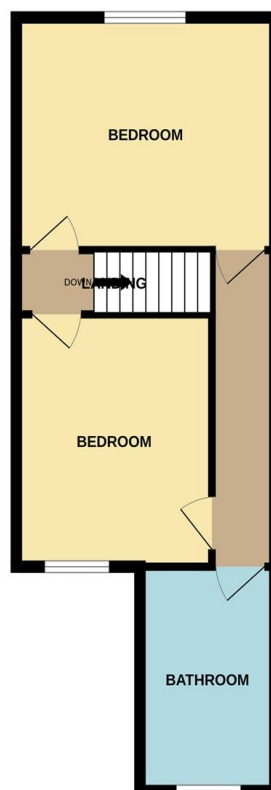

Whilst every attempt has been made to ensure the accuracy of the floorplan contained here, measurements of doors, windows, rooms and any other items are approximate and no responsibility is taken for any error, omission or mis-statement. This plan is for illustrative purposes only and should be used as such by any prospective purchaser. The services, systems and appliances shown have not been tested and no guarantee as to their operability or efficiency can be given.
Made with Metropix ©2025

BEDROOM TWO 10'6 max x 12' (3.20m x 3.65m)
Window to rear aspect.

BATHROOM

Suite comprising a panelled bath with shower screen and shower over, vanity wash hand basin and WC. Window to rear aspect.

OUTSIDE

FRONT GARDEN

Courtyard frontage with access to the main front door.

REAR GARDEN

Mainly laid to lawned garden with a decked area and a brick built out building. Side gate access to the front.

To view this property call Pattison Lane on:
01536 430527

Selling your property?

Contact us to arrange a **FREE** home valuation.

 01536 430527

 42 Station Road, Desborough, KETTERING, Northamptonshire, NN14 2RL

 desborough@pattisonlane.co.uk

 www.pattisonlane.co.uk



 SCAN ME



 SCAN ME



Sharman Quinney Holdings Limited is registered in England and Wales under company number 4174227, Registered Office is Cumbria House, 16-20 Hockliffe Street, Leighton Buzzard, Bedfordshire, LU7 1GN. VAT Registration Number is 500 2481 05.

1: These particulars do not constitute part or all of an offer or contract. 2: The measurements indicated are supplied for guidance only and as such must be considered incorrect. 3: Potential buyers are advised to recheck the measurements before committing to any expense. 4: Sharman Quinney has not tested any apparatus, equipment, fixtures, fittings or services and it is the buyers interests to check the working condition of any appliances. 5: Sharman Quinney has not sought to verify the legal title of the property and buyers must obtain verification from their legal representative. 6: Intending purchasers will be asked to produce identification documentation at a later stage and we would ask your co-operation in order that there will be no delay in agreeing the sale. Ref: DPL101075 - 0003

