



Pattison  
Lane

Whitehill Road, Desborough **Freehold** £355,000 O.I.E.O.

**Pattison  
Lane**



# Key Features

 4  2  D  D

- Four Bedroom Detached Home
- Garage & Driveway
- Large Gardens to Front and Rear
- No Onward Chain
- Refitted Kitchen Breakfast Room

This substantial four bedroom detached home occupies an impressive plot and is offered with no upward chain. Further highlights include; a large living room with sliding doors to the rear garden, separate reception rooms, beautifully maintained gardens, a driveway and a garage. Viewing recommended.





### ENTRANCE HALL

Reached via main front door. Stairs rising to first floor landing. Storage cupboard.

### LOUNGE 12'10 x 17' (3.91m x 5.18m)

Sliding doors opening to the rear garden. Stone chimney feature wall with shelving.

### DINING ROOM 8'8 x 11'11 (2.64m x 3.63m)

Window to front aspect.

### KITCHEN 7'10 x 11'11 (2.38m x 3.63m)

Fitted with a range of modern units to base and wall with contrasting work surfaces over and tiled splashback surrounds. Breakfast bar. One and half bowl sink and drainer unit. Eye level integrated oven. Inset hob with cooker hood over. Eye level microwave. Integrated fridge. Window to front aspect. Door to side aspect.

### UTILITY ROOM

Fitted with units to base. Storage cupboards. Sink and drainer unit. Plumbing and space for washing machine and dishwasher. Window to rear aspect.

### SHOWER ROOM

Suite comprising a shower enclosure, vanity wash hand basin and WC. Under floor heating. Frosted window to rear aspect.

### FIRST FLOOR LANDING

Window to side aspect. Storage cupboard. Doors to bedrooms and bathroom.



GROUND FLOOR  
793 sq.ft. (73.7 sq.m.) approx.

1ST FLOOR  
588 sq.ft. (54.6 sq.m.) approx.

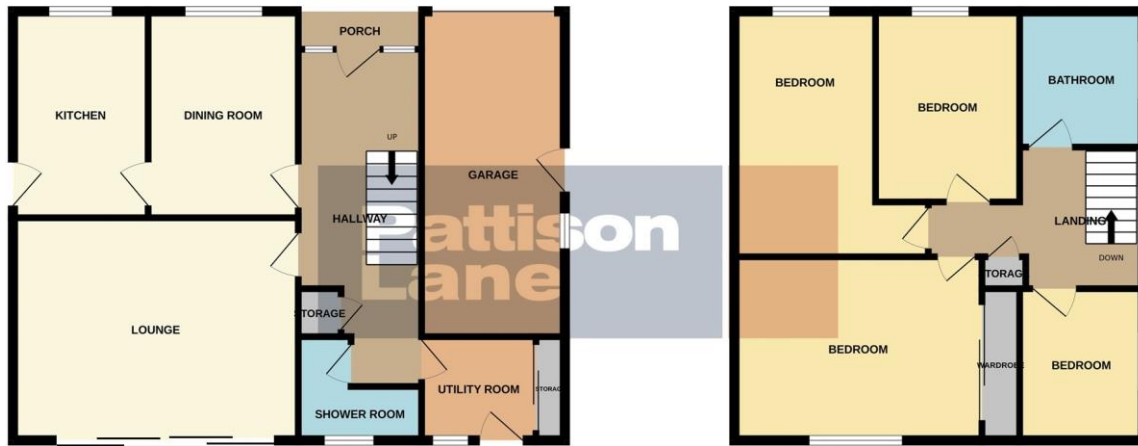

TOTAL FLOOR AREA: 1381 sq.ft. (128.3 sq.m.) approx.

Whilst every attempt has been made to ensure the accuracy of the floorplan contained here, measurements of doors, windows, rooms and any other items are approximate and no responsibility is taken for any error, omission or mis-statement. This plan is for illustrative purposes only and should be used as such by any prospective purchaser. The services, systems and appliances shown have not been tested and no guarantee as to their operability or efficiency can be given.  
Made with Metropix ©2024

**BEDROOM ONE** 14'5 plus wardrobe x 10'10 (4.39m x 3.30m)

Window to rear aspect. Built in wardrobes.

**BEDROOM TWO** 8'1 plus recess x 14'2 (2.46m x 4.31m)

Window to front aspect.

**BEDROOM THREE** 8'5 x 11'1 (2.56m x 3.37m)

Window to front aspect.

**BEDROOM FOUR** 7'2 x 9'4 (2.18m x 2.84m)

Window to side aspect.

#### BATHROOM

Modern fitted suite comprising an L shaped bath with shower screen and shower over, wash hand basin and WC. Under floor heating. Frosted window to side aspect.

#### OUTSIDE

##### FRONT GARDEN / DRIVEWAY

Large frontage providing off road parking for multiple cars with established shrub and stocked planted area. Side gate access to each side of the property.

##### INTERNAL GARAGE

Up and over door. Door and window to side aspect.

##### REAR GARDEN

A maintained garden with a paved seating area, laid to lawn with fully stocked borders, a large timber building, and a gravelled area to the rear of the garden with a timber shed.

To view this property call Pattison Lane on:  
**01536 430527**



# Selling your property?



SCAN ME

Contact us to arrange a **FREE** home valuation.

 01536 430527

 42 Station Road, Desborough, KETTERING, Northamptonshire, NN14 2RL

 [desborough@pattisonlane.co.uk](mailto:desborough@pattisonlane.co.uk)

 [www.pattisonlane.co.uk](http://www.pattisonlane.co.uk)



SCAN ME



Sharman Quinney Holdings Limited is registered in England and Wales under company number 4174227, Registered Office is Cumbria House, 16-20 Hockliffe Street, Leighton Buzzard, Bedfordshire, LU7 1GN. VAT Registration Number is 500 2481 05.

1: These particulars do not constitute part or all of an offer or contract. 2: The measurements indicated are supplied for guidance only and as such must be considered incorrect. 3: Potential buyers are advised to recheck the measurements before committing to any expense. 4: Sharman Quinney has not tested any apparatus, equipment, fixtures, fittings or services and it is the buyers interests to check the working condition of any appliances. 5: Sharman Quinney has not sought to verify the legal title of the property and buyers must obtain verification from their legal representative. 6: Intending purchasers will be asked to produce identification documentation at a later stage and we would ask your co-operation in order that there will be no delay in agreeing the sale. Ref: DPL101020 - 0007

