



BELVOIR!

Property is personal

£123,000

Broad Street

Northampton, NN1 2HS

PROPERTY SUMMARY

BELVOIR! is pleased to present this two bedroom apartment located on the first floor of the ever popular Alpha House. The accommodation comprises a large entrance hall, kitchen / living room, master bedroom with en-suite, a second bedroom and a bathroom. There is one allocated car parking space under the building.

Alpha House has a great location very close to the town centre – the mainline railway station, the bus station and the high street are all within a few minutes walk. The building has a concierge, secured parking, and a fitness room.

- Service charge £2993 p/a
- Ground rent £390 p/a
- 107 years left on lease

2



2



1







BELVOIR!

Property is personal

Alpha House, NN1

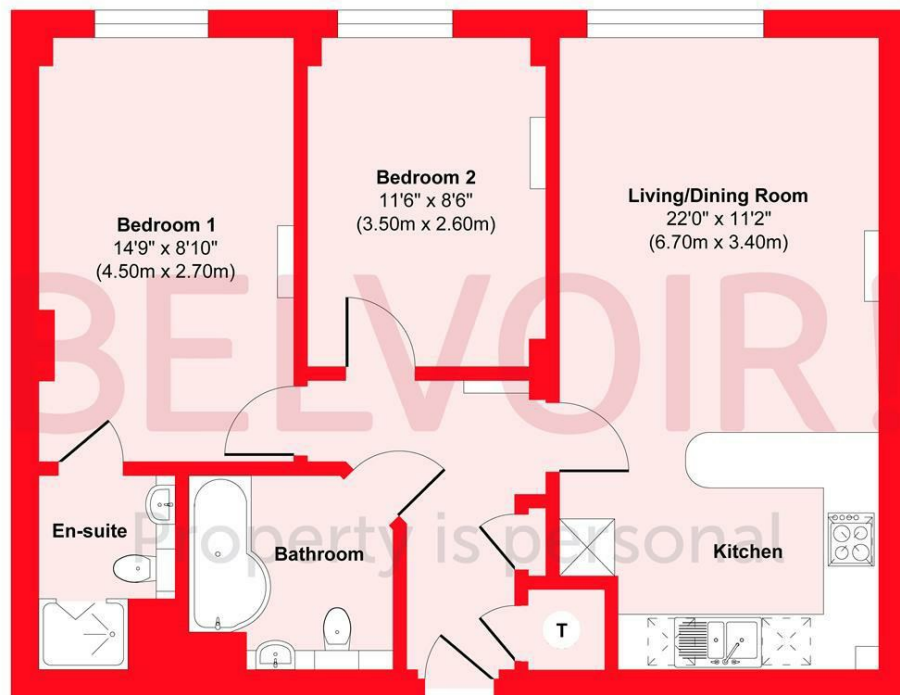

Floor Plan
Approximate Floor Area
646 sq. ft
(60.00 sq. m)

Approx. Gross Internal Floor Area 646 sq. ft / 60.00 sq. m
Illustration for identification purposes only, measurements are approximate, not to scale.
Produced by Elements Property

LOCAL AUTHORITY

Northampton

TENURE

Leasehold

COUNCIL TAX BAND

C

VIEWINGS

By prior appointment only

Energy Efficiency Rating		
	Current	Potential
Very energy efficient - lower running costs		
(92 plus) A		
(81-91) B	83	85
(69-80) C		
(55-68) D		
(39-54) E		
(21-38) F		
(1-20) G		
Not energy efficient - higher running costs		
England & Wales		EU Directive 2002/91/EC

Agents Note: Whilst every care has been taken to prepare these particulars, they are for guidance purposes only. All measurements are approximate and are for general guidance purposes only and whilst every care has been taken to ensure their accuracy, they should not be relied upon and potential buyers/tenants are advised to recheck the measurements

OFFICE ADDRESS

East Hunsbury Local Centre Butts
Road
Northampton
Northamptonshire
NN4 0UE

OFFICE DETAILS

01604 701701
northampton@belvoir.co.uk
www.belvoirnorthampton.com