

ASH RISE, NORTHAMPTON, NN2

Guide price £200,000 | 3 Bed House - Mid Terrace

BELVOIR!



This is a 3 bedroom mid-terrace property in Kingsthorpe which is dated throughout and requires full refurbishment. It comprises three bedrooms and a bathroom upstairs, plus a large living room and kitchen downstairs. The single garage is ideal for part-conversion to additional living space.

- LOTS OF POTENTIAL
- NO CHAIN
- GARAGE (THAT WOULD CONVERT)
- GAS CENTRAL HEATING
- REQUIRES UPDATING
- EASY TO ADD VALUE

COUNCIL TAX BAND: B

Draft Details.

At the time of print, these particulars are awaiting approval from the vendor(s).

Disclaimer.

We endeavour to make our sales particulars accurate and reliable, however, they do not constitute or form part of an offer or any contract and none is to be relied upon as statements of representation or fact. Any services, systems and appliances listed in this specification have not been tested by us and no guarantee as to their operating ability or efficiency is given. All measurements have been taken as a guide to prospective buyers only, and are not precise. If you require clarification or further information on any points, please contact us, especially if you are travelling some distance to view. Fixtures and fittings other than those mentioned are to be agreed with the seller by separate negotiation.

Energy Efficiency Rating		
	Current	Potential
Very energy efficient - lower running costs		
(92 plus) A		70
(81-91) B		
(69-80) C		
(55-68) D		
(39-54) E		
(21-38) F		
(1-20) G		
Not energy efficient - higher running costs		
England & Wales	EU Directive 2002/91/EC	

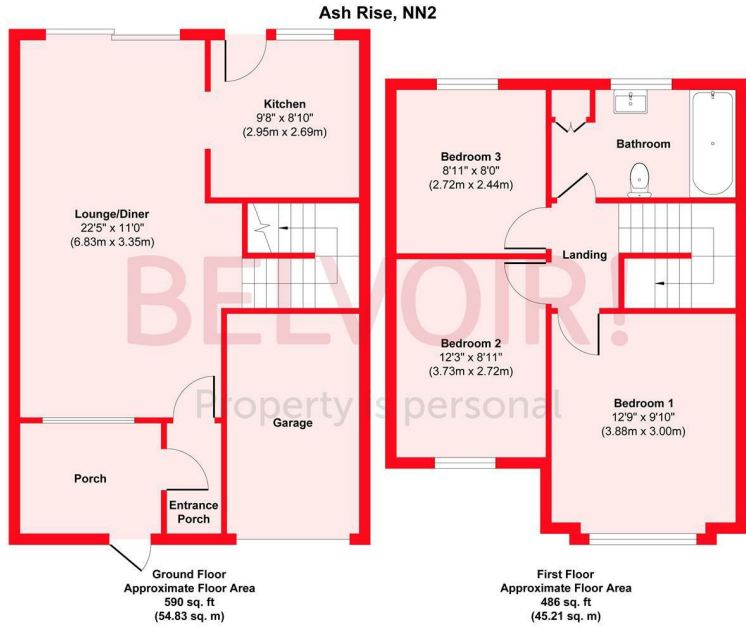

Approx. Gross Internal Floor Area 1076 sq. ft / 100.04 sq. m
 Illustration for identification purposes only, measurements are approximate, not to scale.
 Produced by Elements Property

