

BUTTS CROFT CLOSE, NORTHAMPTON, NN4

£225,000 | 2 Bed House - End Terrace

BELVOIR!



Undergoing full refurbishment - photos to follow.

Belvoir Estate Agents are delighted to offer for sale this two bedroom end of terrace house that is conveniently located close to local amenities. The accommodation briefly comprises entrance hall, modern kitchen, lounge/diner, first floor landing, two bedrooms and a bathroom. The property further benefits from gas radiator heating, rear garden and off street parking.

- Two Bedrooms
- End Of Terrace
- Lounge/Diner
- Modern Kitchen
- Gas Radiator Heating
- Rear Garden
- Off Road Parking
- Close To Local Amenities

COUNCIL TAX BAND: B

Draft Details.

At the time of print, these particulars are awaiting approval from the vendor(s).

Disclaimer.

We endeavour to make our sales particulars accurate and reliable, however, they do not constitute or form part of an offer or any contract and none is to be relied upon as statements of representation or fact. Any services, systems and appliances listed in this specification have not been tested by us and no guarantee as to their operating ability or efficiency is given. All measurements have been taken as a guide to prospective buyers only, and are not precise. If you require clarification or further information on any points, please contact us, especially if you are travelling some distance to view. Fixtures and fittings other than those mentioned are to be agreed with the seller by separate negotiation.

BUTTS CROFT CLOSE, NORTHAMPTON, NN4

£225,000 | 2 Bed House - End Terrace

BELVOIR!

Energy Efficiency Rating		Current	Potential
Very energy efficient - lower running costs			
(92 plus) A			87
(81-91) B			
(69-80) C			
(55-68) D			
(39-54) E			
(21-38) F			
(1-20) G			
Not energy efficient - higher running costs			
England & Wales	EU Directive 2002/91/EC		

Butts Croft Close, NN4

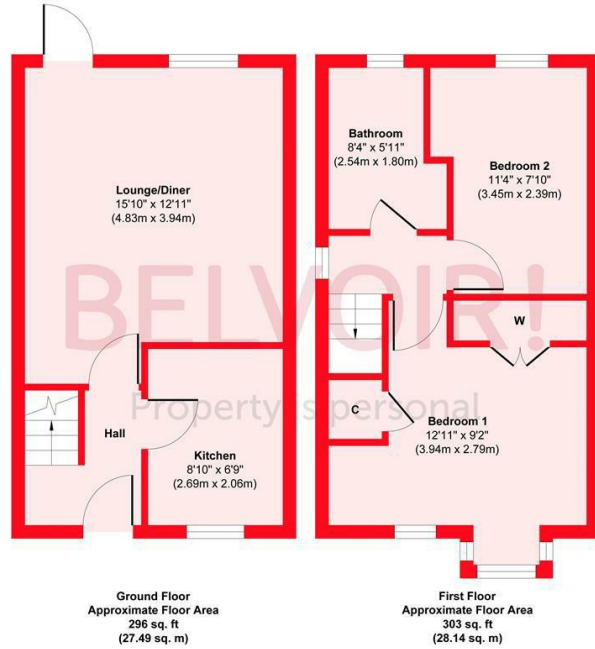

Approx. Gross Internal Floor Area 599 sq. ft / 55.63 sq. m
Illustration for identification purposes only, measurements are approximate, not to scale. Produced by Elements Property.

