

HAMSTERLY PARK, NORTHAMPTON, NN3

£180,000 | 2 Bed House - Semi-Detached

BELVOIR!



Belvoir Estate Agents are delighted to offer for sale this modern two bedroom end of terrace house located in Southfields. The accommodation briefly comprises cloakroom, open plan lounge/dining/kitchen, first floor landing, two bedrooms and a bathroom. The property further benefits from gas radiator central heating, upvc double glazing, driveway providing off road parking for one car and enclosed rear garden. No above chain.

COUNCIL TAX BAND: B

- Two Bedrooms
- End Of Terrace
- Off Road Parking
- Open Plan Lounge/Diner/Kitchen
- Cloakroom
- UPVC Double Glazing
- Gas Radiator Heating
- Rear Garden
- No Above Chain

Draft Details.

At the time of print, these particulars are awaiting approval from the vendor(s).

Disclaimer.

We endeavour to make our sales particulars accurate and reliable, however, they do not constitute or form part of an offer or any contract and none is to be relied upon as statements of representation or fact. Any services, systems and appliances listed in this specification have not been tested by us and no guarantee as to their operating ability or efficiency is given. All measurements have been taken as a guide to prospective buyers only, and are not precise. If you require clarification or further information on any points, please contact us, especially if you are travelling some distance to view. Fixtures and fittings other than those mentioned are to be agreed with the seller by separate negotiation.

HAMSTERLY PARK, NORTHAMPTON, NN3

£180,000 | 2 Bed House - Semi-Detached

BELVOIR!

Energy Efficiency Rating	
Current	Potential
Very energy efficient - lower running costs	
(92 plus) A	75
(81-91) B	
(69-80) C	
(55-68) D	
(39-54) E	
(21-38) F	
(1-20) G	
Not energy efficient - higher running costs	
England & Wales	EU Directive 2002/91/EC 

Hamsterly Park, NN3

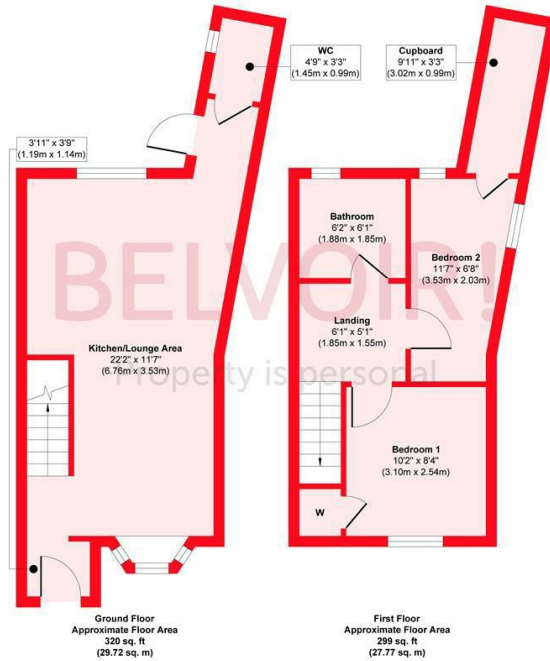

Approx. Gross Internal Floor Area 619 sq. ft. / 57.49 sq. m
Illustration for identification purposes only, measurements are approximate, not to scale. Produced by Elements Property

