

MARLBOROUGH ROAD, NORTHAMPTON, NN5

£195,000 | 2 Bed House - Mid Terrace

BELVOIR!



Belvoir Estate Agents are delighted to offer for sale this larger than average two bedroom Victorian terrace. The well maintained accommodation briefly comprises entrance hall, lounge, dining room, kitchen/diner, first floor landing, two bedrooms, study area and bathroom. The property further benefits from gas radiator heating, upvc double glazing, rear garden and is located within walking distance of the train station.

- Two Bedrooms
- Larger Than Average
- Terrace House
- Kitchen/Diner
- Two Reception Rooms
- UPVC Double Glazing
- Gas Radiator Heating
- Close To Train Station

COUNCIL TAX BAND: A

Draft Details.

At the time of print, these particulars are awaiting approval from the vendor(s).

Disclaimer.

We endeavour to make our sales particulars accurate and reliable, however, they do not constitute or form part of an offer or any contract and none is to be relied upon as statements of representation or fact. Any services, systems and appliances listed in this specification have not been tested by us and no guarantee as to their operating ability or efficiency is given. All measurements have been taken as a guide to prospective buyers only, and are not precise. If you require clarification or further information on any points, please contact us, especially if you are travelling some distance to view. Fixtures and fittings other than those mentioned are to be agreed with the seller by separate negotiation.

MARLBOROUGH ROAD, NORTHAMPTON, NN5

£195,000 | 2 Bed House - Mid Terrace

BELVOIR!

Energy Efficiency Rating	
Current	Potential
Very energy efficient - lower running costs	
(92 plus) A	85
(81-91) B	
(69-80) C	
(55-68) D	
(39-54) E	
(21-38) F	
(1-20) G	
Not energy efficient - higher running costs	
63	
England & Wales	EU Directive 2002/91/EC 

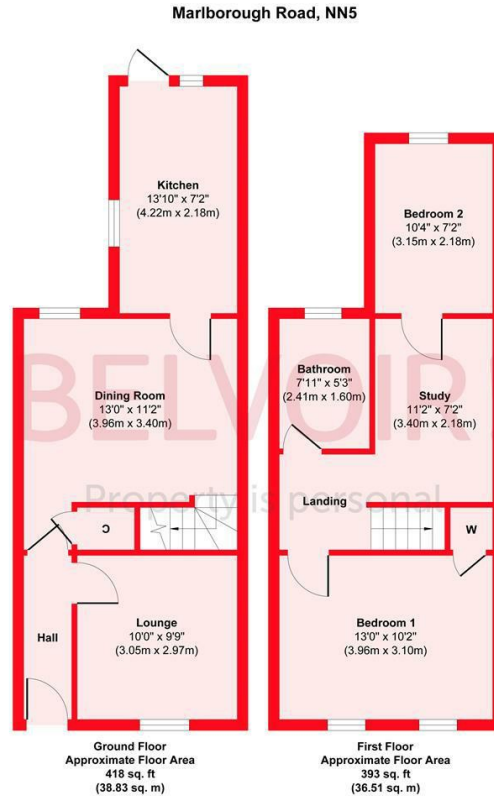

Approx. Gross Internal Floor Area 811 sq. ft / 75.34 sq. m
Illustration for identification purposes only, measurements are approximate, not to scale.
 Produced by Elements Property

