

HARRIER PARK, NORTHAMPTON, NN4

£329,995 | 3 Bed House - Detached

BELVOIR!



Belvoir Estate Agents are delighted to offer for sale this well proportioned three bedroom detached house in this popular part of East Hunsbury. The spacious accommodation briefly comprises entrance hall, cloakroom, large lounge, dining/family room, kitchen, first floor landing, bedroom one with en-suite, two further bedrooms and a family bathroom. The property further benefits from gas radiator heating, upvc double glazing, rear garden and offroad parking for at least two cars.

- Three Bedrooms
- Detached House
- Cloakroom
- Large Lounge
- Dining/Family Room
- En-Suite
- Off Road Parking
- Rear Garden
- UPVC Double Glazing
- Gas Radiator Heating

COUNCIL TAX BAND: C

Draft Details.

At the time of print, these particulars are awaiting approval from the vendor(s).

Disclaimer.

We endeavour to make our sales particulars accurate and reliable, however, they do not constitute or form part of an offer or any contract and none is to be relied upon as statements of representation or fact. Any services, systems and appliances listed in this specification have not been tested by us and no guarantee as to their operating ability or efficiency is given. All measurements have been taken as a guide to prospective buyers only, and are not precise. If you require clarification or further information on any points, please contact us, especially if you are travelling some distance to view. Fixtures and fittings other than those mentioned are to be agreed with the seller by separate negotiation.

HARRIER PARK, NORTHAMPTON, NN4

£329,995 | 3 Bed House - Detached

BELVOIR!

Energy Efficiency Rating	
	Potential
Very energy efficient - lower running costs	
(92 plus) A	82
(81-91) B	
(69-80) C	
(55-68) D	
(39-54) E	
(21-38) F	
(1-20) G	
Not energy efficient - higher running costs	
57	
England & Wales	EU Directive 2002/91/EC 

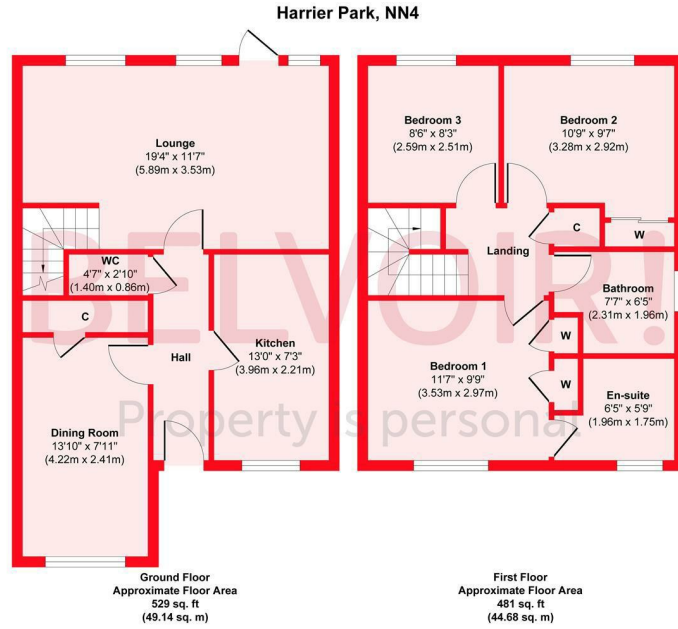

Approx. Gross Internal Floor Area 1010 sq. ft / 93.82 sq. m
Illustration for identification purposes only, measurements are approximate, not to scale. Produced by Elements Property

