

Ground Floor, 2a Petre Court, Petre Road, Clayton-le-Moors, BB5 5HY

**TO LET**

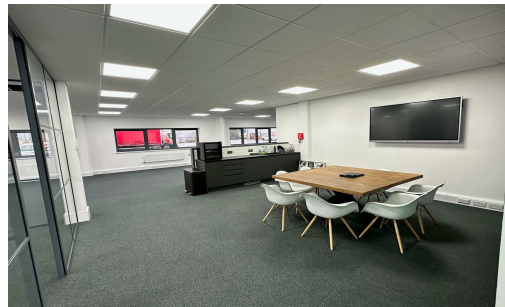

**TO LET**

Use - Office

Size - 1,691 Sq ft

Rent - £17,000 per annum

- High Quality Ground Floor Office Accommodation
- Excellent location next to J7 M65 motorway
- Recently refurbished to high standard
- Ample on site parking



COMMERCIAL PROPERTY AGENTS, CHARTERED SURVEYORS AND VALUERS

[www.taylorweaver.co.uk](http://www.taylorweaver.co.uk)

Telephone: 01254 699030

Email: [info@taylorweaver.co.uk](mailto:info@taylorweaver.co.uk)

## Ground Floor, 2a Petre Court, Petre Road, Clayton-le-Moors, BB5 5HY

### Location

The premises are prominently situated at the entrance to Petre Court, which is located in the heart of Clayton Business Park, within 0.5 miles of Junction 7 of the M65 motorway.

Neighbouring occupiers include Petre Dental Clinic, Triscan and Muriva Ltd.

### Description

The premises comprise the ground floor of a modern two storey semi-detached office building constructed on a steel frame with brickwork elevations and a mono pitched insulated steel profile clad roof.

The ground floor benefits from aluminum framed double glazed windows, carpet tiled floors, painted plasterboard walls, kitchen, gas fired central heating, LED lighting and WC & disabled facilities.

Externally there is parking for 8 vehicles within landscaped grounds

### Accommodation

We have calculated the net internal area of the ground floor suite to be 1,691 sq.ft.

### Rental

£17,000 per annum

### Lease Terms

The property is available by way of a new lease for a minimum period of 5 years on effective full repairing and insuring terms.

The rent will be paid quarterly in advance and be exclusive of the costs of occupation.

### Service Charge

A service charge will be levied on occupiers to cover the costs of maintaining the external areas, landscaping, cleaning of the common areas within the building. It is understood that the service charge is £2.00 per sq.ft. Further details on request.

### Building Insurance

The landlord to insure the building and charge the premium to the tenant. Further details on request.

### Rating

The ratable value of the property is £16,250 with rates payable in the region of £8,000.

### Legal Costs

Each party to be responsible for their own costs.

### VAT

VAT is applicable to figures quoted in these terms

### Services

All mains services are connected to the property

### EPC

An EPC is available on request.

### Electricity and Gas

Costs of electricity and gas to be sub-divided between the two occupiers of the building.

### Viewing

Strictly through agents

Taylor Weaver

(Neil Weaver)

01254 699030



[www.taylorweaver.co.uk](http://www.taylorweaver.co.uk)

Telephone: 01254 699030



Email: [info@taylorweaver.co.uk](mailto:info@taylorweaver.co.uk)

Taylor Weaver is a trading name of Taylor Weaver Limited. Registered Office: Unit 17 Trident Park, Trident Way, Blackburn BB1 3NU – Company Registration No. 04132040. MISREPRESENTATION ACT: Taylor Weaver (and their joint agents where applicable) for themselves and for the vendors or lessors of this property for whom they act, give notice that: (i) these particulars are a general outline only, for the guidance of prospective purchasers or tenants and do not constitute the whole or any part of an offer or contract; (ii) Taylor Weaver cannot guarantee the accuracy of any description, dimensions, references to condition, necessary permissions for use and occupation and other details contained herein, and prospective purchasers or tenants must not rely on them as a statement of fact or representations and must satisfy themselves as to their accuracy; (iii) no employee of Taylor Weaver (and their joint agents where applicable) has any authority to make any representation or warranty to enter into any contract whatever in relation to the property; (iv) prices or rents quoted in these particulars may be subject to VAT in addition; (v) Taylor Weaver will not be liable in negligence or otherwise for any loss arising from the use of these particulars.