

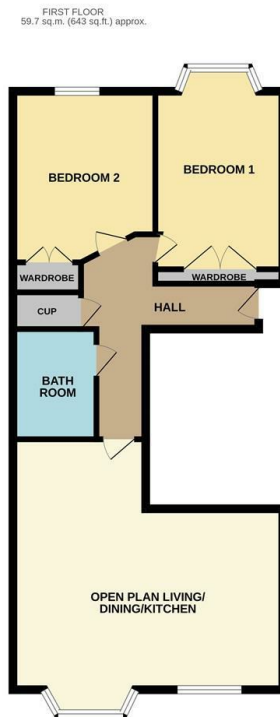

Flat 3, Royal Sands 151 North Marine Road, Scarborough, YO12

£695 PCM

- TWO BEDROOMS
- CASTLE AND SEA VIEWS
- AVAILABLE NOW
- FIRST FLOOR
- ELECTRIC HEATING
- EPC RATING C
- ON STREET PARKING
- FITTED KITCHEN WITH APPLIANCES
- COUNCIL TAX BAND B



TOTAL FLOOR AREA: 59.7 sq.m. (643 sq.ft.) approx.
Measurements are approximate. Not to scale. Illustrative purposes only.
Made with Metagix ©2023

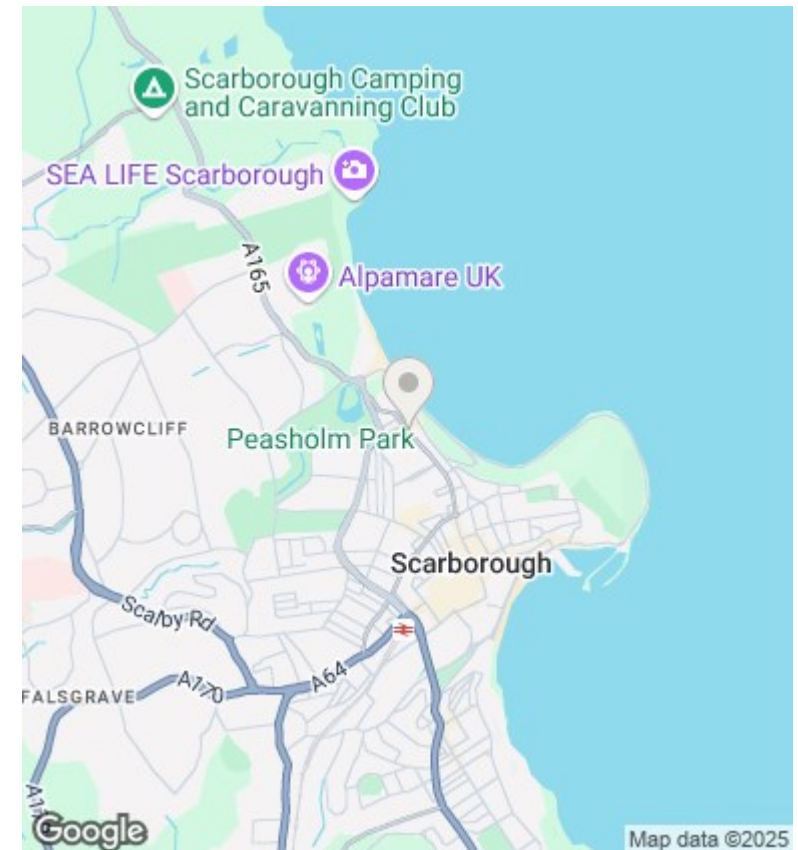

Viewings

Viewings by arrangement only. Call 01723 377707 to make an appointment.

Council Tax Band

B

EPC Rating:

C

| Energy Efficiency Rating | | |
|---|-------------------------|-----------|
| | Current | Potential |
| Very energy efficient - lower running costs | | |
| (92 plus) A | | |
| (81-91) B | | |
| (69-80) C | | |
| (55-68) D | | |
| (39-54) E | | |
| (21-38) F | | |
| (1-20) G | | |
| Not energy efficient - higher running costs | | |
| England & Wales | EU Directive 2002/91/EC | |