



Oak Lodge Bayeux Oaks Road

Kimpton, SG4 8EL

Oak Lodge forms part of a brand new development of 5 properties with stunning views across farmland. Close to the lovely village of Kimpton with easy access to Harpenden, Hitchin and Welwyn Garden City, these spacious houses boast a high quality internal specification and attractive exterior elevation. To fully appreciate the calibre of these homes we recommend viewing.

£1,100,000

Oak Lodge Bayeux Oaks Road

Kimpton, SG4 8EL



- Superb Brand New Four Bedroom Property
- Beautiful Rural Location
- Views across Farmland
- Single Storey Living
- High quality internal specification
- Close to Kimpton and easy access to Harpenden, Hitchin and Welwyn Garden City
- Spacious Kitchen/Dining/Living Room
- Access to Lovely countryside walks

Entrance Hall

Kitchen/Dining/Living Room

33'5" x 24'0" (10.19 x 7.32)

Utility Room

8'8" x 6'11" (2.66 x 2.11)

Bedroom One

18'0" x 12'11" (5.50 x 3.94)

Walk-in Wardrobe

8'7" x 6'6" (2.62 x 2)

En-suite Shower

Bedroom Two

14'0" x 13'3" (4.29 x 4.06)

En-Suite Shower

Bedroom Three

12'6" x 12'4" (3.83 x 3.76)

En-Suite Shower

Family Room/Bedroom Four

12'9" x 10'6" (3.91 x 3.22)

Bathroom



[Directions](#)



Ground Floor

Approx. 159.7 sq. metres (1719.4 sq. feet)

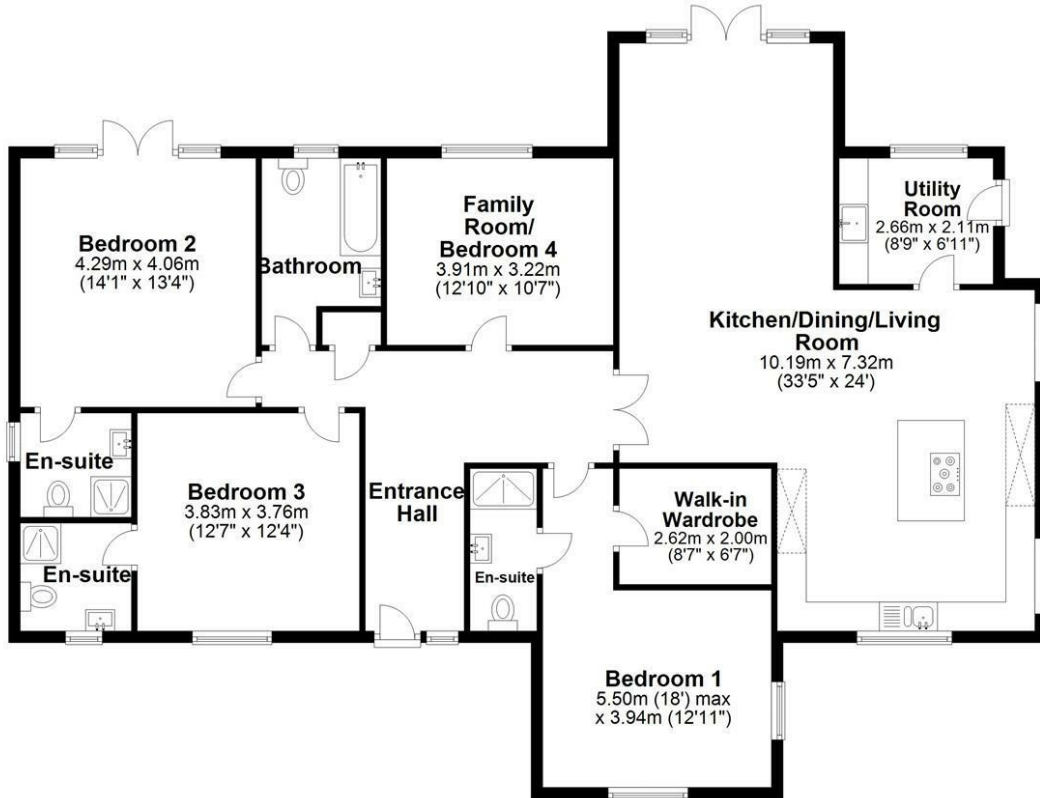

Total area: approx. 159.7 sq. metres (1719.4 sq. feet)

Sketch layout only. Not to scale. Plan produced for Whittaker & Co.

Plan produced using PlanUp.

These particulars, whilst believed to be accurate are set out as a general outline only for guidance and do not constitute any part of an offer or contract. Intending purchasers should not rely on them as statements of representation of fact, but must satisfy themselves by inspection or otherwise as to their accuracy. No person in this firm's employment has the authority to make or give any representation or warranty in respect of the property.

