



2 Probyn Close Hitchin, SG4 8BL

A well presented modern semi-detached house that incorporates a very good specification, set in a quiet cul-de-sac setting on the border of open countryside.

This is a shared ownership home and we are selling an 80% share of the RICS valuation which was £420,000. The freeholder is Hightown Housing Association and you will pay them a monthly rent of £252.17 on the 20% share that they have ownership of.

A 'Key information' file for potential buyers, incorporating an eligibility guide, is available by request.

Price £336,000

2 Probyn Close

Hitchin, SG4 8BL



- Constructed by Croudace Homes, this is and equity share home and you are buying an 80% share
- Well equipped kitchen/diner incorporating fridge/freezer, washing machine, dishwasher, electric oven and gas hob
- Gas fired central heating, double glazing and PV solar panels
- Leasehold: 99 year term from 2016, monthly payment (excluding rent) 20.52
- Two double bedrooms and a tastefully fitted family bathroom
- Harpenden (4.4 miles), Wheathampstead (3.2 miles), Hitchin TC (8.3 miles)
- Entrance hall, cloakroom wc and attractive living room
- Car port and paved drive, Front and rear gardens
- Highly regarded village with excellent Budgens store/post office, coffee shop and a huge range of clubs and leisure pursuits

GROUND FLOOR

Entrance Hall

Living Room

12'11 x 11'4 (3.94m x 3.45m)

Cloakroom/WC

Kitchen/Diner

14'6 x 13'3 (4.42m x 4.04m)

FIRST FLOOR

Landing

Bedroom One

14'7 x 10'2 (4.45m x 3.10m)

Bedroom Two

14'6 x 9' (4.42m x 2.74m)

Bathroom

EXTERNALLY

Car Port

16'3 x 9' (4.95m x 2.74m)

Paved Drive

Front Garden

Rear Garden

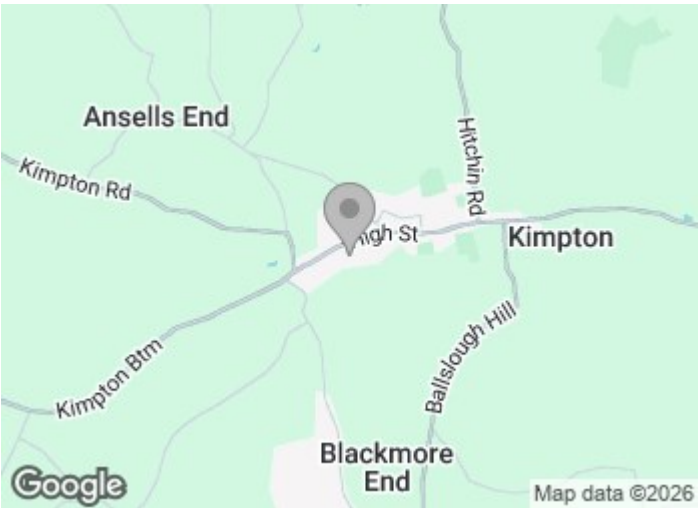

Directions



Floor Plan

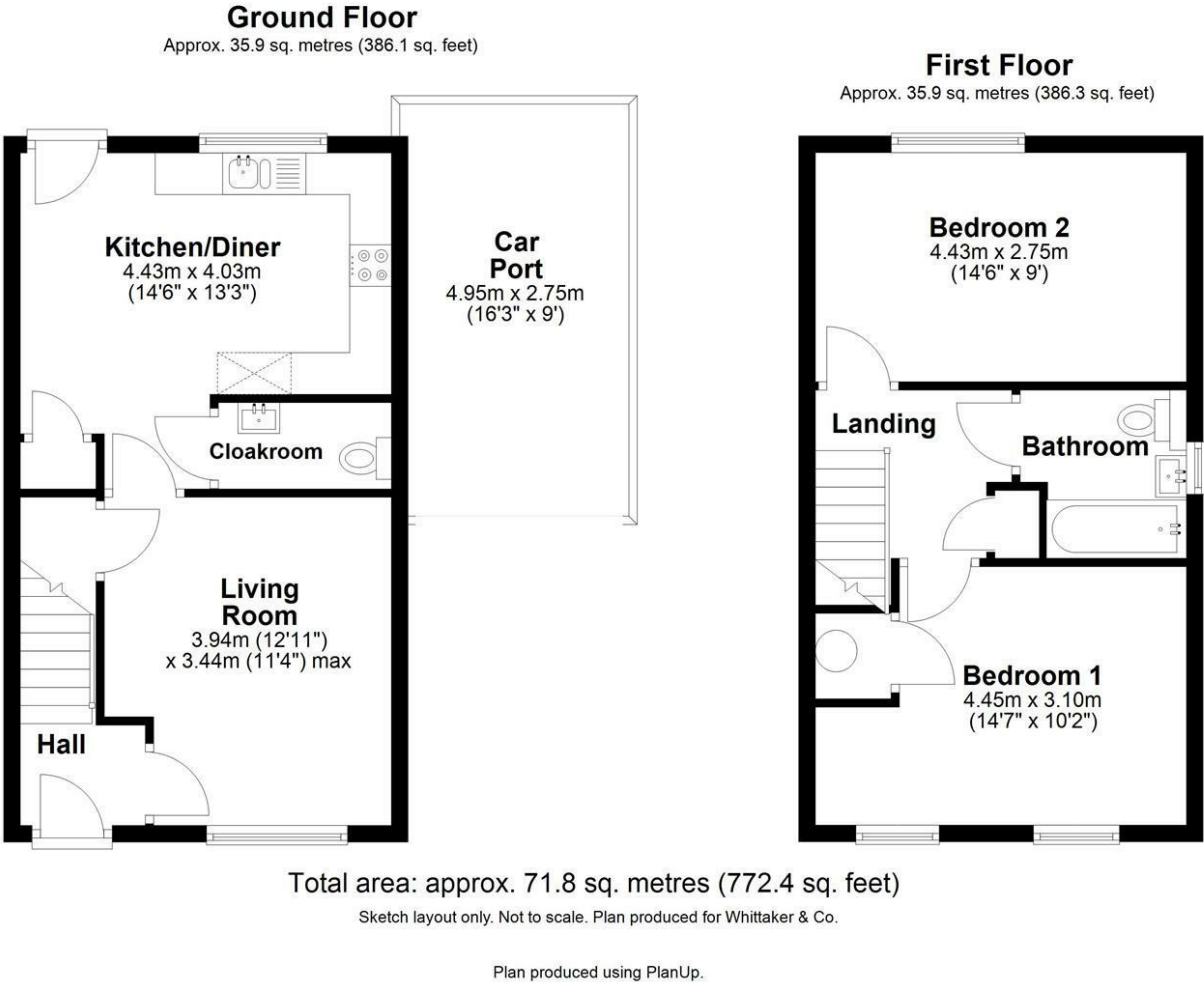

These particulars, whilst believed to be accurate are set out as a general outline only for guidance and do not constitute any part of an offer or contract. Intending purchasers should not rely on them as statements of representation of fact, but must satisfy themselves by inspection or otherwise as to their accuracy. No person in this firms employment has the authority to make or give any representation or warranty in respect of the property.

