



## Aldwickbury Crescent

Harpenden, AL5 5RR

Detached four-bedroom family home of circa 1600 sq ft with a fabulous 115ft south facing garden and a self-contained annex/studio. Benefiting from a private driveway this property is ideally located for excellent schooling and close to the station and town centre. Huge potential to extend (STPP).

**Guide price £950,000**

# Aldwickbury Crescent

Harpenden, AL5 5RR



- Detached family home
- South facing 115ft garden
- Ideally located for excellent schooling
- Private driveway
- Self contained annex/studio
- Short walk to town centre and station
- Huge potential to extend (STPP)
- Four bedrooms
- Council Tax Band F

## Entrance Hall

## Study

7'11" x 7'4" (2.42m x 2.26m)

## Kitchen

12'5" x 8'0" (3.80m x 2.46m)

## Dining Room

10'0" x 9'4" (3.05m x 2.86m )

## Living Room

20'11" x 12'10" (6.38 x 3.93m )

## Conservatory

9'2" x 9'1" (2.80m x 2.77 )

## Cloakroom

## Landing

## Bedroom One

13'8" x 11'5" (4.18m x 3.48m )

## En-suite Bathroom

## Bedroom Two

11'5" x 10'7" (3.50m x 3.25m )

## Bedroom Three

12'1" x 7'7" (3.69m x 2.33m)

## Bedroom Four

10'7" x 6'11" (3.25m x 2.13m )

## Family Shower Room

## Studio

20'6" x 7'2" (6.26m x 2.19m )

## Shower Room

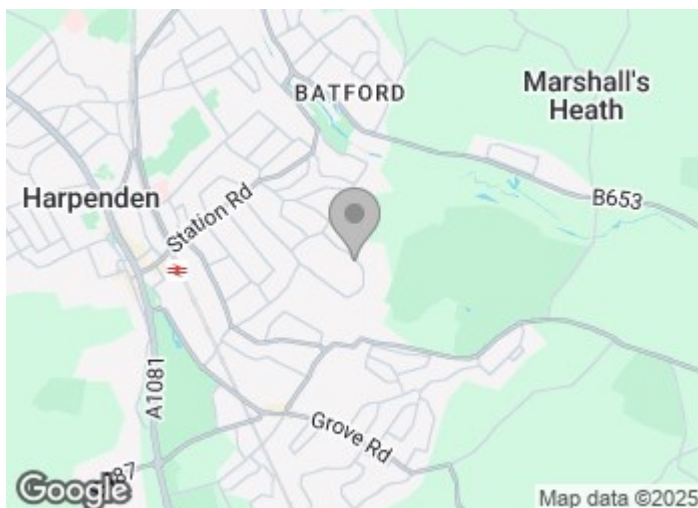





Floor Plan

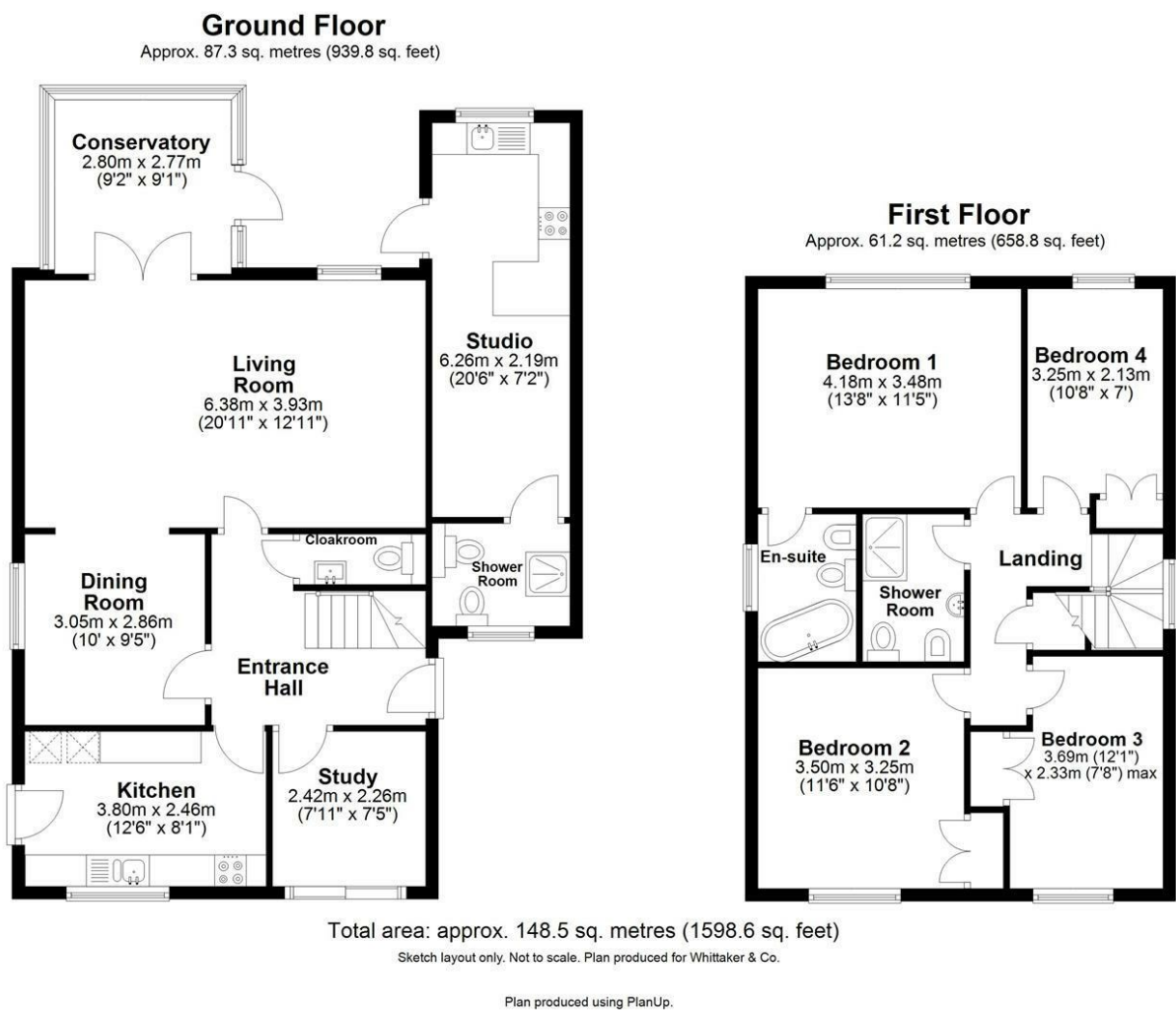

These particulars, whilst believed to be accurate are set out as a general outline only for guidance and do not constitute any part of an offer or contract. Intending purchasers should not rely on them as statements of representation of fact, but must satisfy themselves by inspection or otherwise as to their accuracy. No person in this firms employment has the authority to make or give any representation or warranty in respect of the property.

