



Walnut Close

Harpenden, AL5 4FP

A superb four bedroom detached family home arranged over three floors with an integral garage and driveway, located in a sought after cul-de-sac within easy reach of excellent schools, town centre and station. ** CHAIN FREE **

Guide price £1,750,000

Walnut Close

Harpenden, AL5 4FP



- Superb detached family home circa 2650 sq ft
- Popular cul-de-sac
- Within easy reach of the town centre and station.
- Arranged over three floors
- Private Garden
- Council Tax Band G
- Large Kitchen/Family Room
- Easy reach to excellent schools
- **CHAIN FREE**

Entrance Hall

Cloakroom

Living Room

11'7" x 11'6" (3.55m x 3.53m)

Kitchen/Family/Dining Room

27'6" x 21'9" (8.39m x 6.64m)

Utility Room

9'2" x 7'3" (2.80m x 2.21m)

Bedroom One

27'6" x 17'4" (8.39m x 5.29m)

Dressing Area

En suite Shower

Bedroom Two

15'8" x 13'7" (4.79m x 4.15m)

Bedroom Three

14'8" x 13'6" (4.49m x 4.14m)

Bath and Shower Room

Bedroom Four/Study

19'10" x 12'5" (6.05m x 3.81m)

Bath and Shower Room

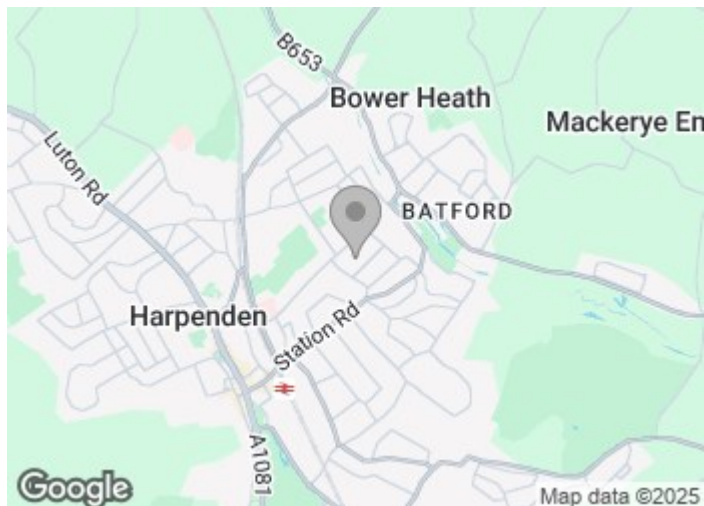



Floor Plan

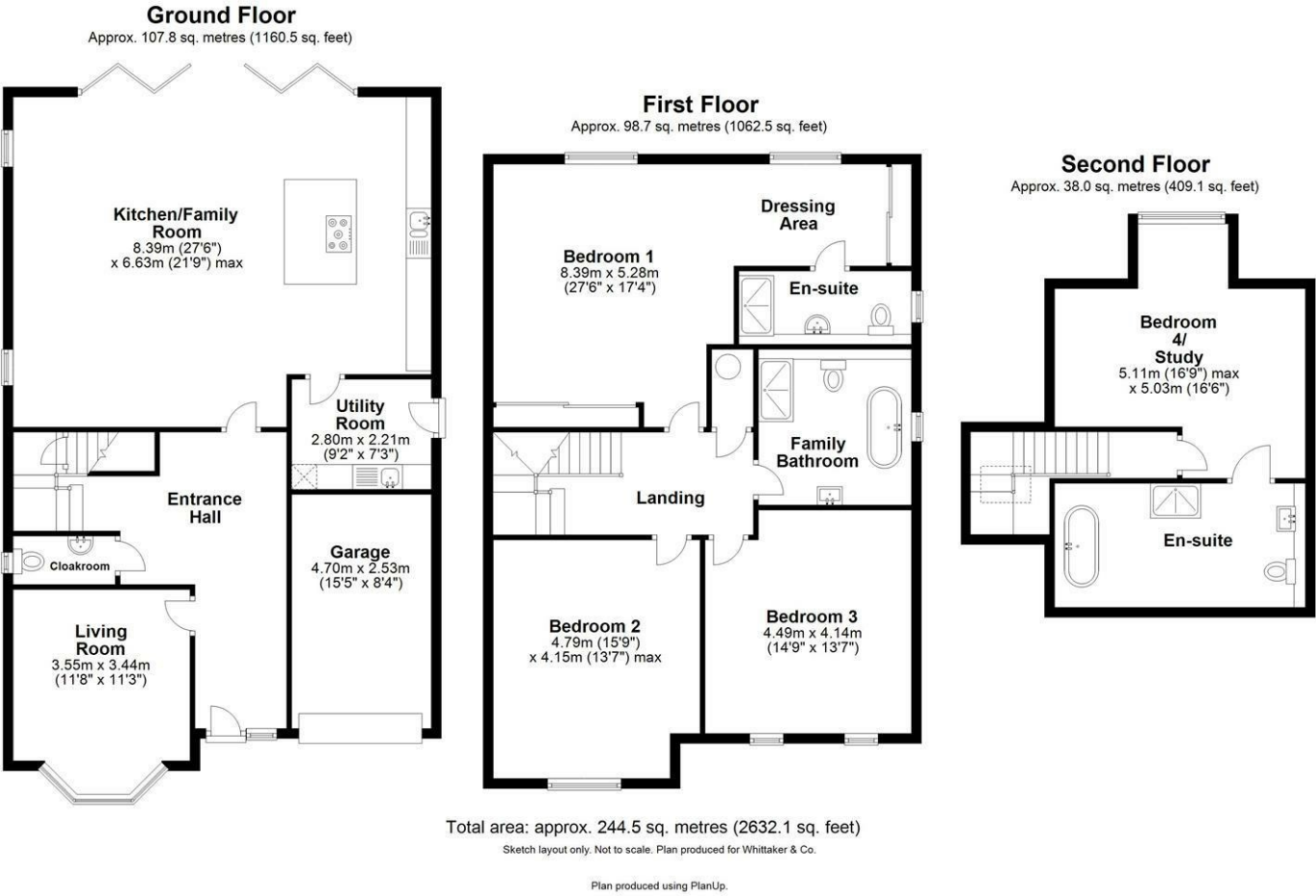

These particulars, whilst believed to be accurate are set out as a general outline only for guidance and do not constitute any part of an offer or contract. Intending purchasers should not rely on them as statements of representation of fact, but must satisfy themselves by inspection or otherwise as to their accuracy. No person in this firms employment has the authority to make or give any representation or warranty in respect of the property.

