



## 6 Grove Avenue

Harpenden, AL5 1EX

A three bedroom semi-detached period home offering superb potential for extension and renovation STPP. The property boasts a 95ft garden of a Southerly aspect as well as off-street parking for multiple vehicles. Close to outstanding local schools and the amenities of Southdown, whilst remaining within walking distance of Harpenden and beautiful open countryside. \*CHAIN FREE\*

**Guide price £750,000**

# 6 Grove Avenue

## Harpenden, AL5 1EX



- Charming three bedroom semi-detached period home
- Recently renovated Kitchen & Shower room
- Walking distance of Harpenden and beautiful open countryside
- Superb potential for extension STPP
- Off-street parking for multiple vehicles
- Council tax band E
- 95ft rear garden of a Southerly aspect
- Close to outstanding local schools and the amenities of Southdown
- Chain-free

### Porch

### Entrance Hall

### Cloakroom

### Kitchen

11'6" x 7'3" (3.52m x 2.23m)

### Lean to

17'1" x 5'3" (5.21m x 1.62m)

### Living Room

12'5" max x 12'0" (3.80m max x 3.68m)

### Dining Room

15'1" x 12'0" (4.60m x 3.68m)

### Conservatory

15'9" max x 13'8" max (4.82m max x 4.17m max)

### Bedroom One

13'6" x 10'5" (4.13m x 3.20m)

### Bedroom Two

12'1" x 10'5" (3.69m x 3.20m)

### Bedroom Three

11'7" x 7'4" (3.54m x 2.24m)

### Bathroom

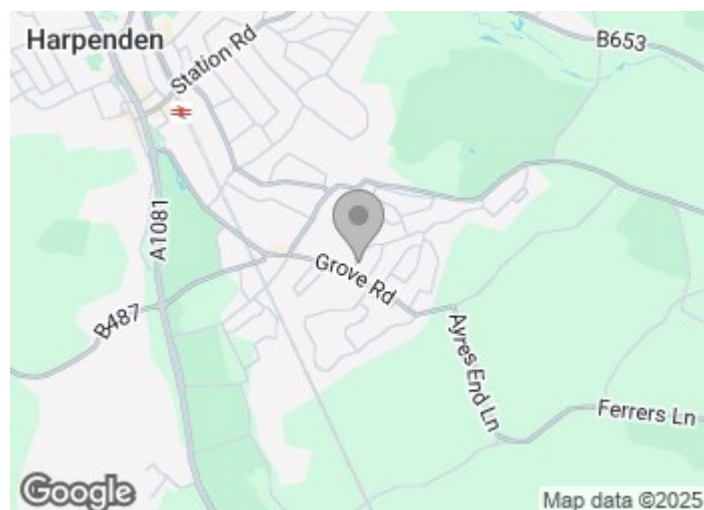

### Directions







Floor Plan

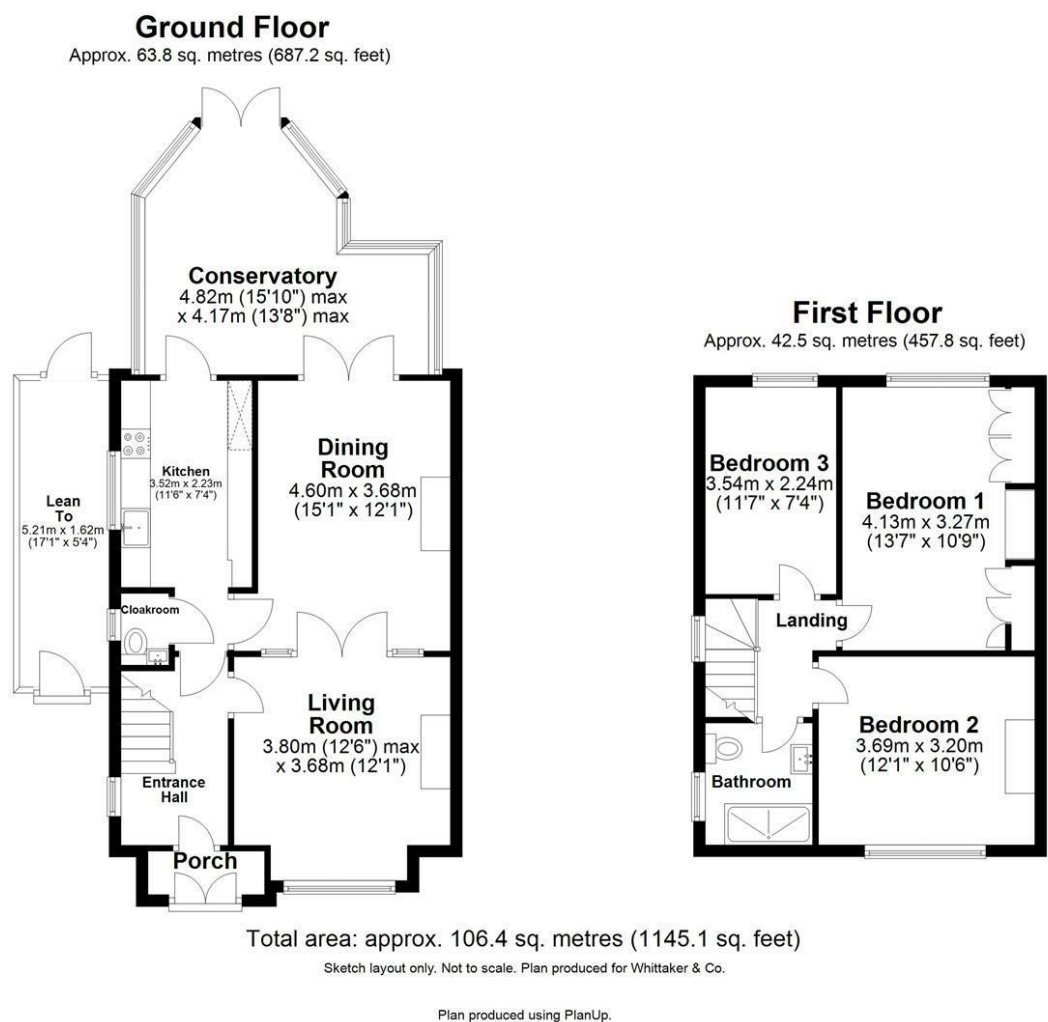

These particulars, whilst believed to be accurate are set out as a general outline only for guidance and do not constitute any part of an offer or contract. Intending purchasers should not rely on them as statements of representation of fact, but must satisfy themselves by inspection or otherwise as to their accuracy. No person in this firms employment has the authority to make or give any representation or warranty in respect of the property.

