



Townsend Road

Harpenden, AL5 4BG

Character Victorian Villa, circa 2,670 sq ft with many original features and huge potential for refurbishment and extension (STPP). The property benefits from a lovely garden of over 78ft long and 61 ft at its widest point. **DETACHED GARAGE AND DRIVEWAY** accessed from Wordsworth Road. Ideally located for excellent schools, Harpenden station and town centre.

Guide price £1,250,000

Townsend Road

Harpenden, AL5 4BG



- Character Victorian Villa, circa 2,670 sq ft
- Huge potential for refurbishment and extension (STPP)
- Great location for excellent schooling
- Five Bedrooms
- DETACHED GARAGE AND OFF STREET PARKING
- Close to Harpenden station and town centre
- Many original features
- Lovely garden of over 78ft long
- Council Tax Band G

Entrance Hall

Living Room

15'5" x 14'8" (4.72m x 4.48m)

Dining Room

15'5" x 14'8" (4.72m x 4.48m)

Cloakroom

Morning Room

11'10" x 10'5" (3.61m x 3.18m)

Kitchen/Breakfast Room

11'11" x 11'10" (3.64m x 3.61m)

Utility Room

Store

Bedroom One

19'5" x 15'5" (5.94m x 4.72m)

Bedroom Two

15'0" x 12'11" (4.59m x 3.96m)

Bedroom Three

19'10" x 8'10" (6.06m x 2.70m)

Bedroom Four

11'11" x 8'0" (3.65m x 2.44m)

Bathroom

WC

Bedroom Five

18'7" x 16'1" (5.68m x 4.91m)

Loft Storage

Garage at Rear

15'9" x 7'11" (4.81m x 2.43m)





Floor Plan

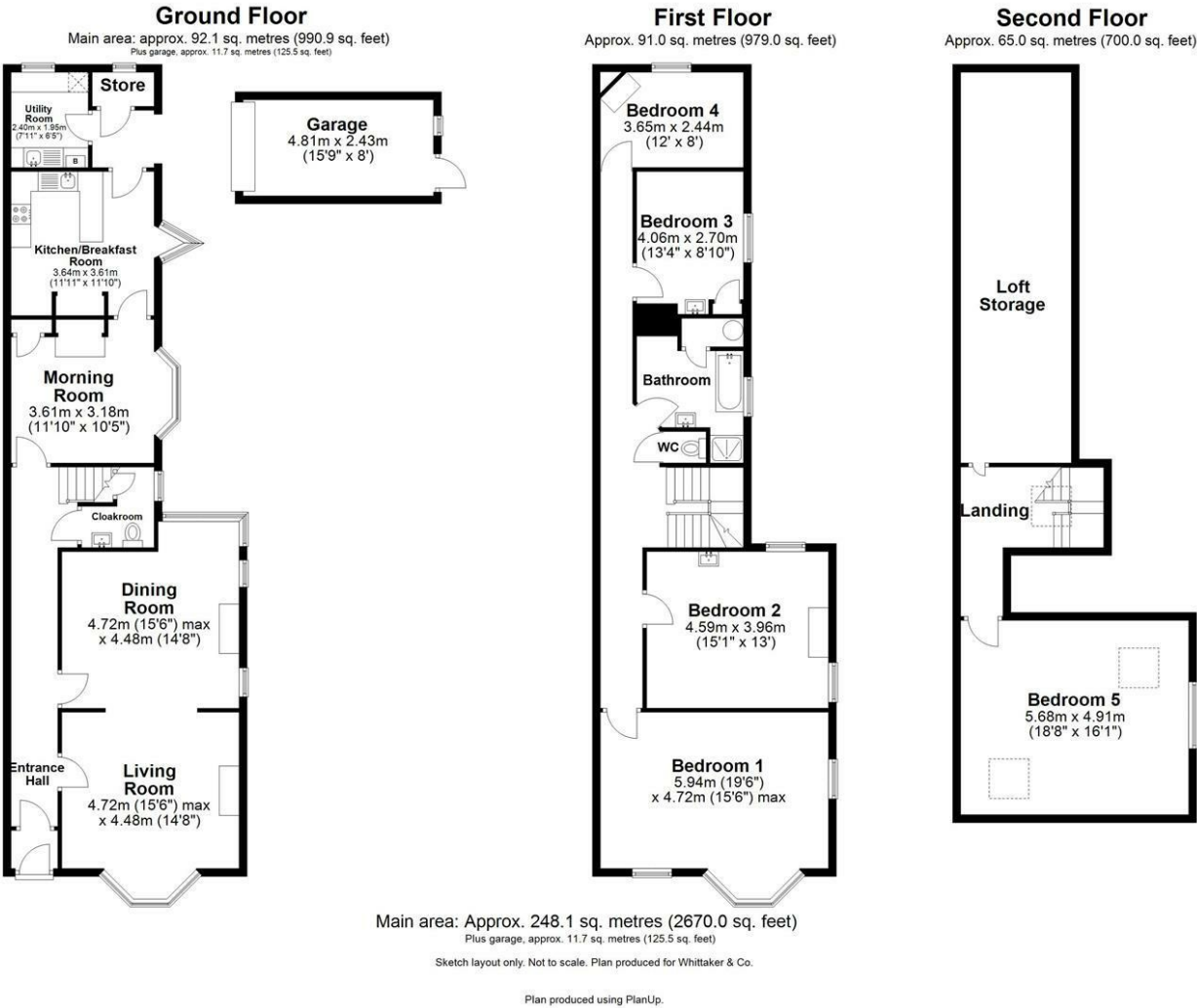

These particulars, whilst believed to be accurate are set out as a general outline only for guidance and do not constitute any part of an offer or contract. Intending purchasers should not rely on them as statements of representation of fact, but must satisfy themselves by inspection or otherwise as to their accuracy. No person in this firms employment has the authority to make or give any representation or warranty in respect of the property.

