



Grove Avenue

Harpenden, AL5 1EX

Immaculately presented family home of circa 1,800 sq ft. Open plan living space opening onto the 95ft garden plus a separate Family Room. A peaceful location, close to both the amenities of Southdown and open countryside. Well placed for schooling and within easy reach of Harpenden town centre

Guide price £1,000,000

Grove Avenue

Harpenden, AL5 1EX



- Circa 1,800 sq ft
- Open plan living space
- Garden 95ft
- Garage & off-street parking
- Close to amenities of Southdown
- Well placed for schooling
- Within easy reach of Harpenden town centre
- Close to open countryside

Entrance Hall

Living Room

25'8" x 11'10" (7.83 x 3.63)

Kitchen / Dining Room

22'4" x 14'10" (6.81 x 4.54)

Family Room

11'10" x 11'10" (3.63 x 3.61)

Utility / Cloakroom

Bedroom One

14'6" x 11'10" (4.43 x 3.62)

Bedroom Two

11'11" x 10'4" (3.64 x 3.17)

Shower Room

Bedroom Three

11'10" x 8'11" (3.63 x 2.74)

Bedroom Four

11'7" x 8'10" (3.55 x 2.71)

Family Bathroom

Bedroom Five / Office

8'1" x 7'1" (2.47 x 2.17)

Integral Garage

11'7" x 9'6" (3.55 x 2.92)

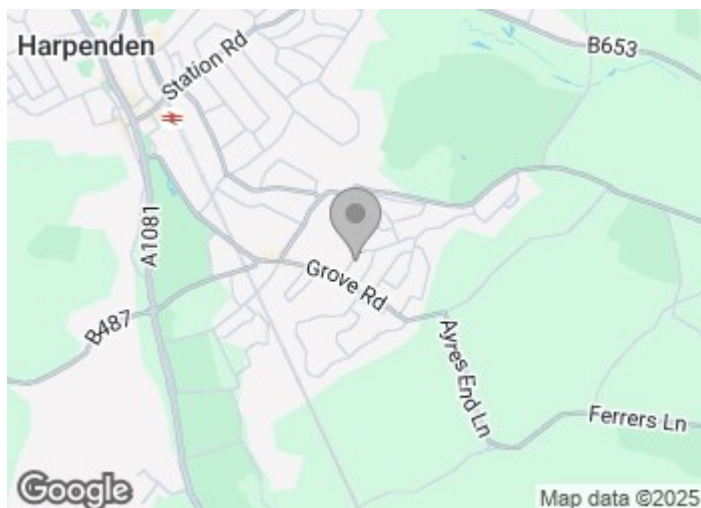



Floor Plan

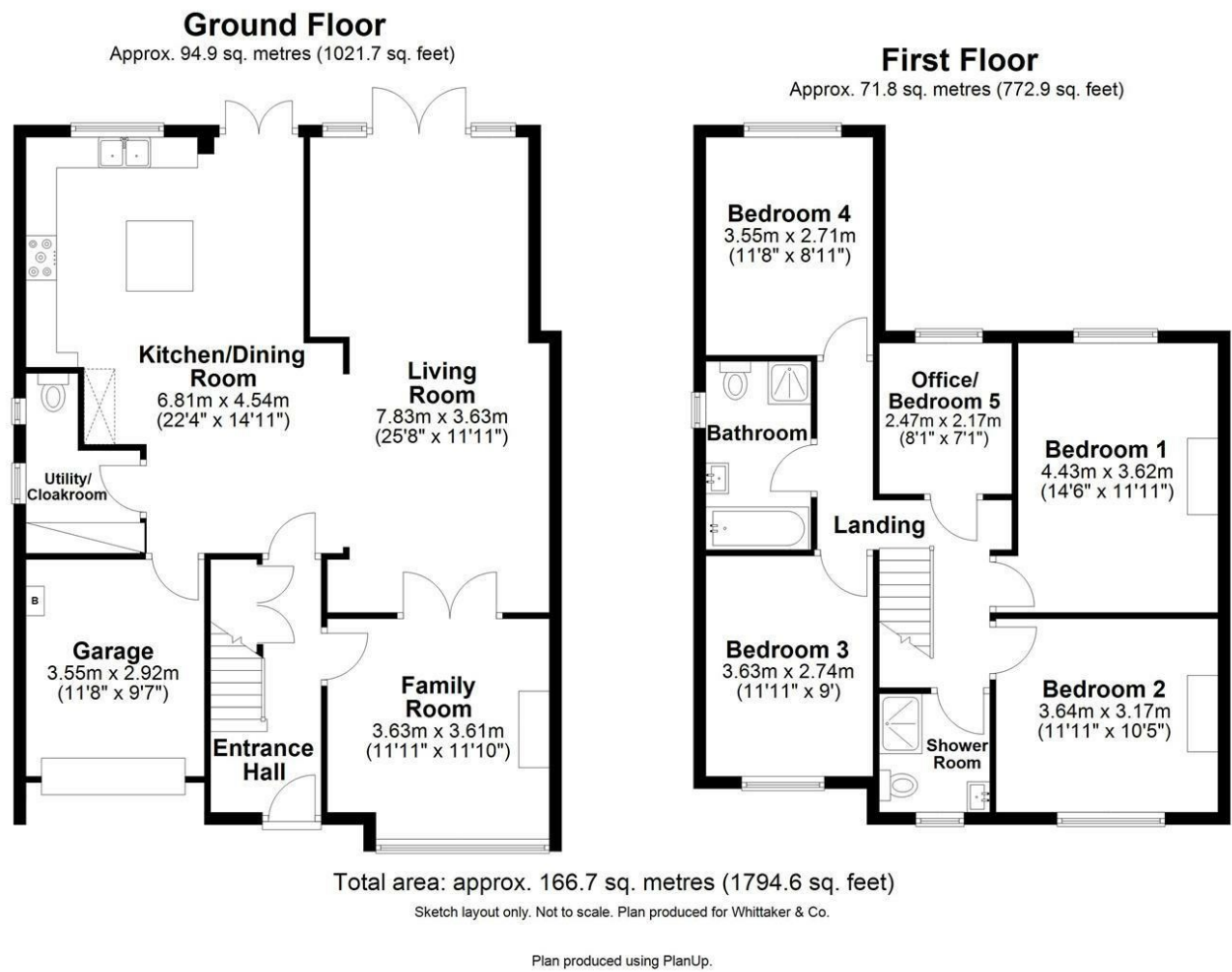

These particulars, whilst believed to be accurate are set out as a general outline only for guidance and do not constitute any part of an offer or contract. Intending purchasers should not rely on them as statements of representation of fact, but must satisfy themselves by inspection or otherwise as to their accuracy. No person in this firms employment has the authority to make or give any representation or warranty in respect of the property.

