

Baulk Close

Harpenden, AL5 4FJ

Well presented family home with driveway and open plan living space, leading onto the c.40ft south facing garden. Close to stunning countryside, within walking distance of Harpenden town centre and station and well placed for schooling.

£700,000

Baulk Close

Harpenden, AL5 4FJ



- Circa 1,200 sq ft
- Open plan living space
- Well presented family home
- Garden circa 40ft, south facing
- Off-street parking
- Well placed for schooling
- Close to town centre & station
- Newly decorated throughout
- Council Tax Band E

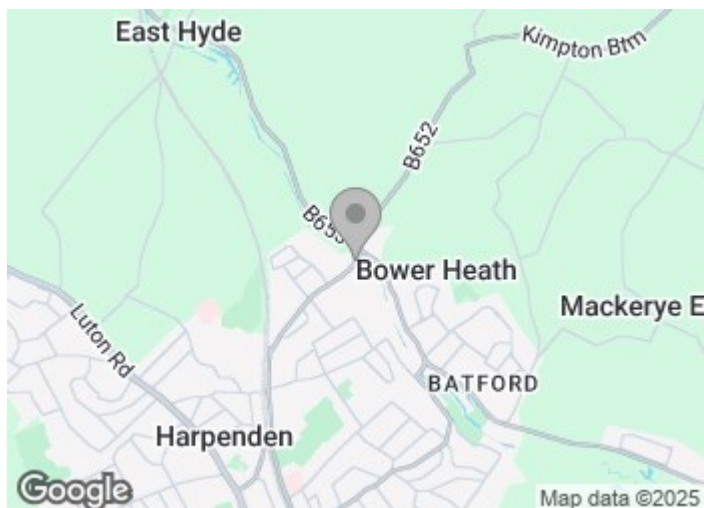



Floor Plan

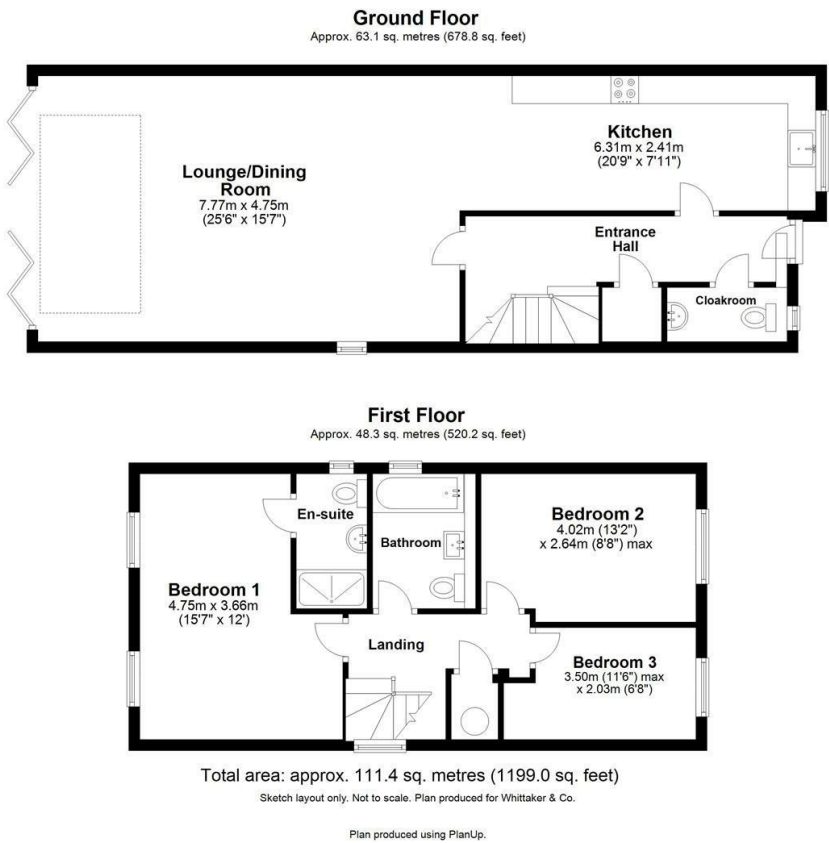

These particulars, whilst believed to be accurate are set out as a general outline only for guidance and do not constitute any part of an offer or contract. Intending purchasers should not rely on them as statements of representation of fact, but must satisfy themselves by inspection or otherwise as to their accuracy. No person in this firms employment has the authority to make or give any representation or warranty in respect of the property.

