



## Chestnut Cottage Crown Street

Redbourn, AL3 7LQ

Newly refurbished cottage in the heart of Redbourn village with a private courtyard garden. Renovated to a high specification by a local builder.

**£1,550**

# Chestnut Cottage Crown Street

Redbourn, AL3 7LQ



- New Refurbished Cottage
- High Specification
- Close to the village centre
- Easy access into Harpenden
- Available to let immediately

## Lounge/Dining Room

23'7" x 11'3" (7.19m x 3.44m)

## Cloakroom

## Kitchen/Breakfast Room

12'8" x 9'3" (3.88m x 2.82m)

## Bedroom

14'10" x 11'3" (4.54m x 3.44m)

## Bathroom

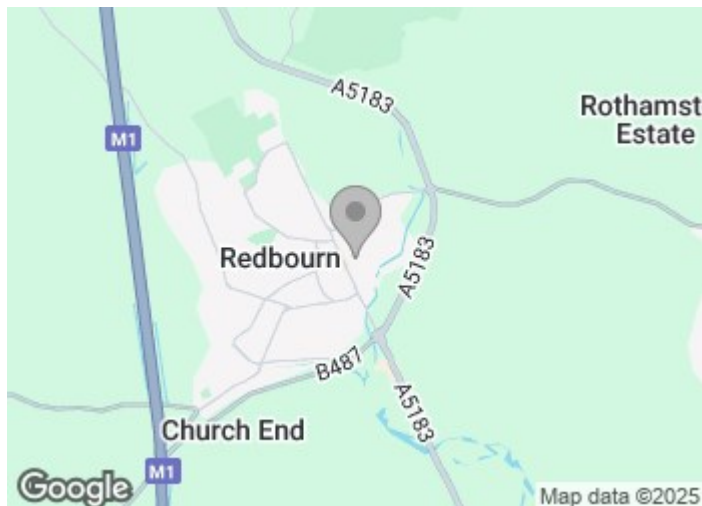





Floor Plan

**Ground Floor**  
Approx. 34.5 sq. metres (370.9 sq. feet)



**First Floor**  
Approx. 23.6 sq. metres (254.3 sq. feet)

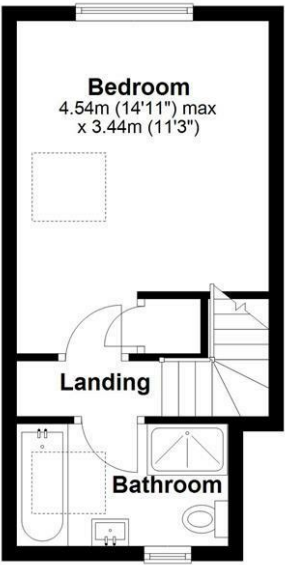

Total area: approx. 58.1 sq. metres (625.1 sq. feet)  
Sketch layout only. Not to scale. Plan produced for Whittaker & Co.

Plan produced using PlanUp.

These particulars, whilst believed to be accurate are set out as a general outline only for guidance and do not constitute any part of an offer or contract. Intending purchasers should not rely on them as statements of representation of fact, but must satisfy themselves by inspection or otherwise as to their accuracy. No person in this firms employment has the authority to make or give any representation or warranty in respect of the property.

