



Park Mount

Harpenden, AL5 3AR

Well presented four bedroom character family home, circa 1700 sq ft. Situated in a highly regarded part of Harpenden, ideally located for excellent schooling, within a short walk of the town centre, the station and the popular Nickey Line.

Guide price £1,095,000

Park Mount

Harpenden, AL5 3AR



- Character home circa 1700 sq ft
- Versatile living space
- Southerly aspect garden
- Ideally located for excellent schooling
- Within a short walk of the town centre and the station
- Close to the fabulous Nickey Line
- Integral garage and driveway
- Council Tax Band G

Porch

Entrance Hall

Living Room

14'2" x 12'3" (4.32m x 3.75m)

Family Room

13'9" x 11'3" (4.21m x 3.45m)

Kitchen/Dining Room

27'3" max x 17'1" max (8.31m max x 5.21m max)

Cloakroom

Utility Room

Bedroom One

13'6" x 9'11" (4.13m x 3.04m)

En-suite Shower

Bedroom Two

15'1" x 11'5" (4.61m x 3.50m)

Bedroom Three

13'0" x 11'5" (3.97m x 3.50m)

Bedroom Four

9'5" x 5'5" (2.88m x 1.66m)

Bathroom

Integral Garage

14'10"x 8'7" (4.53mx 2.62m)

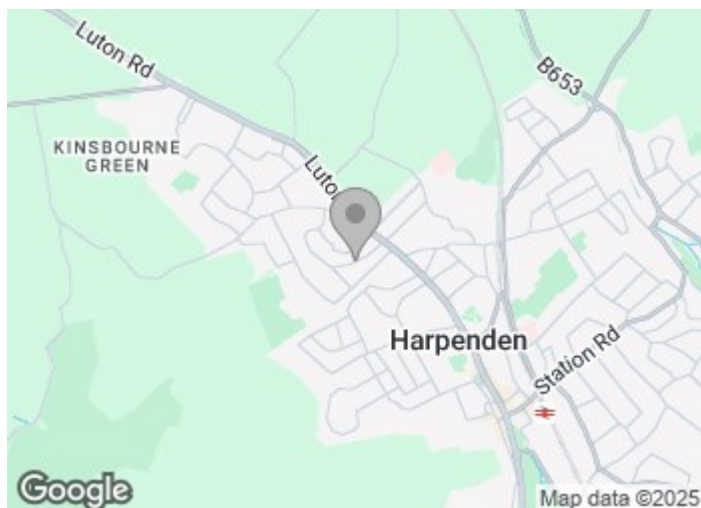



Floor Plan

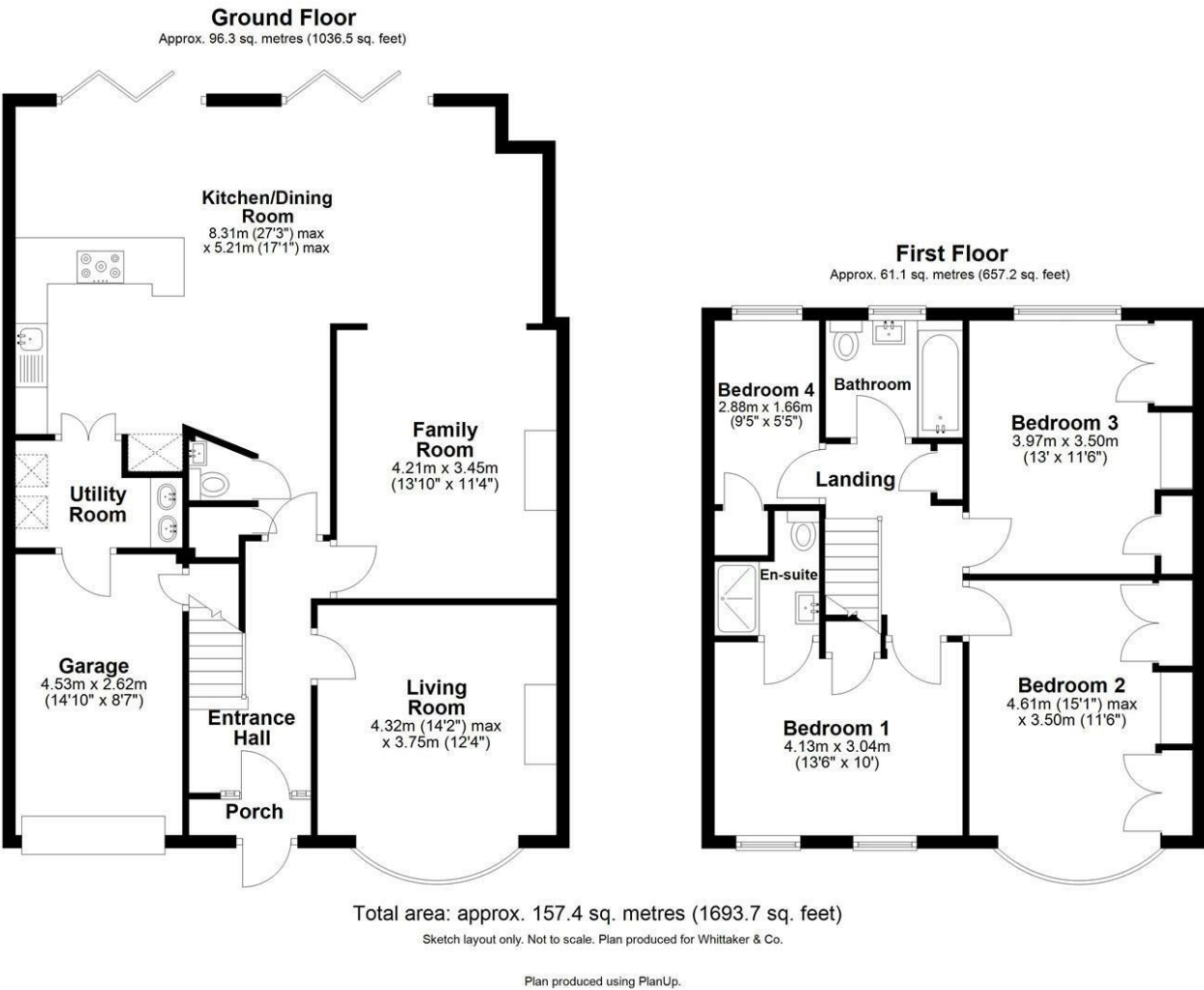

These particulars, whilst believed to be accurate are set out as a general outline only for guidance and do not constitute any part of an offer or contract. Intending purchasers should not rely on them as statements of representation of fact, but must satisfy themselves by inspection or otherwise as to their accuracy. No person in this firms employment has the authority to make or give any representation or warranty in respect of the property.

