



## Maple Road

Harpenden, AL5 2DS

Beautiful five bedroom, period home of circa 2500 sq ft in a prime central location in the Avenues. Arranged over three floors, with generous reception and entertaining space, home office and off-street parking. This superb property is situated on a plot of 0.19 acre and has a mature garden of 85ft x 65ft wide. Scope to extend (STPP) \*CHAIN FREE\*

**Guide price £2,000,000**

# Maple Road

Harpenden, AL5 2DS



- Stunning period home circa 2,500 sq ft
- Home Office
- Scope to extend (STPP)
- Arranged over three floors
- Prime central Avenues location
- CHAIN FREE
- Plot of 0.19 acre with mature garden
- Off-street parking
- Council Tax Band G

## Entrance Hall

## Living Room

14'6" x 13'10" (4.44m x 4.24m )

## Family Room

16'6" max x 13'10" (5.04m max x 4.24m)

## Kitchen/Dining Room

26'10" x 14'3" (8.20m x 4.36m)

## Cloakroom

## Bedroom One

15'1" x 13'10" (4.60m x 4.24m)

## Bedroom Two

13'10" x 12'11" (4.24m x 3.95m)

## Bedroom Three

12'11" x 11'5" (3.94m x 3.50m)

## Bathroom

## Bedroom Four

13'9" x 11'4" max (4.21m x 3.46m max)

## Bedroom Five

13'10" x 11'6" max (4.24m x 3.52m max)

## Bath and Shower Room

## Study Area

## Cellar

12'8" x 8'0" (3.88m x 2.44m)

## Home Office

13'1" x 10'0" (4m x 3.06m)







## Floor Plan

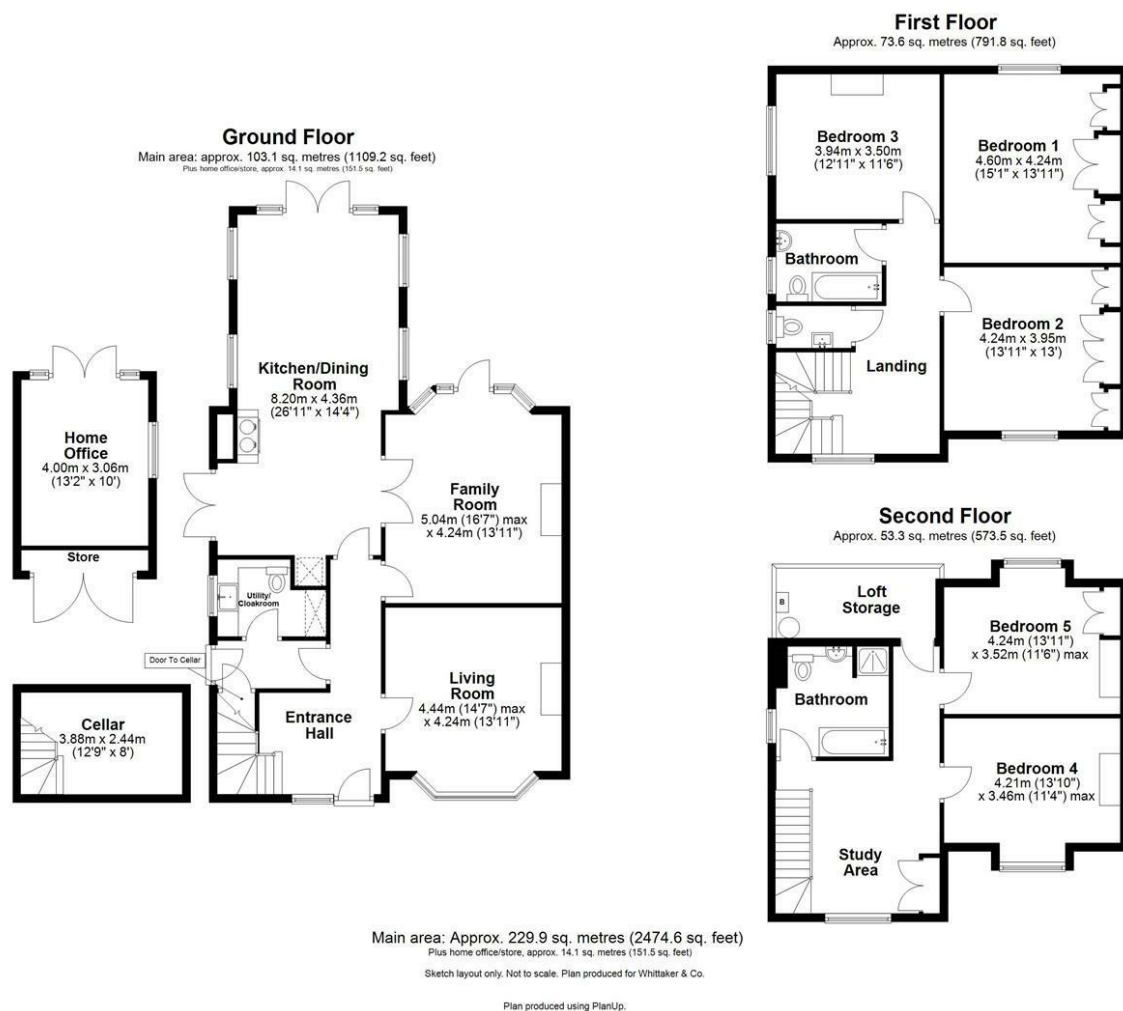

These particulars, whilst believed to be accurate are set out as a general outline only for guidance and do not constitute any part of an offer or contract. Intending purchasers should not rely on them as statements of representation of fact, but must satisfy themselves by inspection or otherwise as to their accuracy. No person in this firm's employment has the authority to make or give any representation or warranty in respect of the property.

