



## Wood End Hill

Harpenden, AL5 3EZ

Beautifully presented four bedroom family home with spacious open plan layout, boot room and craft room. Located in a sought after, quiet residential area close to open countryside and ideally located for excellent schools. Delightful, well stocked 130ft southerly aspect private garden.

**Guide price £2,250,000**

# Wood End Hill

Harpenden, AL5 3EZ



- Circa 3,000 sq ft
- 130ft southerly aspect garden
- Possibility to easily create a fifth bedroom
- Council Tax Band G
- Ideally located close to excellent schooling
- Fabulous open plan kitchen, living and dining room
- 0.26 acres
- Beautifully finished throughout
- Versatile ground floor space including boot room and craft room

## Entrance Hall

## Study

12'5" x 11'4" (3.80m x 3.47m)

## Lounge Area

17'4" x 19'11" (5.29m x 6.08m)

## Dining Area

16'4" x 12'2" (5m x 3.71m)

## Kitchen/Breakfast Room

21'8" x 13'6" (6.61m x 4.12m)

## Boot Room

8'7" x 8'11" (2.63m x 2.72m)

## Utility Room

6'4" x 6'9" (1.95m x 2.08m)

## Crafts Room

12'9"x 7'5" (3.91mx 2.27m)

## Shower Room

## Garage Store

## Bedroom One

25'0" x 12'2" (7.64m x 3.71m)

## Walk-in Wardrobe

## En-suite Bath and Shower Room

## Bedroom Two

15'8" x 15'3" (4.80m x 4.67m)

## En-suite

## Bedroom Three

11'7" x 10'4" (3.55m x 3.17m)

## Bedroom Four

9'10" x 10'11" (3.02m x 3.35m)

## Bathroom

## Garage Store

9'6" x 6'11" (2.90m x 2.12m)

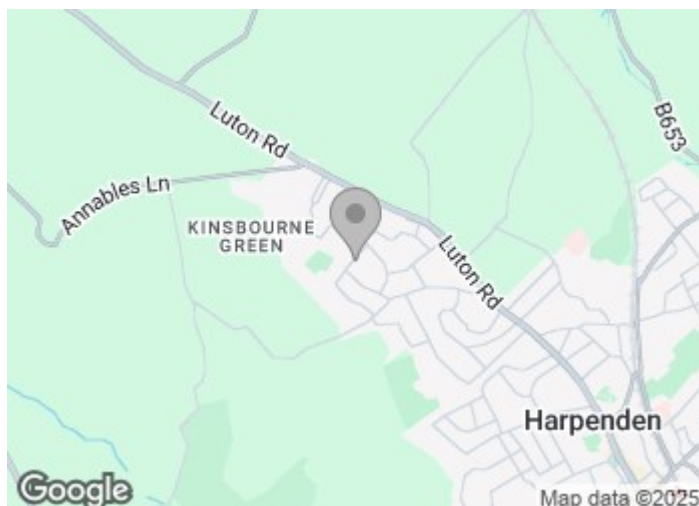





Floor Plan

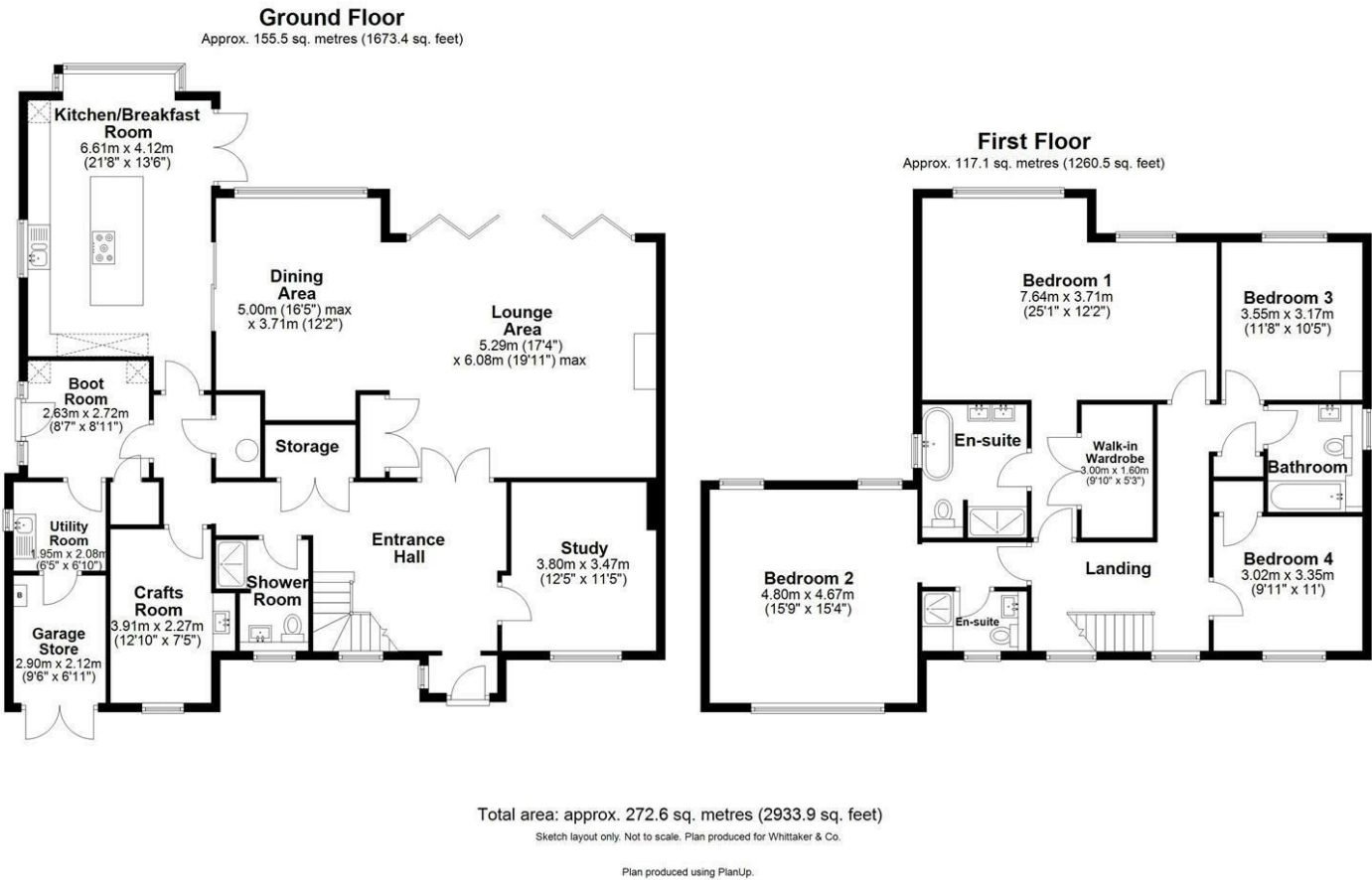

These particulars, whilst believed to be accurate are set out as a general outline only for guidance and do not constitute any part of an offer or contract. Intending purchasers should not rely on them as statements of representation of fact, but must satisfy themselves by inspection or otherwise as to their accuracy. No person in this firms employment has the authority to make or give any representation or warranty in respect of the property.

