



## 107 High Street

Kimpton, SG4 8QL

An impressive 3 bedroom family home with a well presented interior, which is located in a friendly Hertfordshire village. Notable features include a lovely fitted kitchen, stunning bathroom and a landscaped south facing rear garden with a range of timber outbuildings that include an insulated home office.

**Guide price £550,000**

# 107 High Street

## Kimpton, SG4 8QL



- Well presented terraced house, located in a sought after village location
- Living room with feature open fireplace , opens to a spacious dining area
- Off street parking for 3 to 4 cars
- Open plan lounge/dining room with open fireplace
- 3 double bedrooms, shower room and beautiful bathroom with whirlpool bath
- The village has a well regarded primary school, together with an excellent Budgens/post office , friendly village pub and coffee shop
- Modern fitted kitchen incorporating a gas hob, electric over, chimney extractor, dishwasher, fridge and freezer
- South facing landscaped rear garden with raised deck, insulated home office, summer house and generous workshop
- Wheathampstead (3.1 miles), Harpenden Station (4.2 miles), Hitchin Town Centre (8.7 miles)

### GROUND FLOOR

#### Entrance Hall

#### Living Room

13'1 x 12'9 (3.99m x 3.89m)

#### Dining Area

13'1 x 9'8 (3.99m x 2.95m)

#### Kitchen

10'9 x 10'8 (3.28m x 3.25m)

#### Bathroom

### FIRST FLOOR

#### Landing

#### Bedroom One

11'11 x 10'11 (3.63m x 3.33m)

#### Bedroom Two

12'5 x 9'4 (3.78m x 2.84m)

#### Bedroom Three

10'10 x 10'7 max (3.30m x 3.23m max)

#### Shower Room

### EXTERNALLY

#### Rear Garden

72' deep approx (21.95m deep approx)

#### Off Street Parking

### OUTBUILDINGS:

#### Workshop

18'3 x 8'6 (5.56m x 2.59m)

#### Home Office

9'10 x 7'7 (3.00m x 2.31m)

#### Summer House

6'8 x 4'6 (2.03m x 1.37m)

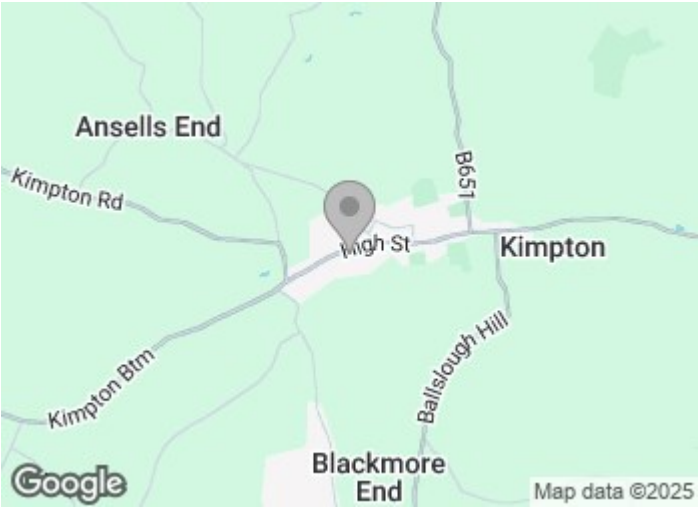

### Directions



Floor Plan

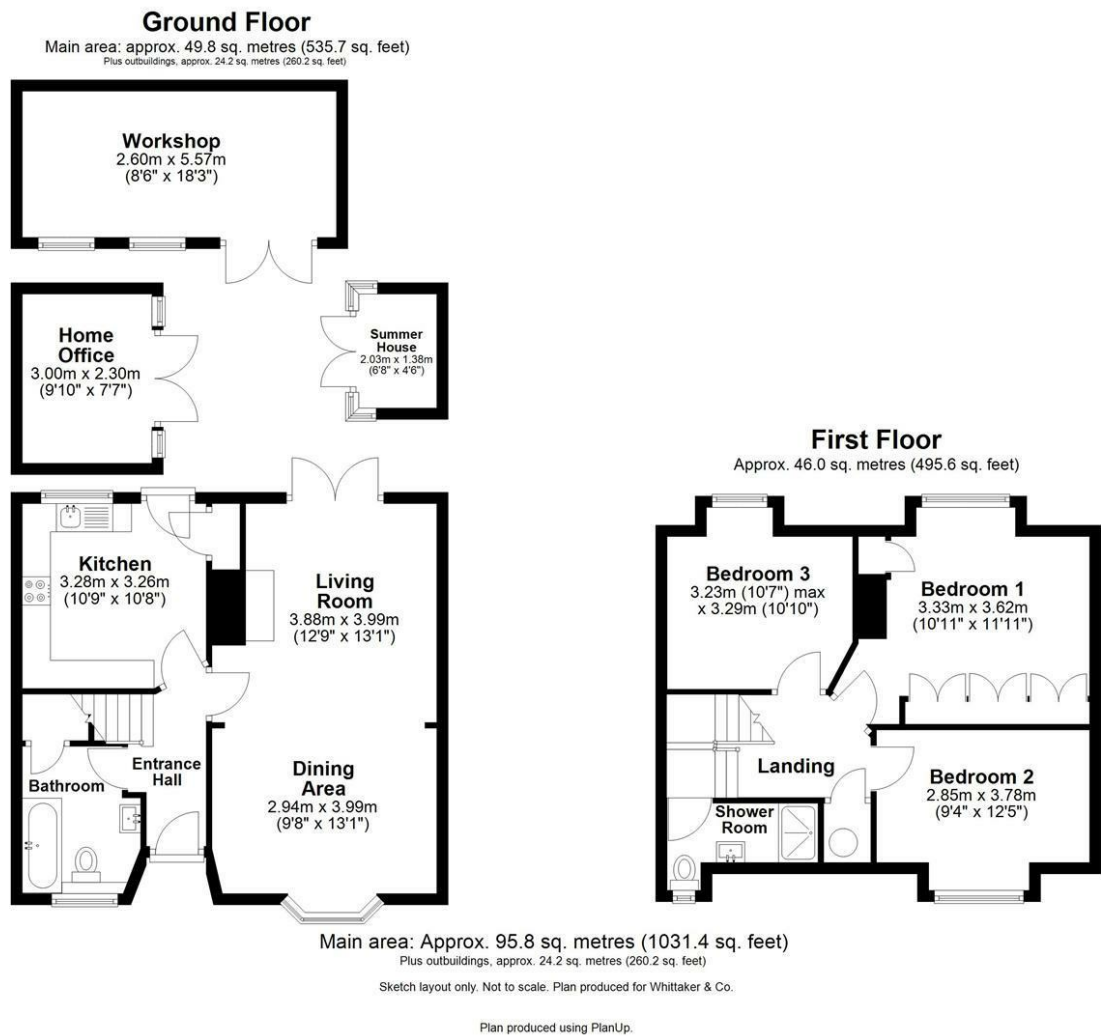

These particulars, whilst believed to be accurate are set out as a general outline only for guidance and do not constitute any part of an offer or contract. Intending purchasers should not rely on them as statements of representation of fact, but must satisfy themselves by inspection or otherwise as to their accuracy. No person in this firms employment has the authority to make or give any representation or warranty in respect of the property.

