



The Pleasance

Harpenden, AL5 3NA

An attractive detached family home located in this desirable residential road on the north side of the town centre. The Pleasance is a popular private road conveniently located for excellent schooling. Extremely well presented throughout, offering generously proportioned accommodation, ample off street parking and a detached double garage.

Price guide £1,300,000

The Pleasance

Harpenden, AL5 3NA



- Immaculately presented detached family home of circa 2000 sqft
- Detached double garage & ample off street parking
- Council Tax Band F
- Private road
- Future scope for further extension and development STPP
- Private rear garden
- Close to outstanding primary and secondary schooling

Porch

Entrance Hall

Living Room

23'4" x 16'11" (7.13 x 5.16)

Dining Room

14'0" x 11'11" (4.27 x 3.65)

Kitchen/Breakfast Room

20'3" x 9'5" (6.19 x 2.89)

Family Room

15'2" x 13'6" (4.63 x 4.12)

Utility Room

8'10" x 8'1" (2.71 x 2.48)

Cloakroom

Study

11'10" x 10'8" (3.62 x 3.27)

Bedroom One

13'0" x 10'8" (3.98 x 3.26)

Bedroom Two

13'8" x 12'0" (4.19 x 3.66)

Bedroom Three

9'6" x 9'6" (2.9 x 2.9)

Family Bathroom

Bedroom Four

11'5" x 8'7" (3.48 x 2.64)

Shower Room

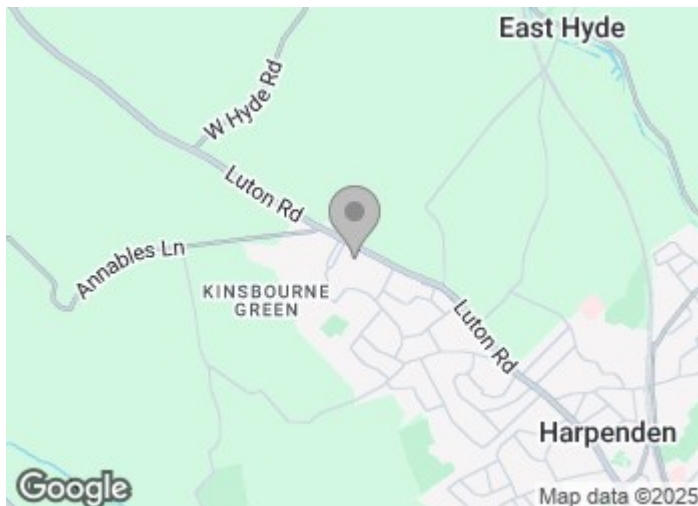



Floor Plan

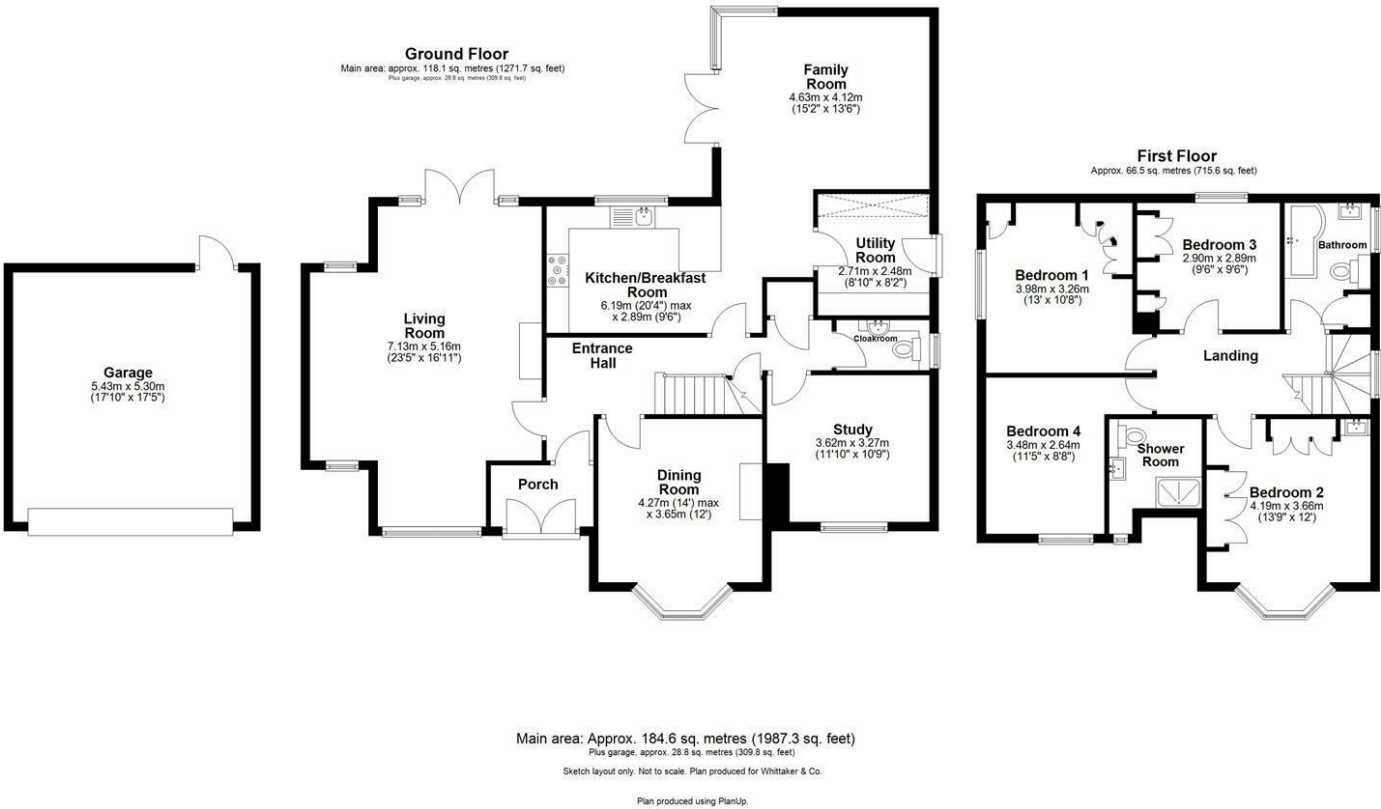

These particulars, whilst believed to be accurate are set out as a general outline only for guidance and do not constitute any part of an offer or contract. Intending purchasers should not rely on them as statements of representation of fact, but must satisfy themselves by inspection or otherwise as to their accuracy. No person in this firms employment has the authority to make or give any representation or warranty in respect of the property.

