



247 Lower Luton Road Wheathampstead, AL4 8HW

Built in the 1930's, this semi-detached house sits within a generously proportioned plot and offers scope for extension and modernisation. The property is ideal for somebody who is looking for a blank canvas to improve and add value to.

Guide price £550,000

247 Lower Luton Road

Wheathampstead, AL4 8HW



- Semi-detached 1930's house with great possibilities
- Gas fired central heating
- CHAIN FREE

- Ground floor with two reception rooms, a conservatory and kitchen
- Off street parking for multiple vehicles
- Nearby Wheathampstead High Street features a good selection of shops, bars and restaurants and within reach of a selection of the excellent schools

- First floor offering three bedrooms and a bathroom
- Well proportioned south facing rear garden
- Wheathampstead (1.2 miles) Harpenden Station (2.3 miles)

GROUND FLOOR

Entrance Hall

Cloakroom

Living Room

11'8 x 11'3 (3.56m x 3.43m)

Dining Room

11'9 x 11'3 (3.58m x 3.43m)

Kitchen

13'5 x 5'11 (4.09m x 1.80m)

Conservatory

11'4 max x 7'10 (3.45m max x 2.39m)

FIRST FLOOR

Landing

Bedroom One

11'9 x 9'9 (3.58m x 2.97m)

Bedroom Two

11'8 x 11'1 (3.56m x 3.38m)

Bedroom Three

8'7 x 7'8 (2.62m x 2.34m)

Bathroom

EXTERNALLY

Off Street Parking for Multiple Vehicles

Rear Garden

115' approximately (35.05m approximately)



Directions



Floor Plan

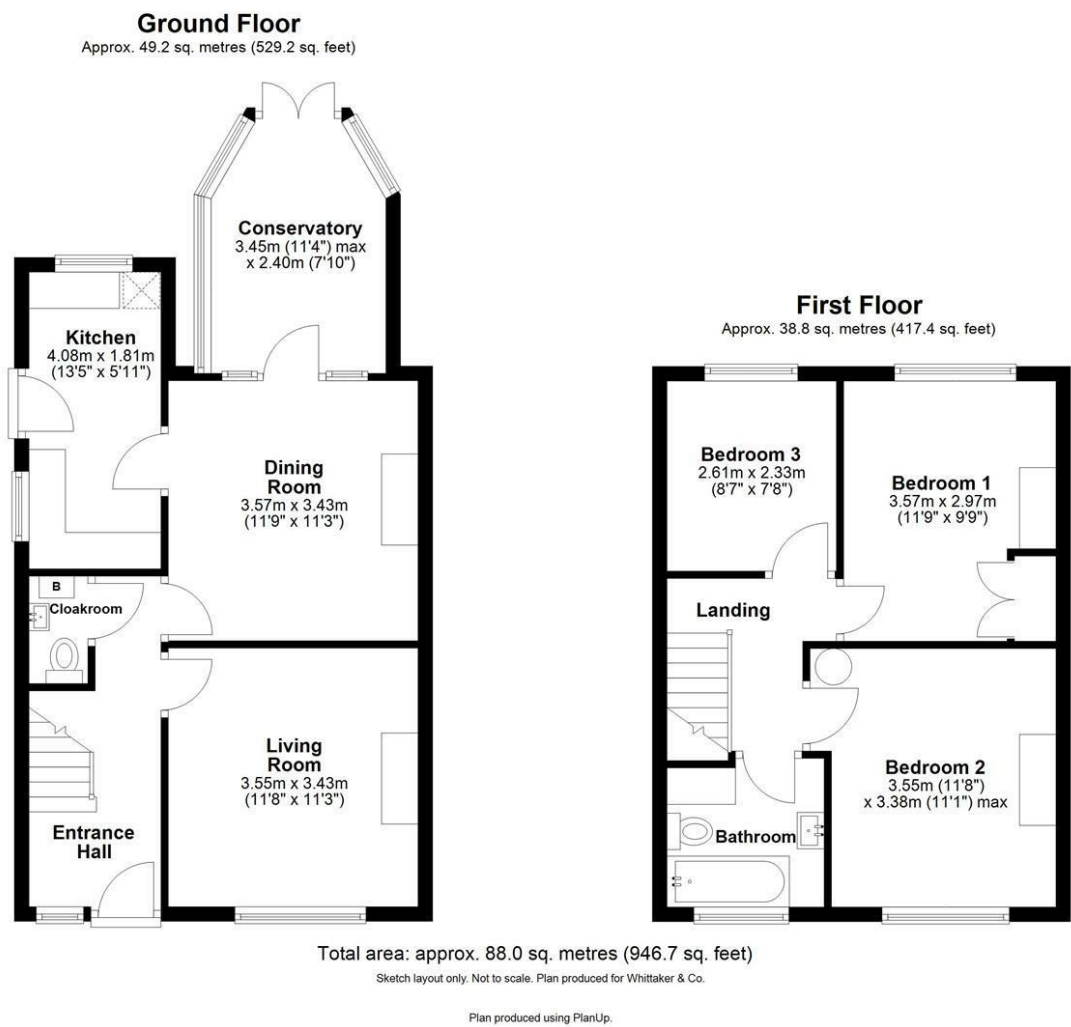

These particulars, whilst believed to be accurate are set out as a general outline only for guidance and do not constitute any part of an offer or contract. Intending purchasers should not rely on them as statements of representation of fact, but must satisfy themselves by inspection or otherwise as to their accuracy. No person in this firms employment has the authority to make or give any representation or warranty in respect of the property.

