



Dalkeith Road

Harpenden, AL5 5PP

Well-presented, semi-detached family home with light and spacious living accommodation totalling over 2,500 square feet with the additional benefit of a garage, together with off-street parking for up to four cars. Fabulous South West facing garden of over 100ft. Dalkeith Road is a much sought after location, ideally placed for schooling and close to both the town centre and station.

Guide price £1,600,000

Dalkeith Road

Harpenden, AL5 5PP



- Fabulous family home on large plot
- South West Facing garden of over 100ft
- Ample off-street parking
- Open Plan Kitchen/Dining/Family Room
- Summer House
- Central, sought after location
- Over 2,600 square foot
- Integral Garage
- Ideally placed for schooling

Porch

Entrance Hall

Living Room

24'2" x 16'9" (7.38m x 5.12m)

Kitchen/Dining/Family Room

19'10" x 18'4" (6.06m x 5.60m)

Study

15'4" x 5'8" (4.68m x 1.73m)

Utility Room

15'4" x 5'8" (4.68m x 1.73m)

Snug

12'11" x 11'11" (3.94m x 3.64m)

Cloakroom

Bedroom One

14'3" x 11'9" (4.35m x 3.60m)

Dressing Area

En-Suite Shower

Bedroom Two

11'0" x 8'2" (3.36m x 2.49m)

En-Suite Shower

Bedroom Three

15'8" x 10'9" (4.80m x 3.29m)

Bedroom Four

12'6" x 10'5" (3.82m x 3.20m)

Bedroom Five

11'10" x 7'3" (3.62m x 2.22m)

Bathroom

Integral Garage

18'9" x 9'7" (5.72m x 2.94m)

Summer House

13'0" x 7'3" (3.98m x 2.23m)

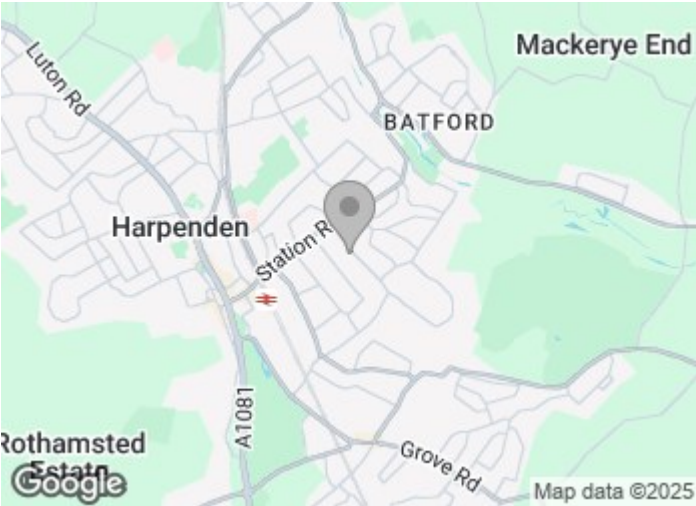



Floor Plan

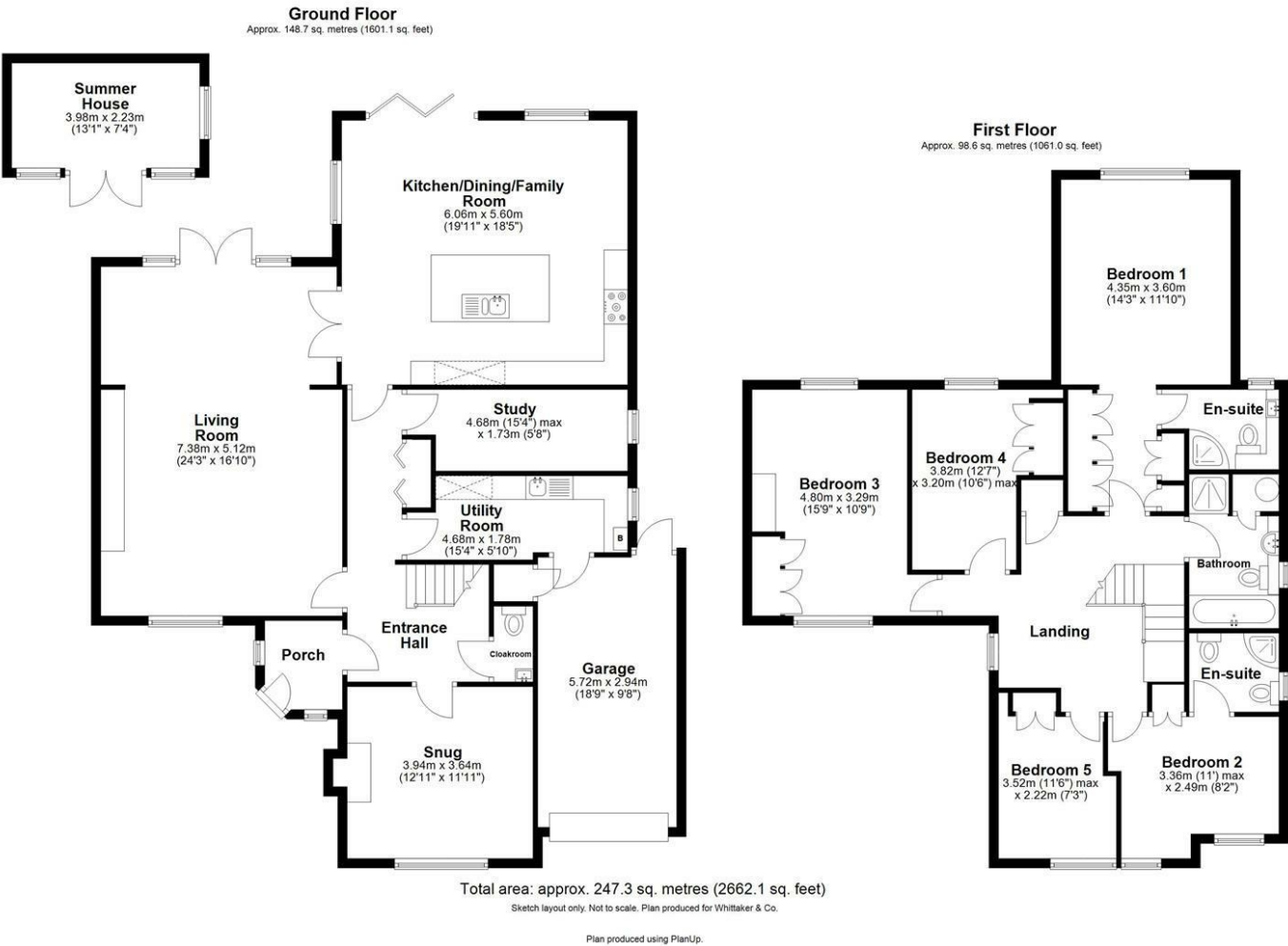

These particulars, whilst believed to be accurate are set out as a general outline only for guidance and do not constitute any part of an offer or contract. Intending purchasers should not rely on them as statements of representation of fact, but must satisfy themselves by inspection or otherwise as to their accuracy. No person in this firms employment has the authority to make or give any representation or warranty in respect of the property.

