



## Bloomfield Road

Harpenden, AL5 4DB

Fabulous six bedroom family home of over 2800 sq ft arranged over three floors. It offers a huge amount of living and entertaining space, together with an 80 ft south facing garden. Ideally located for schooling and the town centre

**Guide price £1,750,000**

# Bloomfield Road

Harpenden, AL5 4DB



- Superb condition throughout
- Over 2800 sq ft arranged over 3 floors
- Open plan Kitchen / Dining / Living Room
- 80ft southerly aspect garden
- Ideally located for schooling
- Garage & Driveway

## Entrance Hall

## Living Room

13'10" x 12'11" (4.22m x 3.96m)

## Bathroom

## Study

12'10" x 8'11" (3.91m x 2.72m)

## Kitchen/Dining/Family Room

30'11" x 25'1" (9.43m x 7.65m)

## Gym

13'11" x 7'2" (4.26m x 2.20m)

## Utility Room

12'7" x 7'2" (3.86m x 2.20m)

## Bedroom 1

22'11" x 16'3" (7m x 4.96m)

## Em-suite Shower

## Bedroom Two

12'11" x 12'6" (3.96m x 3.82m)

## Bedroom Three

18'10" x 8'10" (5.76m x 2.70m)

## Bedroom Four

11'9" x 11'3" (3.60m x 3.44m)

## Bathroom

## Bedroom Five

15'8" x 14'1" (4.78m x 4.30m)

## Shower Room

## Bedroom Six

15'8" x 10'7" (4.78m x 3.23m)

## Integral Garage

17'3" x 8'0" (5.28m x 2.46m)

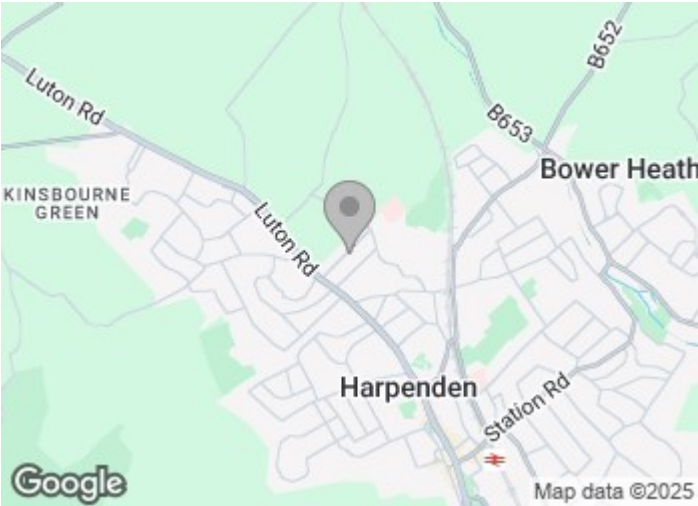



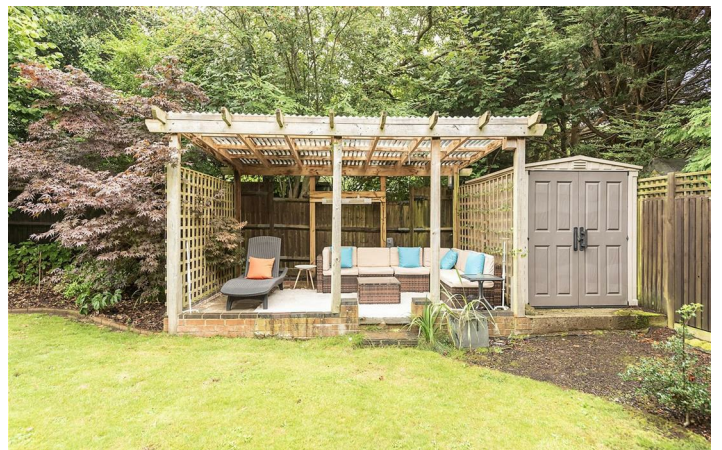



Floor Plan

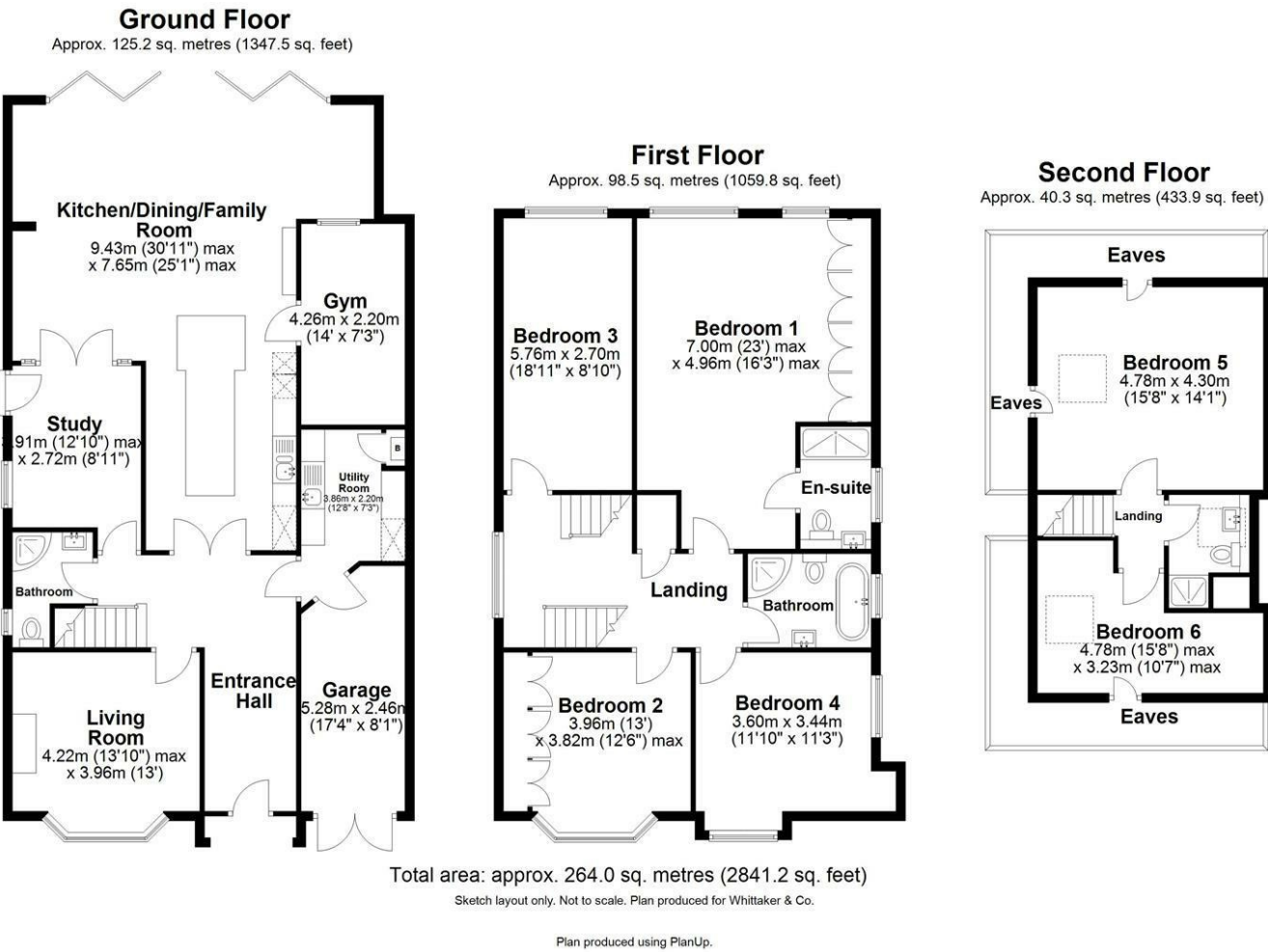

These particulars, whilst believed to be accurate are set out as a general outline only for guidance and do not constitute any part of an offer or contract. Intending purchasers should not rely on them as statements of representation of fact, but must satisfy themselves by inspection or otherwise as to their accuracy. No person in this firms employment has the authority to make or give any representation or warranty in respect of the property.

