



## Rosebery Avenue

Harpenden, AL5 2QT

Stunning six bedroom period home of circa 4200 sq ft, spectacular quality throughout, arranged over three floors plus a wine cellar. Situated in the heart of the much sought after Avenues area, minutes from the town centre with a private garden and off-street parking.

**Guide price £3,500,000**

# Rosebery Avenue

Harpenden, AL5 2QT



- Magnificent Edwardian Home circa 4200 sq ft
- Substantial sized rooms
- Minutes from the town centre.
- Spectacular quality throughout
- 82 ft South Westerly private garden
- Arranged over three floors plus wine cellar
- Off street parking

## Entrance hall

## Family Room

19'11" x 13'11" (6.09m x 4.26m)

## Boot Room

25'3" x 7'11" (7.72m x 2.43m)

## Kitchen/Dining Room

35'10" x 15'1" (10.94 x 4.60m)

## Utility Room

## Cloakroom

## Living Room

19'10" x 14'0" (6.05m x 4.27m)

## Bedroom One

15'1" x 13'7" (4.60m x 4.15m)

## Dressing Room

13'5" x 10'11" (4.10m x 3.35m)

## En-Suite Bath and Shower

## Bedroom Two

19'11" x 13'11" (6.09m x 4.26m)

## En-Suite Shower

## Bedroom Three

19'10" x 14'0" (6.05m x 4.27m)

## Laundry Room

14'0" x 6'10" (4.27m x 2.10m)

## Bedroom Four

16'11" x 13'8" (5.18m x 4.19m)

## En-suite Bath and Shower

## Bedroom Five

18'8" x 13'0" (5.71m x 3.98m)

## Bedroom Six

15'11" x 12'0" (4.86m x 3.68m)

## Storage

5'7" x 4'11" (1.71m x 1.51m)

## Bath and Shower Room

## Wine Cellar

17'2" x 6'10" (5.25m x 2.09m)







Floor Plan

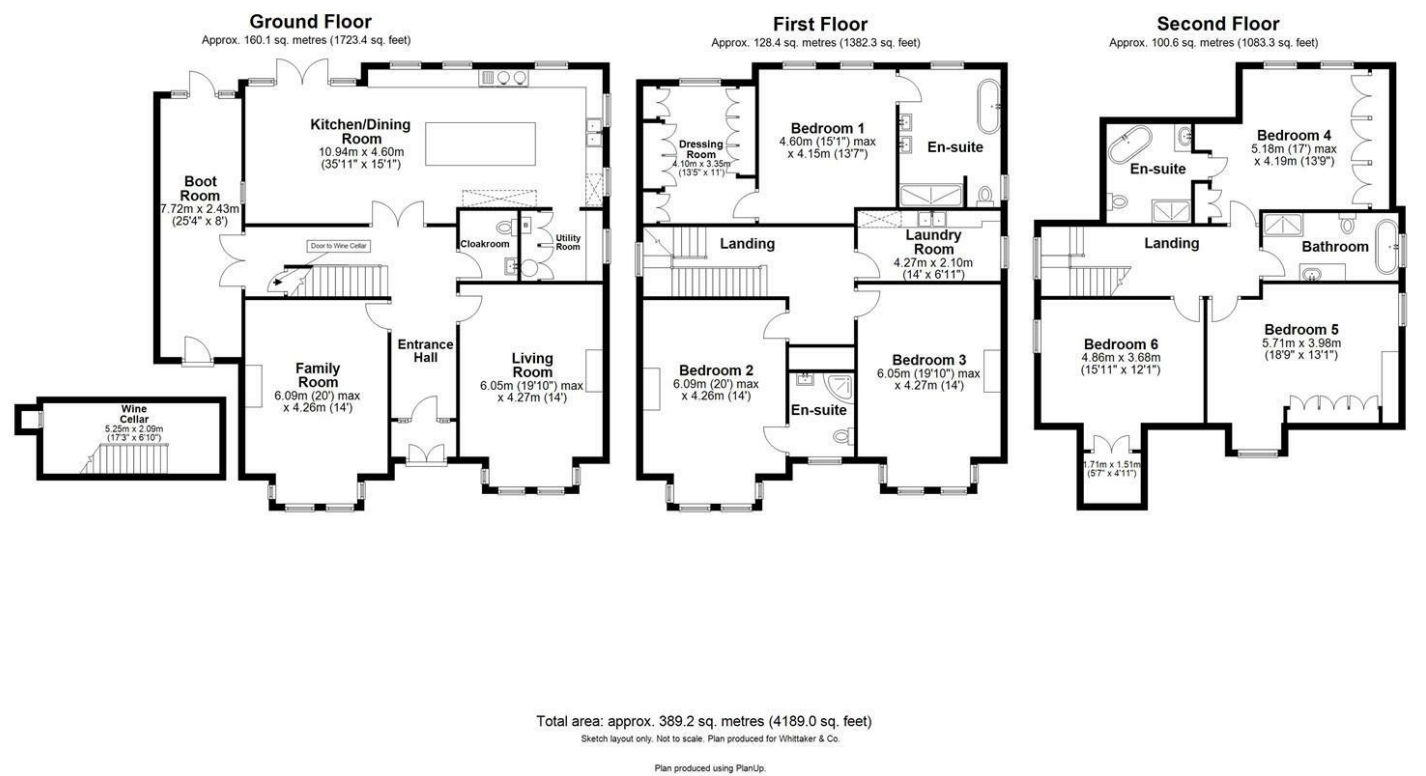

These particulars, whilst believed to be accurate are set out as a general outline only for guidance and do not constitute any part of an offer or contract. Intending purchasers should not rely on them as statements of representation of fact, but must satisfy themselves by inspection or otherwise as to their accuracy. No person in this firms employment has the authority to make or give any representation or warranty in respect of the property.

