



## Cooters End Lane

Harpenden, AL5 3NR

A rare opportunity to acquire a rural property with gated access and plenty of character within easy access of Harpenden schools and the station. In good order throughout there is also a separate building with a gym and a den. Surrounded by countryside with stunning views, it has a private garden, ample parking plus a beautiful second garden of a third of an acre with the gym. .

**Guide price £1,950,000**



# Cooters End Lane

Harpenden, AL5 3NR



- Rural property surrounded by countryside
- Gated access
- Private garden next to the house
- Over 2500 sq ft plus Gym, Den and Garage
- Stunning views,
- Second garden of a third of an acre
- In good order throughout
- Ample parking
- Easy access of Harpenden schools and the station

## Reception Hall

22'2" x 10'4" (6.76m x 3.15m)

## Living Room

20'2" c 17'8" (6.15m c 5.40m)

## Dining / Family Room

17'8" x 15'6" (5.40m x 4.74m)

## Kitchen

14'10" x 11'7" (4.53m x 3.54m)

## Utility Room

10'7" x 5'2" (3.25m x 1.60m)

## Cloakroom

## Bedroom One

18'10" x 18'0" (5.76m x 5.50m)

## En-Suite Shower

## Bedroom Two

14'1" x 12'1" (4.31m x 3.69m)

## En-Suite Shower

## Bedroom Three

12'8" x 11'1" (3.88m x 3.40m)

## Bedroom Four

17'10" x 8'5" (5.45m x 2.58m)

## Bedroom Five

12'6" x 8'9" (3.83m x 2.67m)

## Separate Gym

47'5" x 18'10" (14.47m x 5.76m)

## Workshop

19'0" x 18'10" (5.80m x 5.76m)

## Garage

16'10" x 16'1" (5.14m x 4.92m)

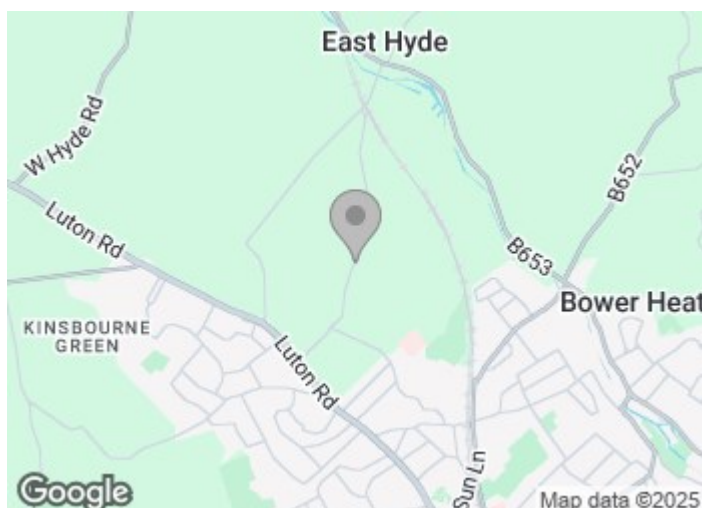







Floor Plan

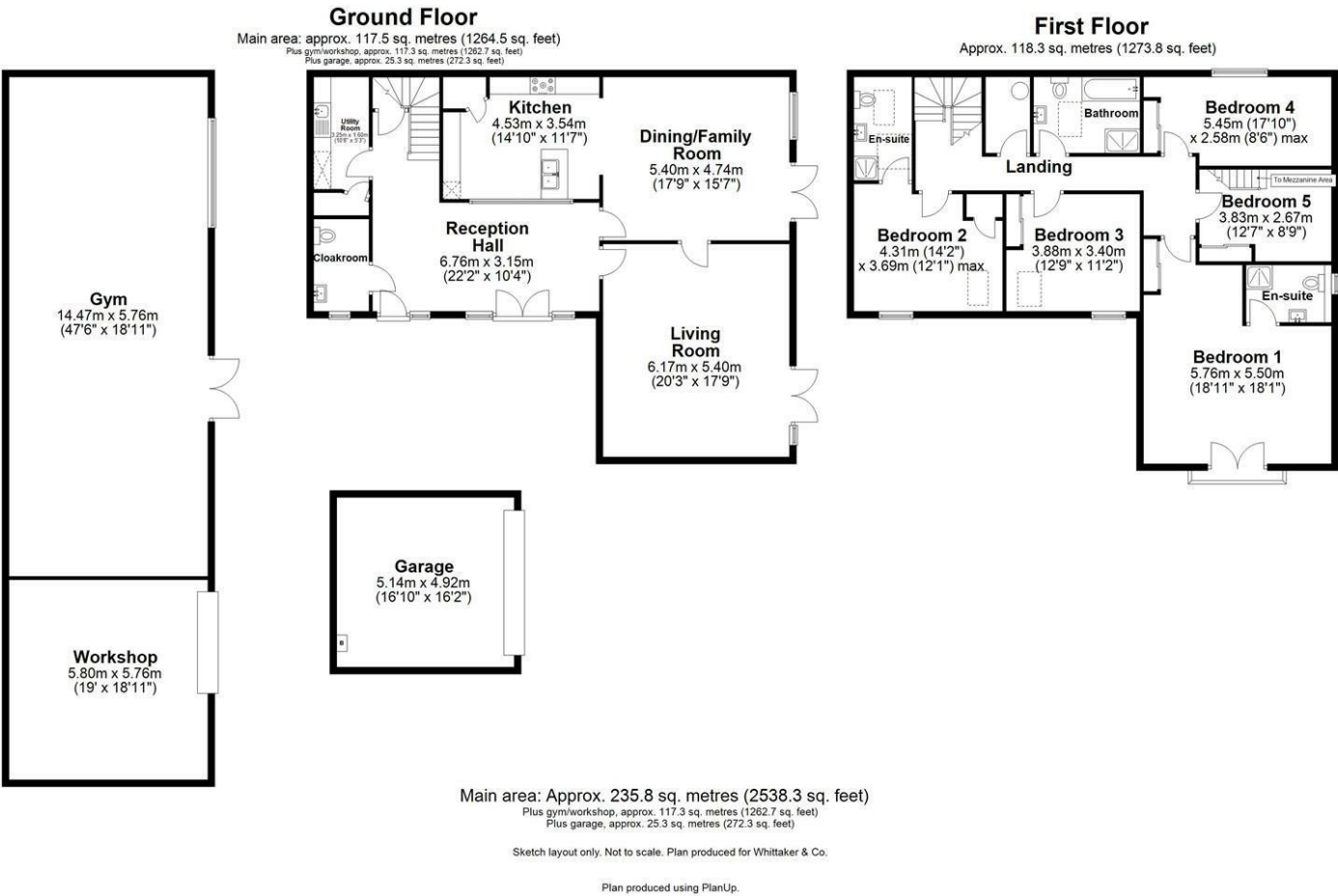

These particulars, whilst believed to be accurate are set out as a general outline only for guidance and do not constitute any part of an offer or contract. Intending purchasers should not rely on them as statements of representation of fact, but must satisfy themselves by inspection or otherwise as to their accuracy. No person in this firms employment has the authority to make or give any representation or warranty in respect of the property.

