



Southview Road Harpenden, AL5 5AZ

A spacious family home with versatile living space - circa 1,500 sq ft - arranged over three floors. The private garden has a southerly aspect and there is the additional benefit of off-street parking. Well placed for schooling, close to Batford Springs Nature Reserve and within easy reach of Harpenden town centre and station.

Offers in excess of £750,000

Southview Road

Harpenden, AL5 5AZ



- Circa 1,500 sq ft
- Garden southerly aspect
- Close to Batford Springs Nature Reserve
- Versatile space
- Off-street parking
- Within easy reach of Harpenden town centre
- Arranged over three floors
- Well placed for schooling

Entrance Hall

Lounge / Dining Room

18'10" x 10'11" (5.76 x 3.35)

Conservatory

15'10" x 8'9" (4.83 x 2.69)

Kitchen

12'8" x 6'7" (max) (3.87 x 2.03 (max))

Utility / Store Room

8'7" x 8'2" (2.64 x 2.51)

Family Room / Bedroom Four

18'10" (max) x 12'10" (max) (5.75 (max) x 3.92 (max))

Bedroom Two

10'11" (max) x 9'6" (3.35 (max) x 2.90)

Bedroom Three

10'4" x 9'0" (3.16 x 2.76)

Bedroom One

12'5" (max) x 10'11" (3.79 (max) x 3.35)

Wardrobe / Dressing Area

En-suite Shower Room

Eaves Storage

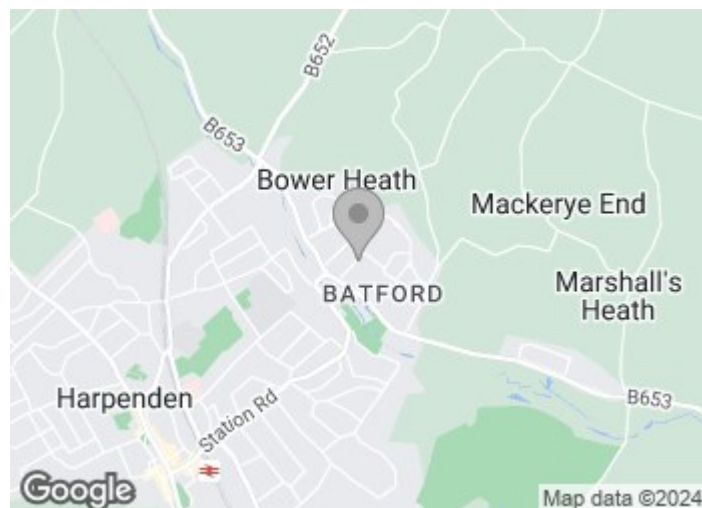



Floor Plan

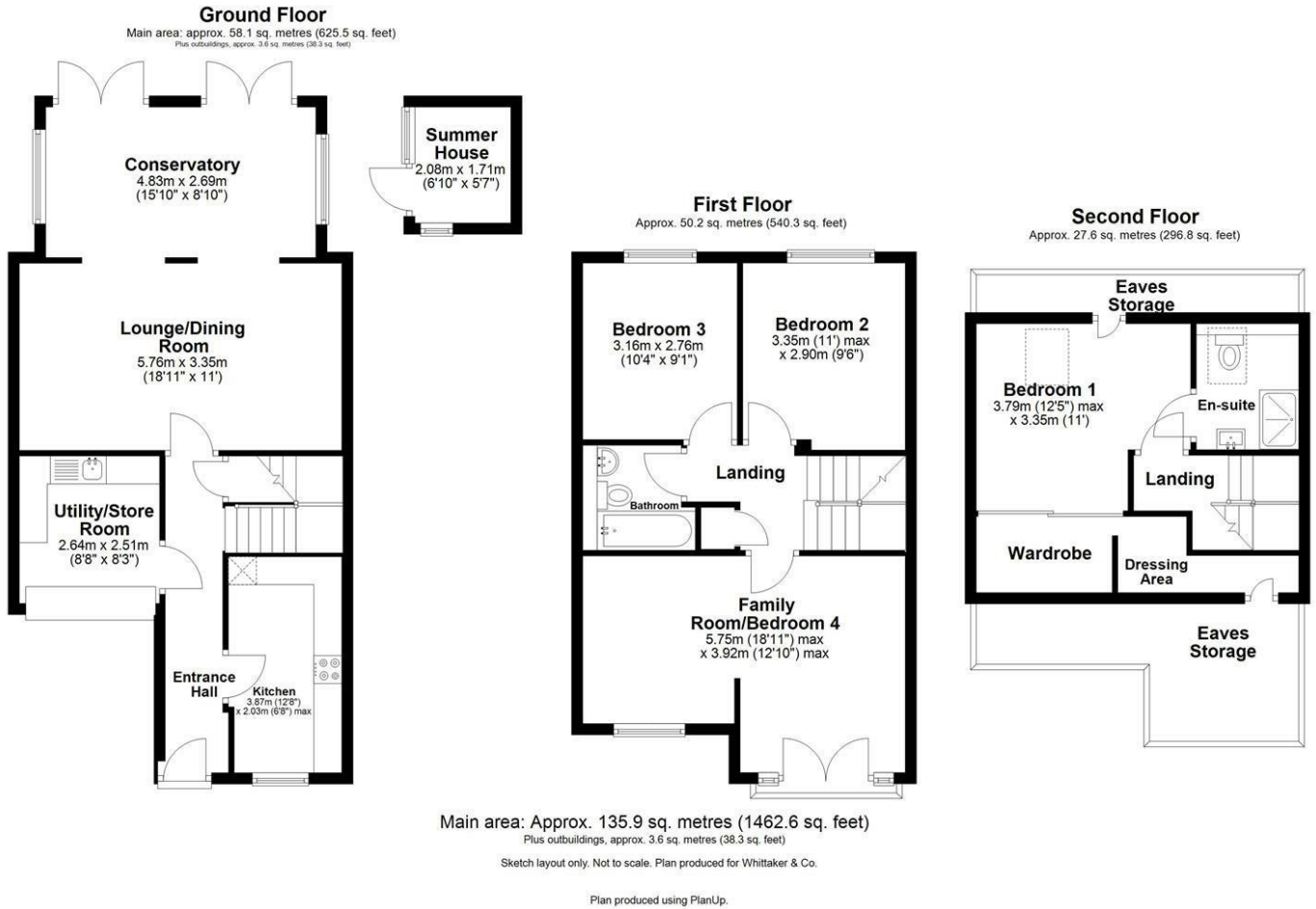

These particulars, whilst believed to be accurate are set out as a general outline only for guidance and do not constitute any part of an offer or contract. Intending purchasers should not rely on them as statements of representation of fact, but must satisfy themselves by inspection or otherwise as to their accuracy. No person in this firm's employment has the authority to make or give any representation or warranty in respect of the property.

