



Field Close

Harpenden, AL5 1EP

Immaculately presented bungalow of just under 1,000 sq ft with well proportioned rooms and an open plan Kitchen / Dining Room, backing on to the private garden. Close to both the amenities of Southdown and open countryside and within easy reach of Harpenden town centre. *CHAIN FREE*

Guide price £725,000

Field Close

Harpenden, AL5 1EP



- Immaculately presented
- Private garden
- Close to open countryside
- Circa 1,000 sq ft
- Off-street parking for two cars
- Within easy reach of Harpenden town centre
- Open plan Kitchen / Dining Room
- Moments from amenities of Southdown
- Chain Free

Entrance Hall

Living Room

18'0" (max) x 13'3" (5.49 (max) x 4.04)

Kitchen / Dining Room

16'9" x 14'2" (5.11 x 4.32)

Bedroom One

12'11" x 10'0" (3.96 x 3.05)

En-suite Shower Room

Bedroom Two

9'10" x 9'10" (3.00 x 3.00)

Bedroom Three

9'6" x 7'3" (2.90 x 2.23)

Bathroom

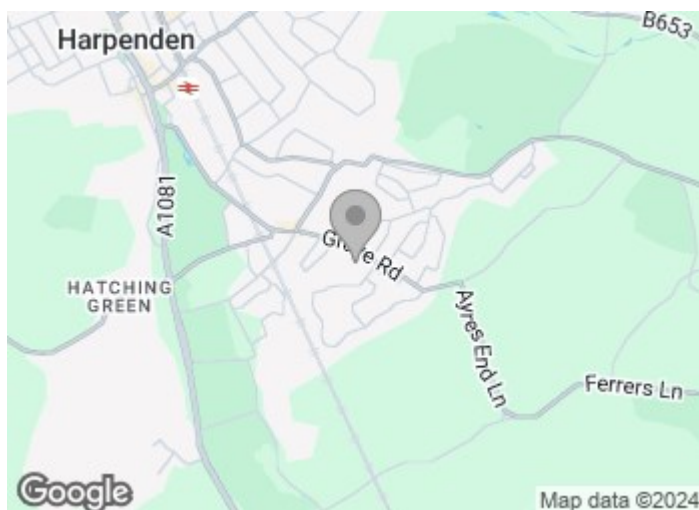



Floor Plan

Ground Floor

Approx. 87.3 sq. metres (939.3 sq. feet)

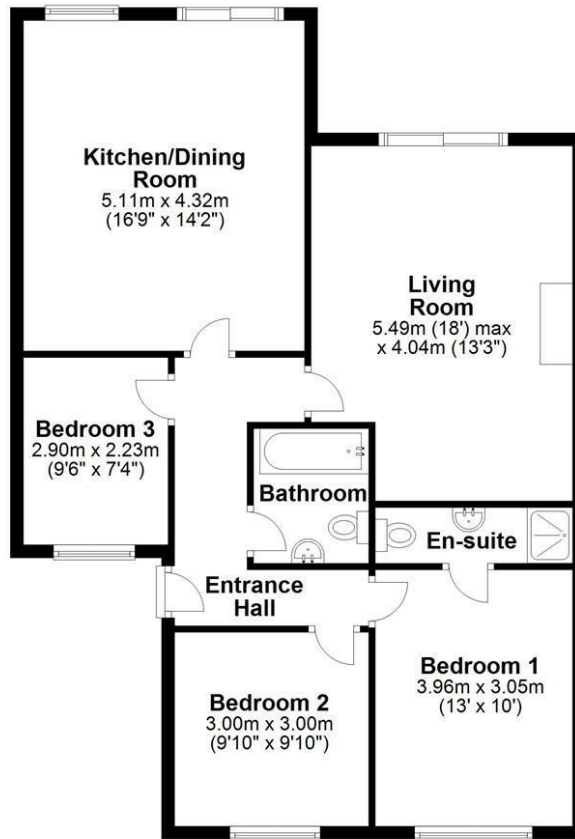

Total area: approx. 87.3 sq. metres (939.3 sq. feet)

Sketch layout only. Not to scale. Plan produced for Whittaker & Co.

Plan produced using PlanUp.

These particulars, whilst believed to be accurate are set out as a general outline only for guidance and do not constitute any part of an offer or contract. Intending purchasers should not rely on them as statements of representation of fact, but must satisfy themselves by inspection or otherwise as to their accuracy. No person in this firm's employment has the authority to make or give any representation or warranty in respect of the property.

