



Meadway

Harpenden, AL5 1JN

Fully refurbished by our clients, this is an immaculately presented home of circa 815 sq ft. The open plan Kitchen / Dining Room opens onto the 50ft garden (westerly aspect). Meadway is a popular spot, given its proximity to both the amenities of Southdown and beautiful open countryside. Harpenden town centre and station are within easy reach.

Guide price £600,000

Meadway

Harpenden, AL5 1JN



- Refurbished by our clients
- Garden 50ft westerly aspect
- Within easy reach of Harpenden
- Circa 815 sq ft
- Off-street parking
- Close to beautiful open countryside
- Open plan Kitchen / Dining Room
- Close to amenities of Southdown

Living Room

16'4" (max) x 15'3" (5.00 (max) x 4.66)

Kitchen / Dining Room

15'3" x 11'2" (4.67 x 3.41)

Cloakroom

Bedroom One

15'3" x 11'8" (4.67 x 3.57)

Bedroom Two

11'3" x 8'5" (3.43 x 2.59)

Bathroom

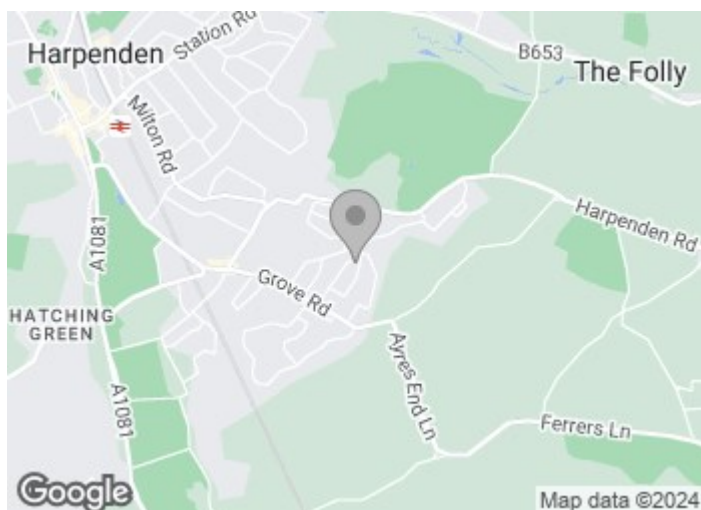



Ground Floor

Approx. 38.1 sq. metres (410.4 sq. feet)

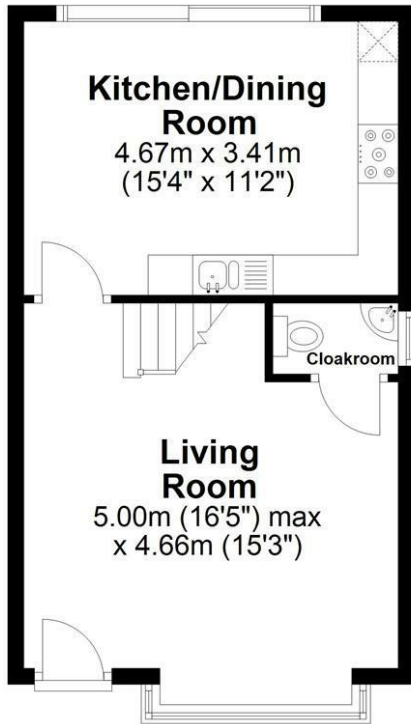

First Floor

Approx. 37.6 sq. metres (404.6 sq. feet)

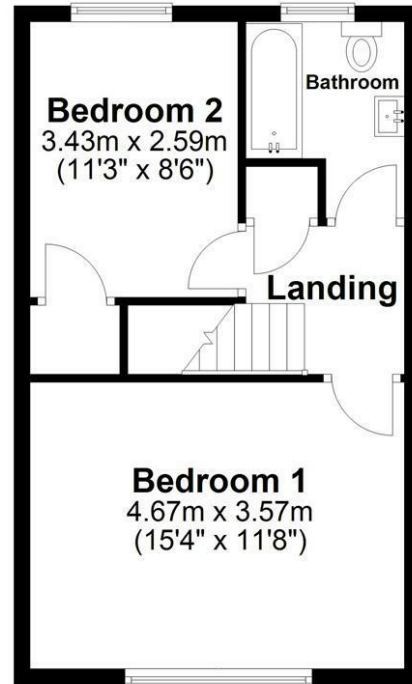

Total area: approx. 75.7 sq. metres (815.0 sq. feet)

Sketch layout only. Not to scale. Plan produced for Whittaker & Co.

Plan produced using PlanUp.

These particulars, whilst believed to be accurate are set out as a general outline only for guidance and do not constitute any part of an offer or contract. Intending purchasers should not rely on them as statements of representation of fact, but must satisfy themselves by inspection or otherwise as to their accuracy. No person in this firm's employment has the authority to make or give any representation or warranty in respect of the property.

