



Alzey Gardens

Harpenden, AL5 5SY

Fabulous four bedroom family home - extended and refurbished by our clients to an exacting standard - with plenty of living space and potential to convert the store room to an additional reception room (STPP). Backing onto an open green, Alzey Gardens is a peaceful, popular spot and well placed for schooling

Guide price £1,200,000

Alzey Gardens

Harpenden, AL5 5SY



- Circa 1,450 sq ft
- Four Bedrooms
- Peaceful location
- Extended & refurbished by our clients
- Two Bathrooms
- Well placed for schooling
- Open plan Kitchen / Dining / Family Room
- Potential to convert Store Room (STPP)

Entrance Hall

Living Room

11'6" x 11'4" (3.53 x 3.46)

Kitchen / Dining / Family Room

27'3" (max) x 14'6" (max) (8.33 (max) x 4.42 (max))

Study

7'3" x 7'2" (2.21 x 2.20)

Utility Room

7'1" x 4'7" (2.17 x 1.41)

Study

7'3" x 7'2" (2.21 x 2.20)

Cloakroom

Bedroom One

12'1" x 9'4" (3.70 x 2.85)

En-suite Shower Room

Bedroom Two

12'0" x 9'8" (3.68 x 2.95)

Bedroom Three

12'0" (max) x 9'5" (3.68 (max) x 2.89)

Bedroom Four

13'2" x 6'11" (4.03 x 2.11)

Family Bathroom

Store Room

16'11" x 8'11" (5.18 x 2.74)

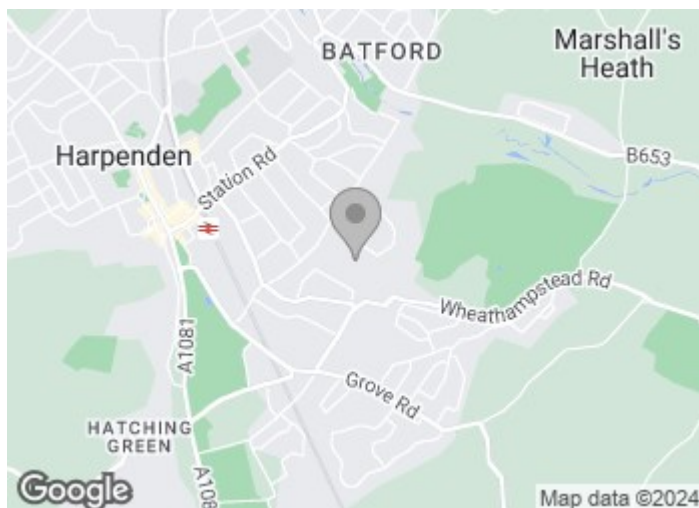



Floor Plan

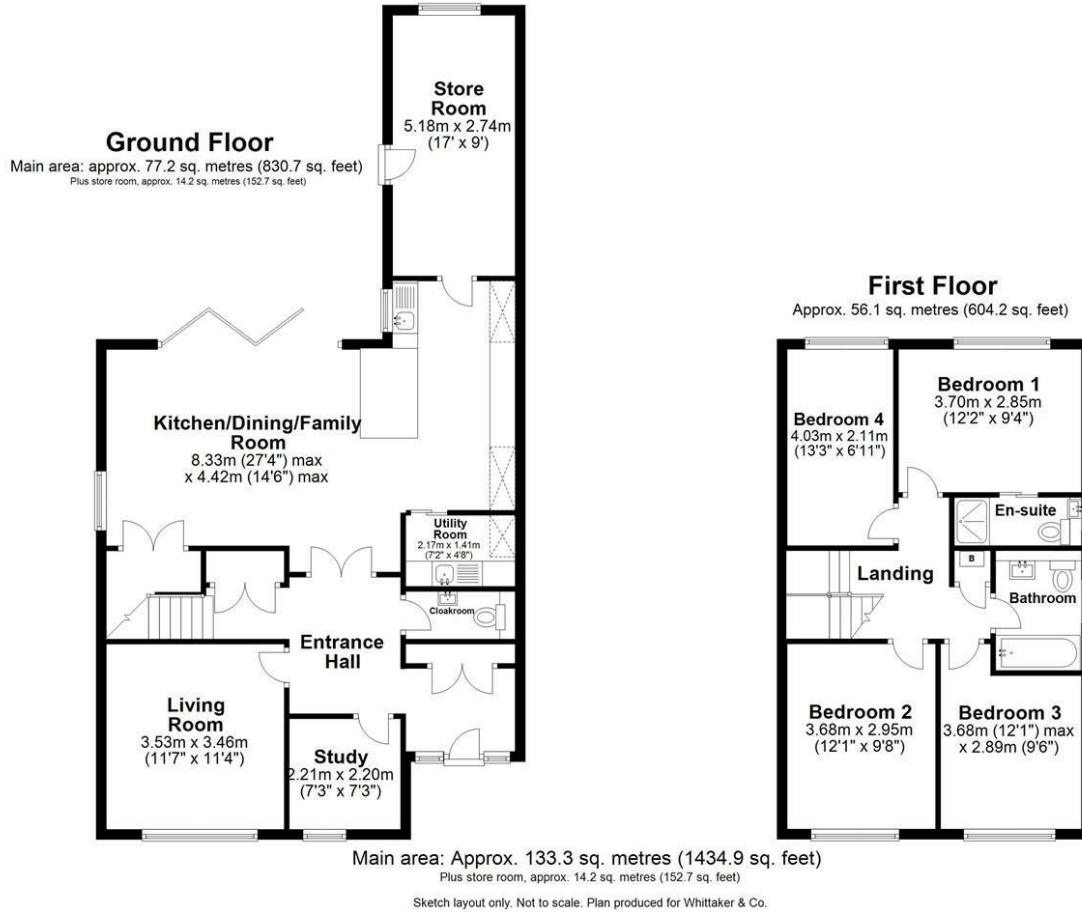

Plan produced using PlanUp.

These particulars, whilst believed to be accurate are set out as a general outline only for guidance and do not constitute any part of an offer or contract. Intending purchasers should not rely on them as statements of representation of fact, but must satisfy themselves by inspection or otherwise as to their accuracy. No person in this firm's employment has the authority to make or give any representation or warranty in respect of the property.

