



Barrons Row

Harpenden, AL5 1SD

An extremely well presented family home - circa 1,115 sq ft - with the Living Room backing onto the south facing garden. Open plan Kitchen / Dining Room and well proportioned Bedrooms. Close to the amenities of Southdown, well placed for schooling and within easy reach of Harpenden town centre and station.

Guide price £675,000

Barrons Row

Harpenden, AL5 1SD



- Well presented throughout
- Living room opening onto Garden
- Close to amenities of Southdown
- Circa 1,115 sq ft
- Garden south facing
- Well placed for schooling
- Open plan Kitchen / Dining Room
- Off-street parking
- Within easy reach of Harpenden

Living Room

18'9" x 14'8" (5.73 x 4.49)

Kitchen / Dining Room

18'9" x 9'10" (5.73 x 3.00)

Cloakroom

Bedroom One

16'9" x 10'0" (5.11 x 3.06)

Bedroom Two

11'7" x 9'6" (3.54 x 2.90)

Bedroom Three

10'8" x 8'11" (3.26 x 2.73)

Bathroom

Store

7'9" x 6'5" (2.37 x 1.96)

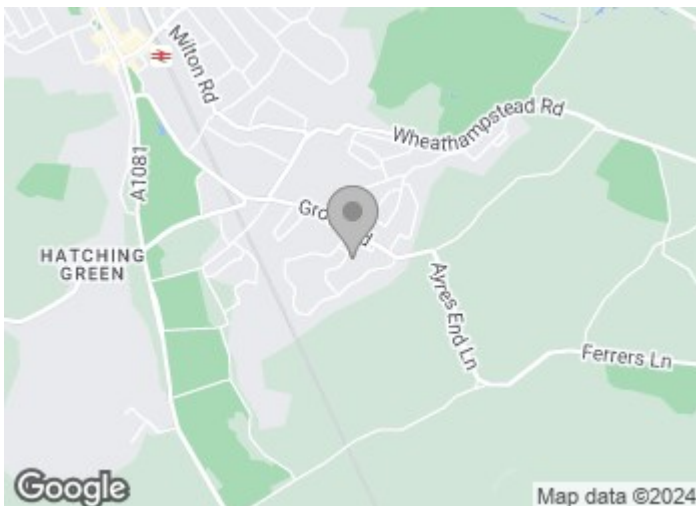



Floor Plan

Ground Floor

Approx. 54.7 sq. metres (589.1 sq. feet)

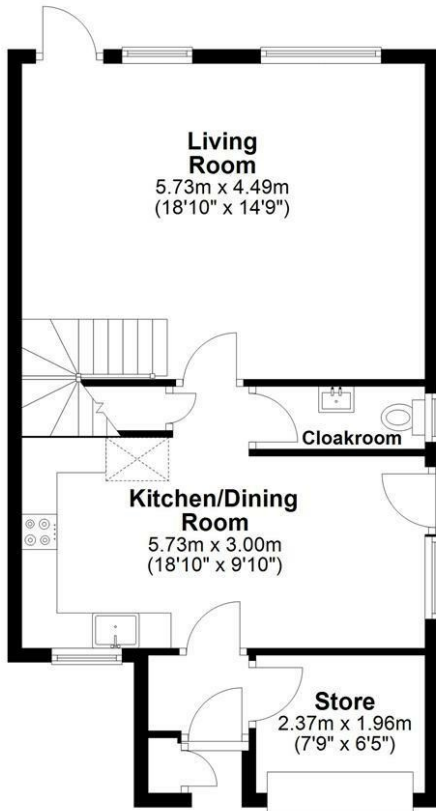

First Floor

Approx. 48.6 sq. metres (523.3 sq. feet)

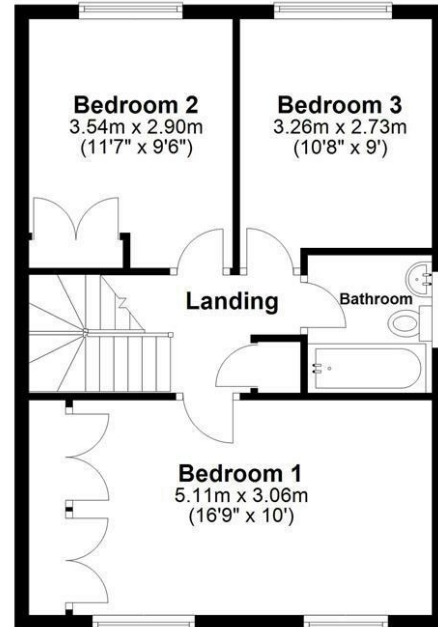

Total area: approx. 103.3 sq. metres (1112.3 sq. feet)

Sketch layout only. Not to scale. Plan produced for Whittaker & Co.

Plan produced using PlanUp.

These particulars, whilst believed to be accurate are set out as a general outline only for guidance and do not constitute any part of an offer or contract. Intending purchasers should not rely on them as statements of representation of fact, but must satisfy themselves by inspection or otherwise as to their accuracy. No person in this firm's employment has the authority to make or give any representation or warranty in respect of the property.

