



## Redbourn Lane

Harpenden, AL5 2AU

Welcome to Sunningdale; A stunningly presented, 6 bedroom detached family residence of circa 5000 sqft. Set secludedly behind a private gated entrance, this fine home boasts a triple garage/annexe, gymnasium and cinema room. The 0.28 acre curtilage faces South West and is arranged over four floors offering versatile accommodation, ideal for families.

**Guide price £4,250,000**

# Redbourn Lane

Harpenden, AL5 2AU



- Impeccably appointed family home
- Direct access to Harpenden Golf Club from Garden
- Potential SDLT Saving available - Annexe
- Bespoke Tom Howley Kitchen and fitted interiors
- Cinema room & Gym
- Privately gated property set within a 0.28 acre plot
- South West facing garden of circa 75ft
- Circa 5000 sqft with a Triple Garage/Annexe
- West Common Area

## Reception Hall

## Living Room

15'1" x 14'2" (4.62m x 4.33m)

## Study

14'2" x 9'4" (4.33m x 2.86m)

## Snug

12'4" x 11'10" (3.76m x 3.61m)

## Kitchen/Dining/Family Room

39'2" x 16'7" (11.96m x 5.08m)

## Utility Room

## Cloakroom

## Landing

35'4" x 10'2" (10.79m x 3.10m)

## Bedroom One

16'3" x 14'2" (4.96m x 4.33m)

## Dressing Room

## En-Suite Bathroom

## Bedroom Two

14'2" x 11'8" (4.33m x 3.57m)

## En-Suite Shower Room

## Bedroom Three

16'3" x 14'2" (4.96m x 4.34m)

## Jack and Jill En-Suite with Bedroom Four

## Bedroom Four

## Laundry Room

## Bedroom Five

12'11" x 9'11" (3.96m x 3.04m)

## Bedroom Six

12'4" x 9'11" (3.76m x 3.04m)

## Shower Room

## Games Room

20'2" x 15'9" (6.17m x 4.81m)

## Gallery

## Cinema Room

20'9" x 13'8" (6.34m x 4.19m)

## Gym

20'9" x 13'8" (6.34 x 4.18)

## Cloakroom

## Triple Garage

24'9" x 19'2" (7.55m x 5.85m)





# Floor Plan

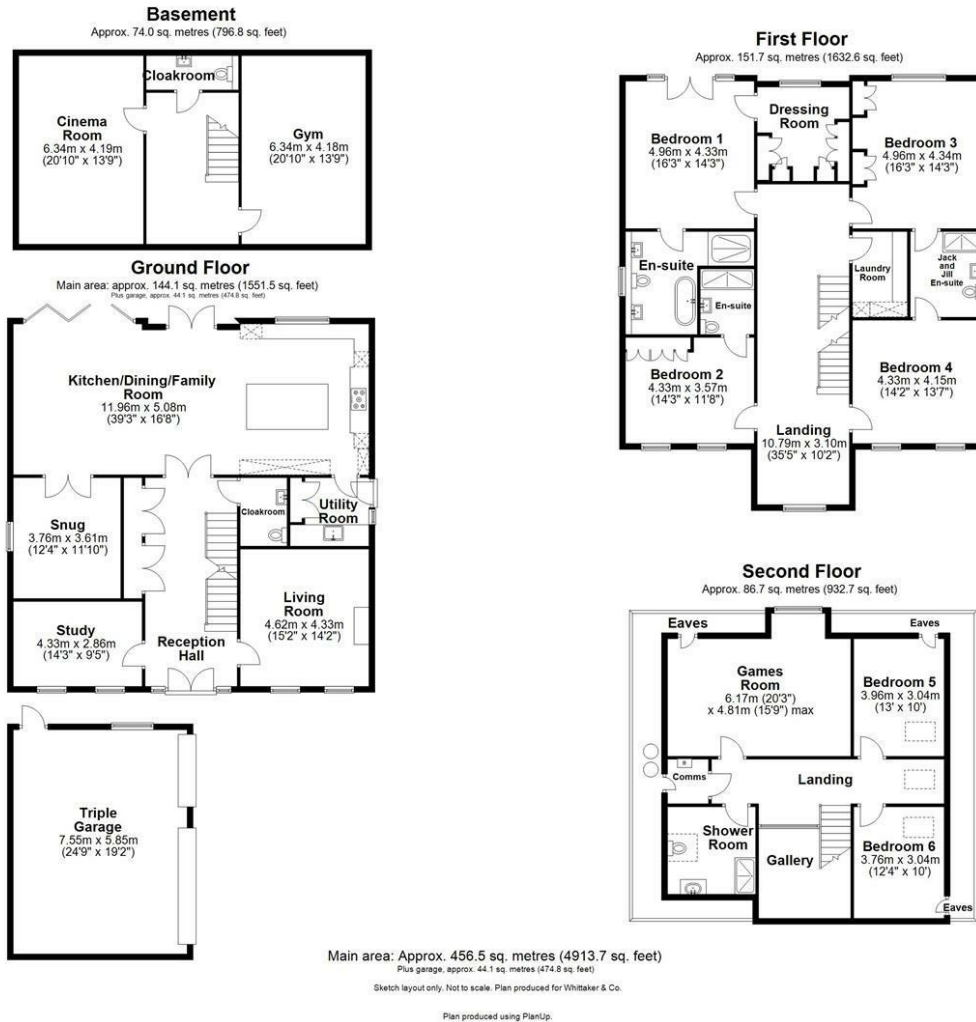

These particulars, whilst believed to be accurate are set out as a general outline only for guidance and do not constitute any part of an offer or contract. Intending purchasers should not rely on them as statements of representation of fact, but must satisfy themselves by inspection or otherwise as to their accuracy. No person in this firm's employment has the authority to make or give any representation or warranty in respect of the property.

